

DSNR: BER OPER: JCA SCALE: 1"=20.00  
 Q:\2002\02608\000\W TAIL 80-81 02-10-2003 10:13:58 am

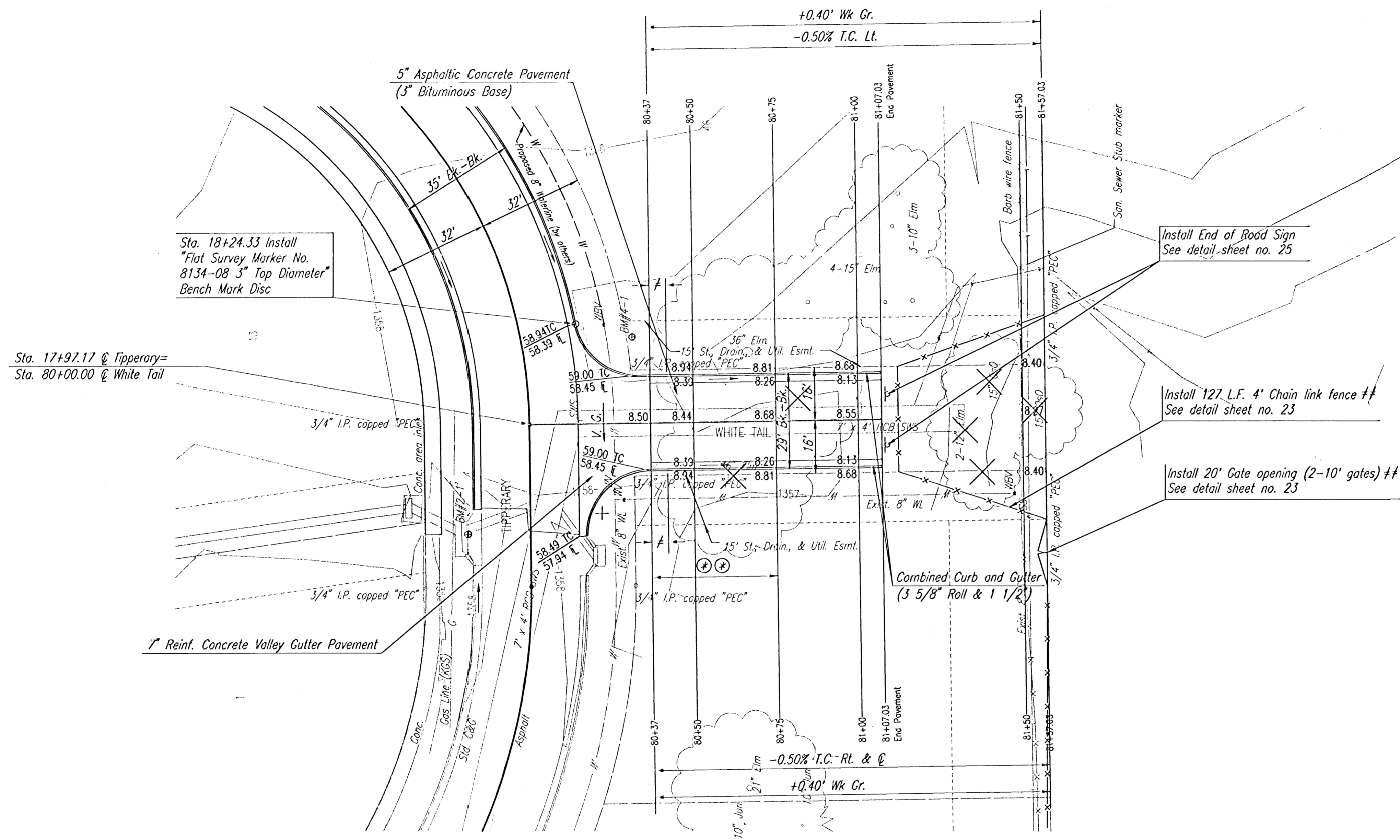

SCALE: 1"=20'

NOTE: THIS STREET TO BE CONSTRUCTED WITH ROLL-TYPE CURB. TOP OF CURB ELEVATIONS GIVEN ARE FOR FULL HEIGHT CURB.

- X = TREE REMOVAL
- # 5' TRANSITION FROM COMBINED CURB AND GUTTER 3 5/8" ROLL & 1 1/2" TO COMBINED CURB AND GUTTER (6 5/8" & 1 1/2"). TO BE BID AND AID FOR AS "COMBINED CURB AND GUTTER (3 5/8" ROLL & 1 1/2)".
- # Fence installation to be considered incidental to the contract bid item "Site Clearing"
- ⊕ TRANSITION FROM NO CROWN TO NORMAL CROWN (3/8" FT. X-SLOPE)

No.	Revision	By	Date
CITY OF WICHITA, KANSAS NEIL D. CABLE, P.E. - CITY ENGINEER BALTHROP 4TH ADDITION - PHASE 2 <b>WHITE TAIL</b> STA. 80+00 TO STA. 81+57.03 CITY OF WICHITA PROJECT NO. 472-83469			
<b>Professional Engineering Consultants, P.A.</b> 303 S. TOPEKA • WICHITA, KANSAS 67202 316-262-2691 • FAX 316-262-3003			
Designed by	BER	Job No.	35-02608-0
Drawn by	JCA	Date	January 2003
			Sht. 10 of 43

