

BENCHMARKS:
 "□" Cut in top of curb 10' west of end of existing pavement adjacent to Lot 37, Block C, Liberty Park 3rd Addition
 Elev. = 168.20 (City Datum)

"□" Cut in top of curb 10' east of end of existing pavement adjacent to Lot 52, Block C, Liberty Park 3rd Addition
 Elev. = 164.21 (City Datum)

C.O.W. Benchmark Disk. 56' E and 55' N of \odot 135th St. W. & 13th St. N.
 Elev. = 167.83 (City Datum)

C.O.W. Benchmark Disk. 1/2 mile south of 13th St. 39' east of \odot 135th St. 18' south of hedge row.
 Elev. = 159.71 (City Datum)

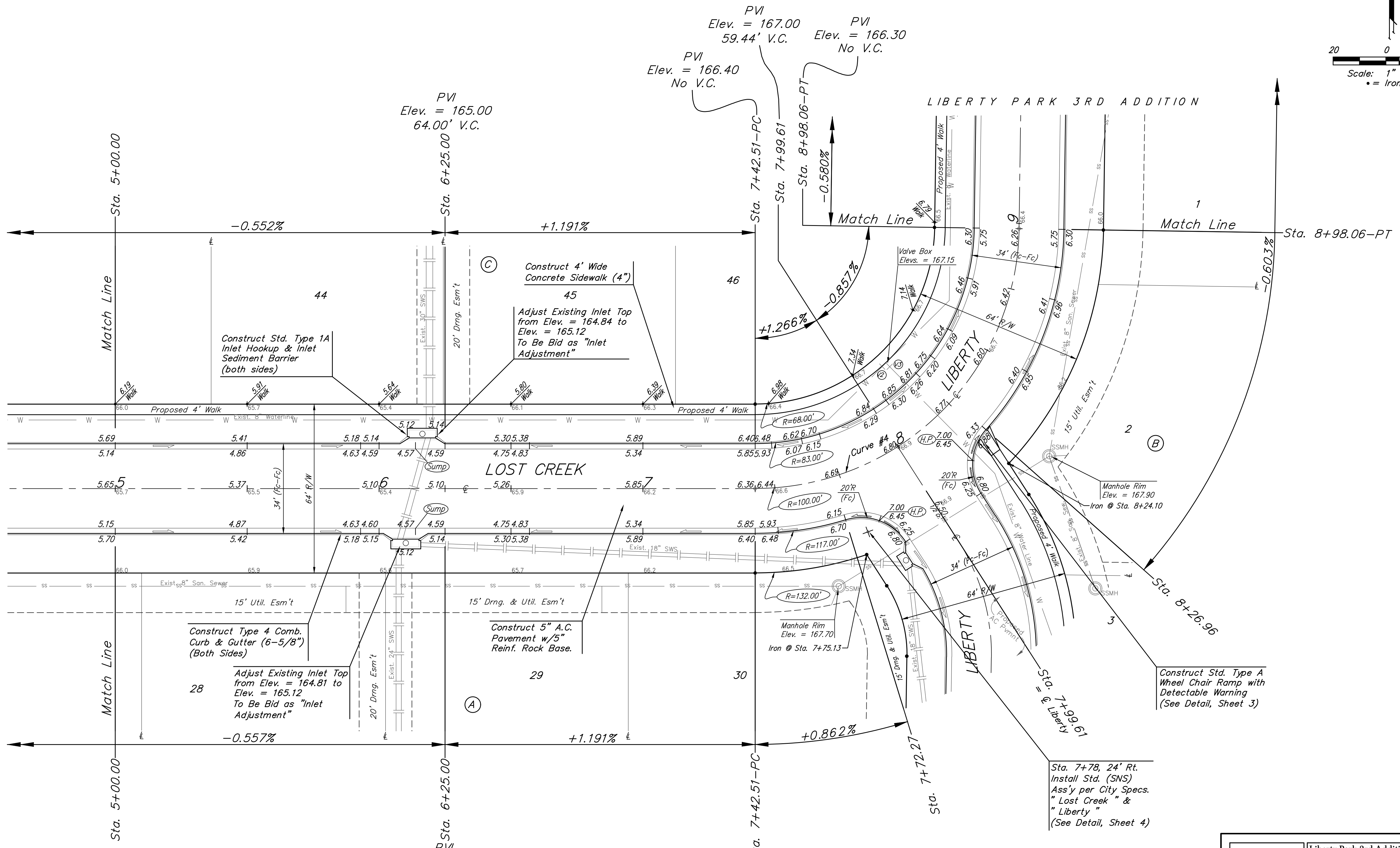
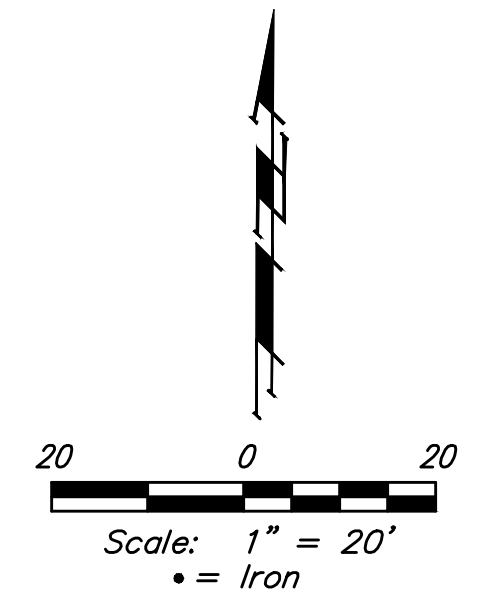

LIBERTY PARK 3RD ADDITION

Curve #4
 Curve Data Based on Centerline
 Rad. = 100' Delta = 89°07'09" Tangent = 98.47'
 Arc = 155.54' L.C. = 140.33' Def./Pt. = 17.18899 Min.

Station	Arc	Face Chord Lengths		Defl.	Total Defl.
		8' Left	8' Right		
7+42.51	-	-	-	0°00'00"	0°00'00"
7+50.00	7.49'	5.62'	9.36'	2°08'45"	2°08'45"
7+71.94	21.94'	16.42'	27.37'	6°17'07"	8°25'52"
7+75.00	3.06'	2.29'	3.82'	0°52'36"	9°18'28"
8+00.00	25.00'	18.70'	31.17'	7°09'44"	16°28'12"
8+26.70	26.70'	19.97'	33.28'	7°38'56"	24°07'08"
8+50.00	23.30'	17.44'	29.06'	6°40'31"	30°47'39"
8+75.00	25.00'	18.70'	31.17'	7°09'43"	37°57'22"
8+98.05	23.05'	17.25'	28.75'	6°36'13"	44°33'35"

Baughman Liberty Park 3rd Addition - Phase 2C
LOST CREEK & LIBERTY
 Sta. 5+00 to Sta. 8+98.06

Baughman Company, P.A. 315 Ella St. Wichita, KS 67211 P 316-262-7271 F 316-262-0149
 ENGINEERING | SURVEYING | PLANNING | LANDSCAPE ARCHITECTURE

PROJECT NUMBER: 472-85140
 DESIGN: NBW
 DRAWN: JAK
 APPROVED: [Signature]
 DATE: 12/27/16

REVISIONS:

SCALE: Noted
 SHEET: **7 OF 22**

E:\Projects\Liberty Park 3rd_04031304\Engineering\Phase 2C\STR_USTR PLANS.dwg