

BENCHMARKS:

- BM #1 - Chiseled "□" on the Top of Curb on the North Side 10th Street North 90' West of the Centerline of Green.
Elev. = 1311.66 (NAVD 88)
- BM #2 - 60d Nail in the West face of the Light Pole in the Southwest Corner of 10th Street North and Estelle.
Elev. = 1315.40 (NAVD 88)

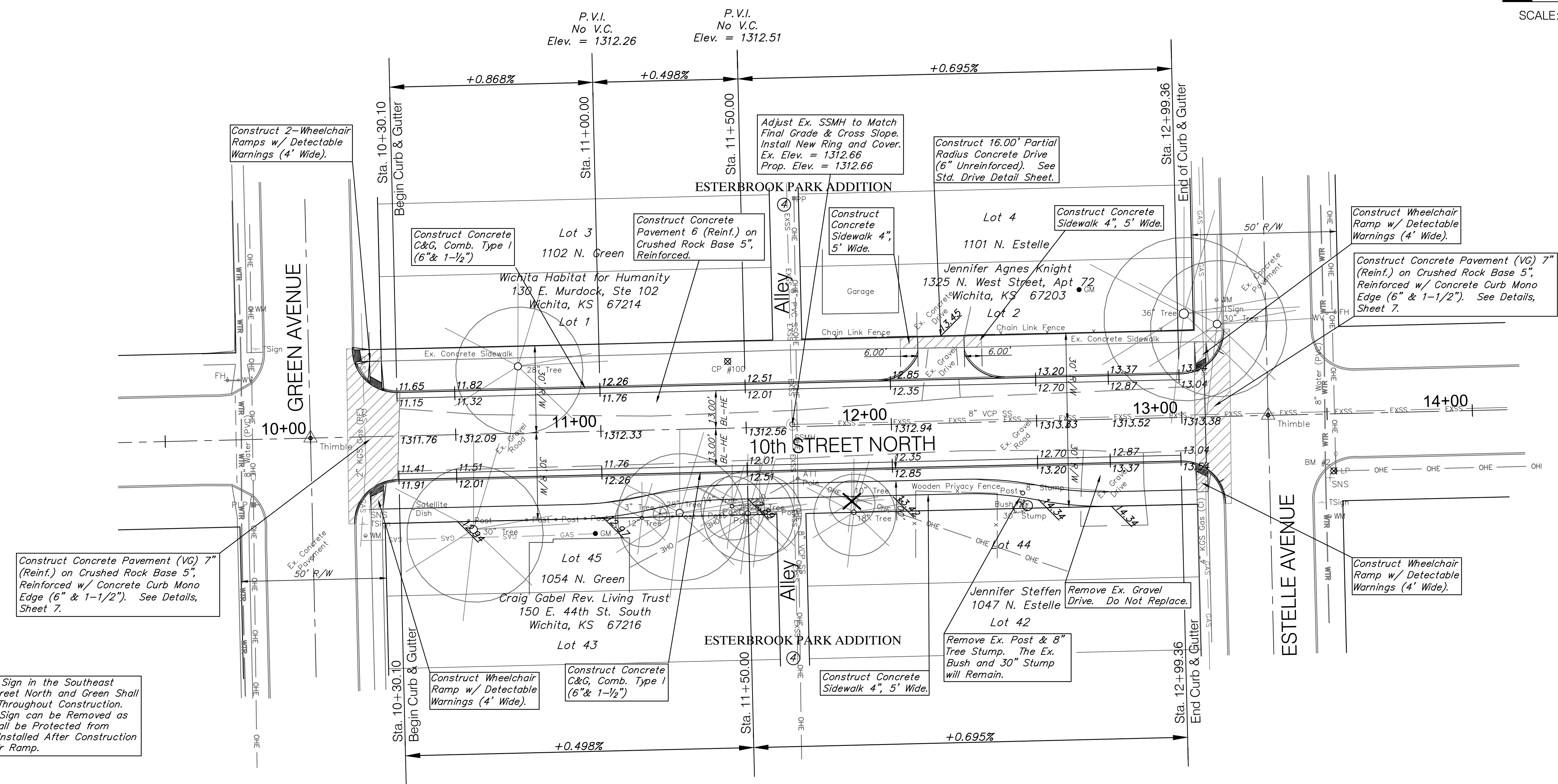
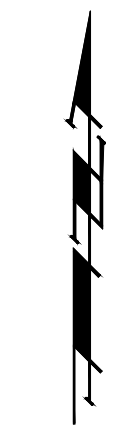

Construct Concrete Pavement (VG) 7" (Reinf.) on Crushed Rock Base 5", Reinforced w/ Concrete Curb Mono Edge (6" & 1-1/2"). See Details, Sheet 7.

The Existing Stop Sign in the Southeast Corner of 10th Street North and Green Shall Remain in Place Throughout Construction. The Street Name Sign can be Removed as Necessary but Shall be Protected from Damage and Re-Installed After Construction of the Wheel Chair Ramp.

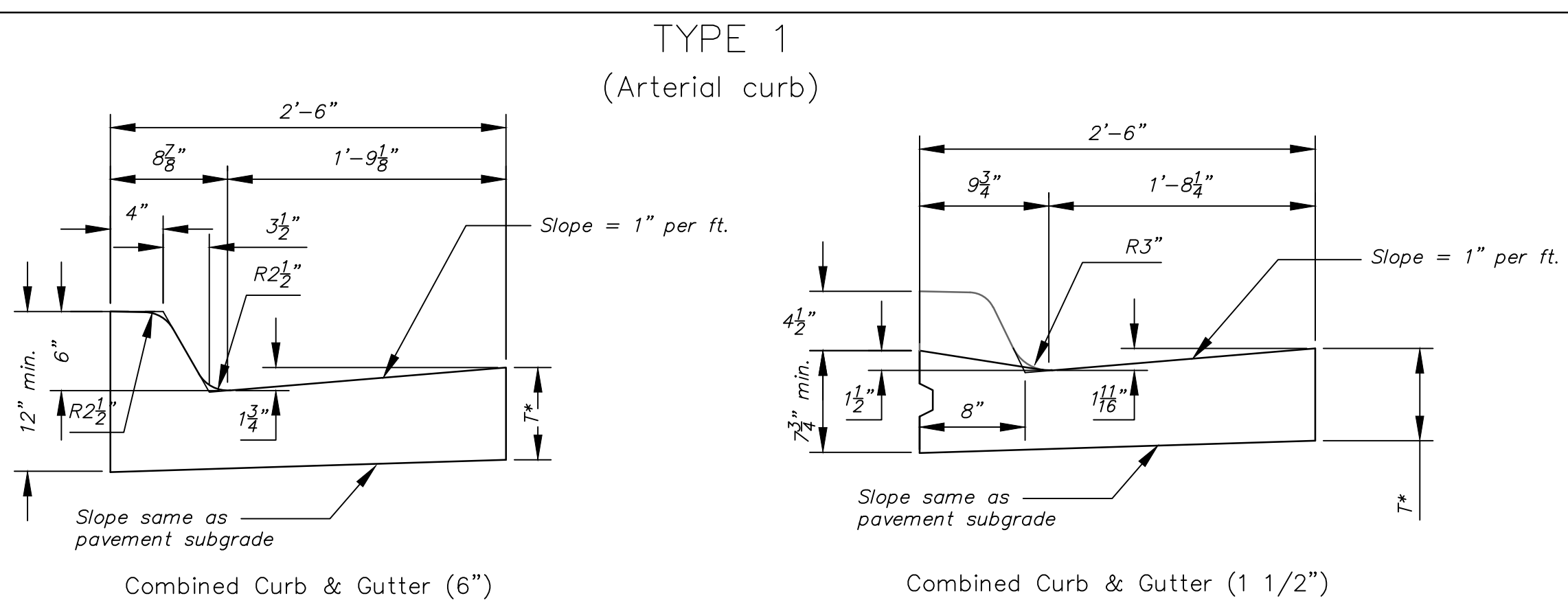

AREAS TO BE SODDED = 600 S.Y.

The Contractor Shall be responsible for sodding all areas disturbed by construction activities. All costs associated with any additional sodded areas that are not hatched on this plan shall be SUBSIDIARY to the Lump Sum Bid Item.

The Quantity on This Sheet are FOR INFORMATION ONLY. All cost associated with the Sodding activities shall not be paid for directly, but shall be SUBSIDIARY to the Lump Sum Bid Item.

Note:
Trees/Shrubs to be removed are marked thus:

Note:
Pavement, Sidewalks, and Etc. To Be Removed Are Indicated By:

Drawing File: E:\Projects\10th Street Paving\10th Street Paving Base.dwg (Pw 01)
Project No. 1607-E507 CAPITAL IMPROVEMENT PROJECT
Design: TPV
Drawn: TPV
Approved: TPV
Scale: NOTED
10th STREET NORTH PAVING
Sta. 10+29.62 to Sta. 13+04.72
10th STREET NORTH - ESTELLE TO GREEN