

| FHWA REGION NO. | STATE | PROJECT NUMBER | FISCAL YEAR | SHEET NUMBER | TOTAL SHEETS |
|-----------------|--------|----------------|-------------|--------------|--------------|
| 7 | KANSAS | TE-0254-01 | 2005 | 1 | 21 |
| FED. AID NO. | | | | | |

STATE OF KANSAS
DEPARTMENT OF TRANSPORTATION
**K-96 TRAILHEAD LANDSCAPE
PROJECT**

GROVE PARK
FEDERAL AID PROJECT

CITY OF WICHITA PROJECT NO. 472-84272

INDEX CODE: 706928

WICHITA, SEDGWICK COUNTY
K.D.O.T. PROJECT NO. TE-0254-01

FINAL CONSTRUCTION DOCUMENTS



LOCATION MAP

PREPARED BY:

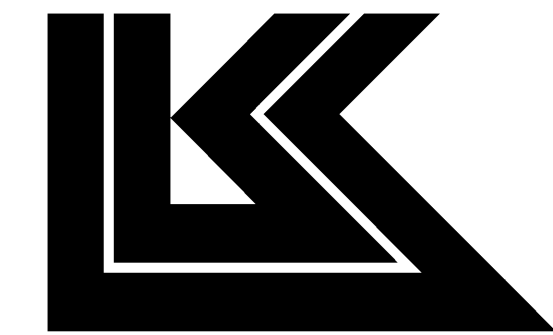

LAW/KINGDON, INC.
ARCHITECTS • ENGINEERS • PLANNERS
LANDSCAPE ARCHITECTS
345 RIVERVIEW #200, WICHITA, KS 67203
Phone (316) 268-0200 Fax (316) 268-0205
Copyright ©2007

PREPARED FOR:



Office of the City Engineer
JAMES ARMOUR, P.E., CITY ENGINEER

455 N. Main, 7th Floor
Wichita, Kansas 67202

INDEX OF SHEETS

| | | | FIELD CHECK | OFFICE CHECK | REVISED OFFICE CHECK | FOR CONSTRUCTION |
|----|-------|---|-------------|--------------|----------------------|------------------|
| 1 | | COVER SHEET | | | | |
| 2 | DM1.1 | SITE DEMOLITION/CLEARING/EROSION CONTROL PLAN | 1/10/05 | 6/13/05 | 9/29/05 | 1/22/07 |
| 3 | SA0.1 | GENERAL PROJECT NOTES/SUMMARY OF QUANTITY ITEMS | 1/10/05 | 6/13/05 | 9/29/05 | 1/22/07 |
| 4 | BMP.1 | BMP DETAILS | 1/10/05 | 6/13/05 | 9/29/05 | 1/22/07 |
| 5 | BMP.2 | BMP DETAILS | 1/10/05 | 6/13/05 | 9/29/05 | 1/22/07 |
| 6 | BMP.3 | BMP DETAILS | 1/10/05 | 6/13/05 | 9/29/05 | 1/22/07 |
| 7 | SA1.1 | SITE LAYOUT PLAN | 1/10/05 | 6/13/05 | 9/29/05 | 1/22/07 |
| 8 | SA1.2 | SITE LAYOUT PLAN | 1/10/05 | 6/13/05 | 9/29/05 | 1/22/07 |
| 9 | SA2.1 | ENLARGED TRAILHEAD LAYOUT | 1/10/05 | 6/13/05 | 9/29/05 | 1/22/07 |
| 10 | SA2.2 | ENLARGED TRAILHEAD GRADING | 1/10/05 | 6/13/05 | 9/29/05 | 1/22/07 |
| 11 | SA3.1 | SITE DETAILS | 1/10/05 | 6/13/05 | 9/29/05 | 1/22/07 |
| 12 | SA3.2 | SITE DETAILS | 1/10/05 | 6/13/05 | 9/29/05 | 1/22/07 |
| 13 | SU1.1 | SITE UTILITY PLAN | 1/10/05 | 6/13/05 | 9/29/05 | 1/22/07 |
| 14 | IR1.1 | IRRIGATION PLAN | 1/10/05 | 6/13/05 | 9/29/05 | 1/22/07 |
| 15 | IR2.1 | TRAILHEAD IRRIGATION PLAN | 1/10/05 | 6/13/05 | 9/29/05 | 1/22/07 |
| 16 | IR3.1 | IRRIGATION NOTES & DETAILS | 1/10/05 | 6/13/05 | 9/29/05 | 1/22/07 |
| 17 | LP1.1 | LANDSCAPE PLANTING PLAN | 1/10/05 | 6/13/05 | 9/29/05 | 1/22/07 |
| 18 | LP1.2 | TRAILHEAD PLANTING PLAN | 1/10/05 | 6/13/05 | 9/29/05 | 1/22/07 |
| 19 | LP2.1 | ENLARGED PLANTING PLAN | 1/10/05 | 6/13/05 | 9/29/05 | 1/22/07 |
| 20 | LP3.1 | PLANTING NOTES & SCHEDULE | 1/10/05 | 6/13/05 | 9/29/05 | 1/22/07 |
| 21 | LP3.2 | PLANTING DETAILS | | 6/13/05 | 9/29/05 | 1/22/07 |

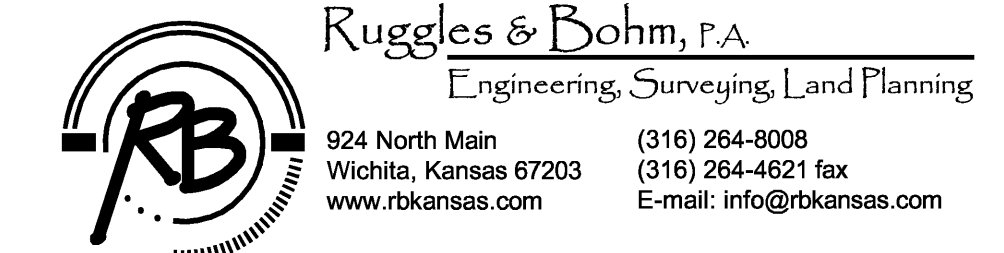

Ruggles & Bohm, P.A.
Engineering, Surveying, Land Planning
924 North Main (316) 264-8008
Wichita, Kansas 67203 (316) 264-4621 fax
www.rbkansas.com E-mail: info@rbkansas.com

| | |
|--|---|
| Jeffrey A. Best, ASLA Law/Kingdon, Inc. Sheets: DM1.1 SA1.2 SA3.1 IR2.1 LP1.2 LP3.2 SA0.1 SA2.1 SA3.2 IR3.1 LP2.1 SA1.1 SA2.2 IR1.1 LP1.1 LP3.1 | Tom Ruggles, PE Ruggles & Bohm Sheets: SU1.1 |
|--|---|