

WATER VALVE BOX ELEVATIONS			
STREET	STATION	OFFSET	PROPOSED ELEVATION
LAKE RIDGE COURT	67+11.33	39.73' RL	155.0
LAKE RIDGE COURT	69+56.29	22.0' LI	146.4

SCALE: 1"=20'

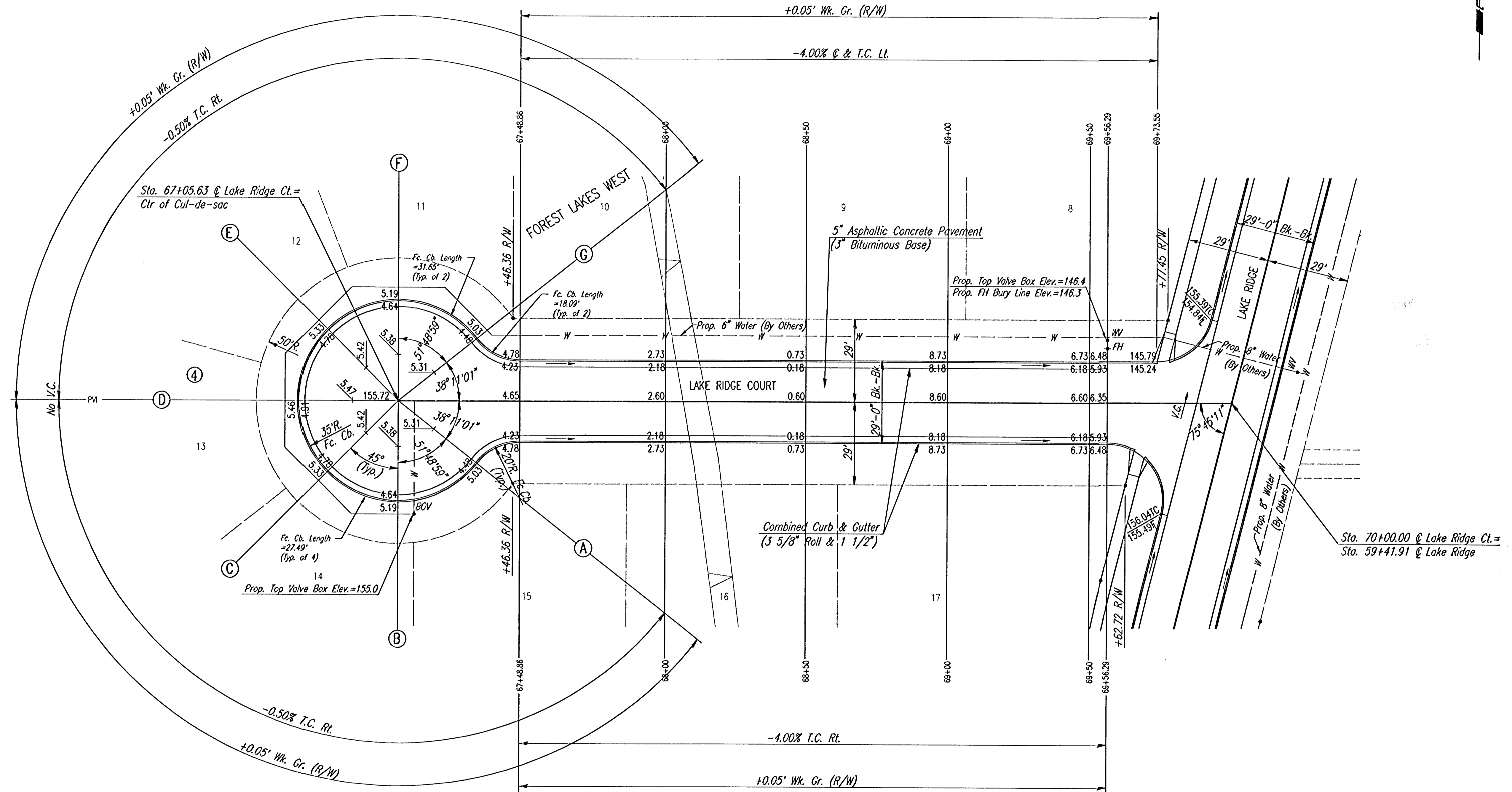

NOTE: THIS STREET TO BE CONSTRUCTED WITH ROLL-TYPE CURB. TOP OF CURB ELEVATIONS GIVEN ARE FOR FULL HEIGHT CURB.

DSNR: BER OPER: BUS SCALE: 1"=20.00
 Q:\2001\01372\007\str67-70 03-05-2003 08:11:11 am

Revision		By	Date
FOREST LAKES WEST-PHASE 4 CITY OF WICHITA, KANSAS LAKE RIDGE COURT STA. 67+05.63 TO STA. 70+00 CITY OF WICHITA PROJ. NO. 472-82873			
Professional Engineering Consultants, P.A. <small>303 S. TOPEKA • WICHITA, KANSAS 67202 316-262-2691 • FAX 316-262-3003</small>			
Designed by	BER	Job No.	35-01372-007
Drawn by	BJS	Date	JAN 2003
			Sht. 5 of 14