

B.M. - RAILROAD SPIKE IN POWER POLE, NORTHWEST SUBSTATION ADDITION.
ELEV.=159.96 CITY DATUM
ELEV.=1347.36 M.S.L.

CITY DATUM USED FOR ALL ELEVATIONS.
MEAN SEA LEVEL = CITY DATUM + 1187.4

ESTABLISHED MINIMUM PAD (LOWEST OPENING) ELEVATIONS ARE AS FOLLOWS:
BLOCK 3
LOTS 13 THROUGH 25 144.1 1331.5
LOTS 27 AND 28 144.1 1331.5

ADDITIONAL LOT REQUIREMENTS
a - MIN. OPENING ≥ 159.00
c - MIN. OPENING ≥ 157.00

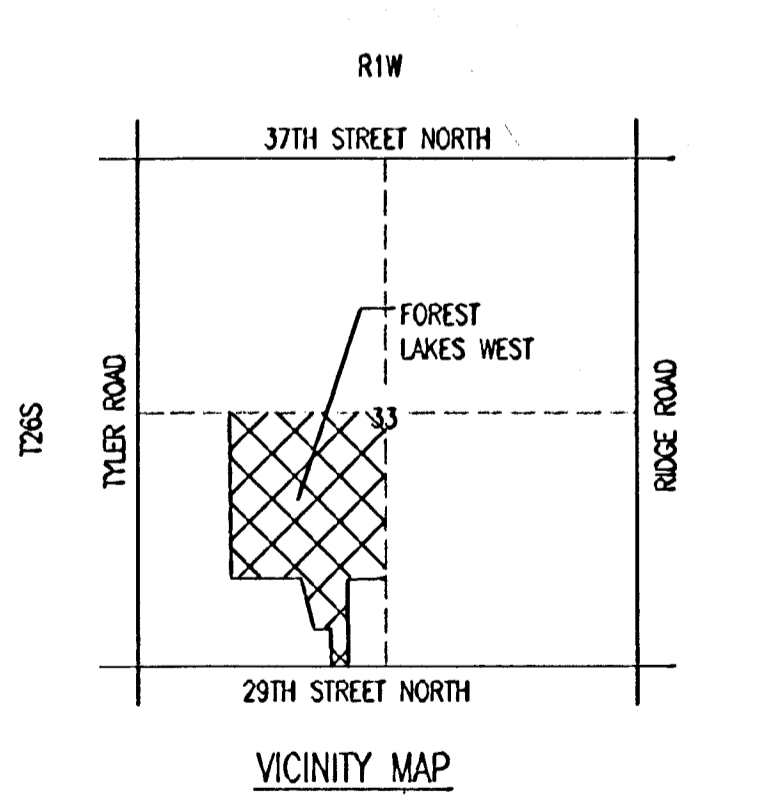

- LEGEND**
- STORM SEWER AND INLET
 - SS— PROPOSED SANITARY SEWER
 - ⊙ VO VIEWOUT BASEMENT
 - ⊙ WO WALKOUT BASEMENT
 - ⊙ PVO POSSIBLE VIEWOUT BASEMENT
 - ⊙ PWO POSSIBLE WALKOUT BASEMENT
 - ⊗ FULL FOUNDATION
 - 4 CORNER LOT ELEVATION (ADD 100 FOR CITY DATUM)
 - H.P. HIGH POINT
 - * MATCH EXISTING
 - ℓ FLOW LINE (DITCH)
 - TC TOP OF CURB

DSNR: S4D OPER: BUS SCALE: 1"=100.00
 Q:\2001\01372\4CORNER_03-05-2003_08:33:08.dwg

No.	Revision	By	Date
FOREST LAKES WEST-PHASE CITY OF WICHITA, KANSAS FOUR CORNER LOT GRADING PLAN CITY OF WICHITA PROJ. NO. 472-82873 Professional Engineering Consultants, P.A. 303 S. TOPEKA • WICHITA, KANSAS 67202 316-262-2691 • FAX 316-262-3003			
Designed by	BER	Job No.	35-01372-007
Drawn by	BJS	Date	JAN. 2003
			Sht. 13 of 14