

BENCHMARKS:
BM #1: Disc on Top of Curb
 South side of 27th St. N. and
 West of 27th Ct. N. Woods
 North 3rd Addition
 Elev. = 1397.69 NAVD88

BM #2: Northwest 1/4 Corner,
 Government Lot 2, Sec. 3, TWP.
 27-S, R-2-E
 Elev. = 1405.78 NAVD88

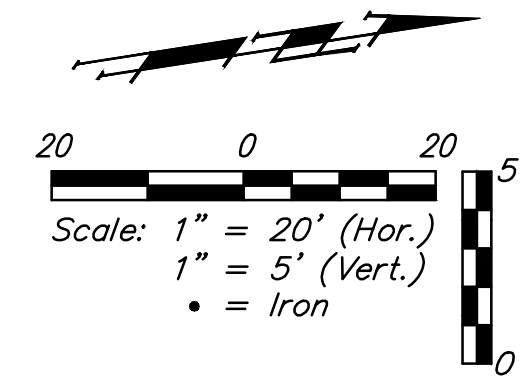

Curve #6
 Curve Data Based on Centerline
 Rad. = 200' Delta = 66°44'27" Tangent = 131.73'
 Arc = 69.28' L.C. = 220.02' Def./Ft. = 28.90048 Min.

Station	Arc	8' Left	8' Right	Defl.	Total Defl.
12+94.54	-	-	-	0'00"00"	0'00"00"
13+00.00	5.46'	20.65'	16.06'	2'37'48"	2'37'48"
13+25.00	25.00'	93.88'	73.02'	12'02'31"	14'40'19"
13+50.00	25.00'	93.88'	73.02'	12'02'30"	26'42'49"
13+63.82	13.82'	52.16'	40.57'	6'39'24"	33'22'13"

Curve #7
 Curve Data Based on Centerline
 Rad. = 200' Delta = 67°18'17" Tangent = 133.14'
 Arc = 234.94' L.C. = 221.66' Def./Ft. = 8.59429 Min.

Station	Arc	8' Left	8' Right	Defl.	Total Defl.
13+63.82	-	-	-	0'00"00"	0'00"00"
13+75.00	11.18'	9.78'	12.58'	1'36'05"	1'36'05"
14+00.00	25.00'	21.86'	28.11'	3'34'51"	5'10'56"
14+25.00	25.00'	21.86'	28.11'	3'34'52"	8'45'48"
14+50.00	25.00'	21.86'	28.11'	3'34'51"	12'20'39"
14+75.00	25.00'	21.86'	28.11'	3'34'52"	15'55'31"
15+00.00	25.00'	21.86'	28.11'	3'34'51"	19'30'22"
15+25.00	25.00'	21.86'	28.11'	3'34'52"	23'05'14"
15+50.00	25.00'	21.86'	28.11'	3'34'51"	26'40'05"
15+75.00	25.00'	21.86'	28.11'	3'34'51"	30'14'56"
15+98.76	23.76'	20.78'	26.71'	3'24'13"	33'39'09"

VALVE LOCATION TABLE

VALVE NUMBER	BASELINE STATION	OFFSET DISTANCE	OFFSET DIRECTION
9	12+94.54	28.00'	Lt
10	14+47.29	25.67'	Lt
11	16+86.58	26.00'	Lt
12	18+97.76	36.00'	Lt

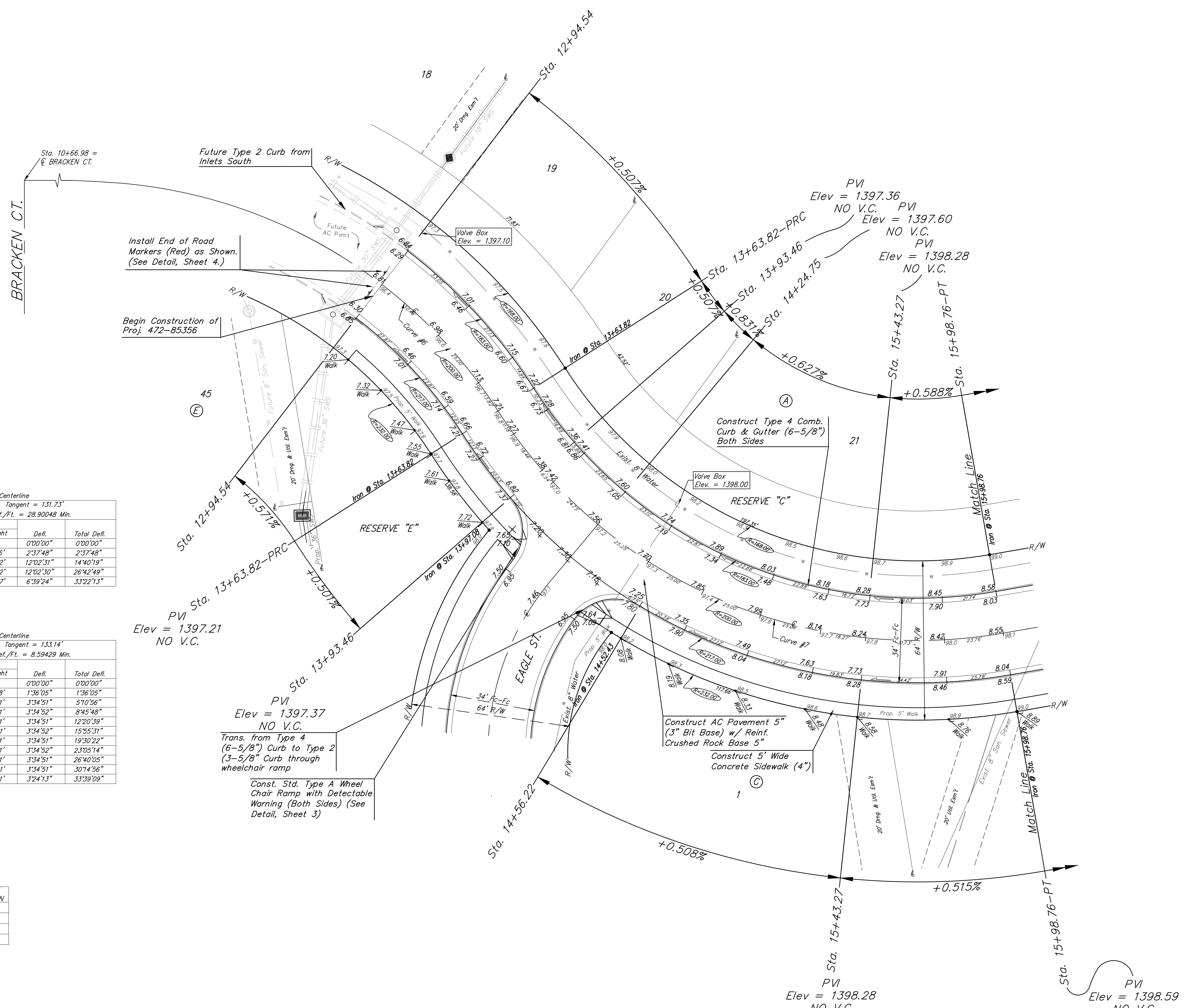

Sta. 10+66.98 =
 C BRACKEN CT.
 Future Type 2 Curb from
 Inlets South
 R/W
 Future AC Pvmnt
 Install End of Road
 Markers (Red)
 as Shown.
 (See Detail, Sheet 4.)
 Begin Construction of
 Proj. 472-85356

Sta. 12+94.54
 +0.571%
 +0.507%
 Sta. 13+63.82-PRC
 +0.507%
 Iron @ Sta. 13+63.82
 Elev. = 1397.10
 Valve Box
 Elev. = 1397.10

PVI
 Elev = 1397.21
 NO V.C.
 Sta. 13+93.46
 +0.507%
 Iron @ Sta. 13+93.46
 Elev. = 1397.37
 NO V.C.

Trans. from Type 4
 (6-5/8") Curb to Type 2
 (3-5/8") Curb through
 wheelchair ramp
 Const. Std. Type A Wheel
 Chair Ramp with Detectable
 Warning (Both Sides) (See
 Detail, Sheet 3)

PVI
 Elev = 1397.36
 NO V.C.
 PVI
 Elev = 1397.60
 NO V.C.
 PVI
 Elev = 1398.28
 NO V.C.

Valve Box
 Elev. = 1398.00
 Construct Type 4 Comb.
 Curb & Gutter (6-5/8")
 Both Sides
 RESERVE "C"

Construct AC Pavement 5"
 (3" Bit Base) w/ Reinf.
 Crushed Rock Base 5"
 Construct 5' Wide
 Concrete Sidewalk (4")

PVI
 Elev = 1398.28
 NO V.C.
 Sta. 15+43.27
 +0.515%

PVI
 Elev = 1398.59
 NO V.C.
 Sta. 15+98.76-PT

	Firely Way Addition Ph. 1
	BRACKEN ST.
Sta. 12+94.54 to Sta. 15+98.76	
Baughman Company, P.A. 315 Ellis St. Wichita, KS 67211 P 316.262.0149 F 316.262.0149	
ENGINEERING SURVEYING PLANNING LANDSCAPE ARCHITECTURE	
PROJECT NUMBER 472-85356	DESIGN AEG
REVISIONS:	DRAWN DJL
	APPROVED DATE 3/17
	SCALE Noted
	SHEET 13 OF 38