

**BENCHMARKS:**  
 RR spike in asphalt, SW COR., N1/2, SW1/4, Sec. 34, TWP. 26-S, R-2-E. Elev. = 1400.59 NAVD88

RR spike in E. face of power pole, 174± N. of S. line, N1/2, SW1/4 & 49± E. of W. line, SW1/4, Sec. 34, TWP. 26-S, R-2-E. Elev. = 1398.64 NAVD88

RR spike in S. face of power pole, 294± S. of N. line, SW1/4, & 48± E. of W. line, SW1/4, Sec. 34, TWP. 26-S, R-2-E. Elev. = 1386.14 NAVD88

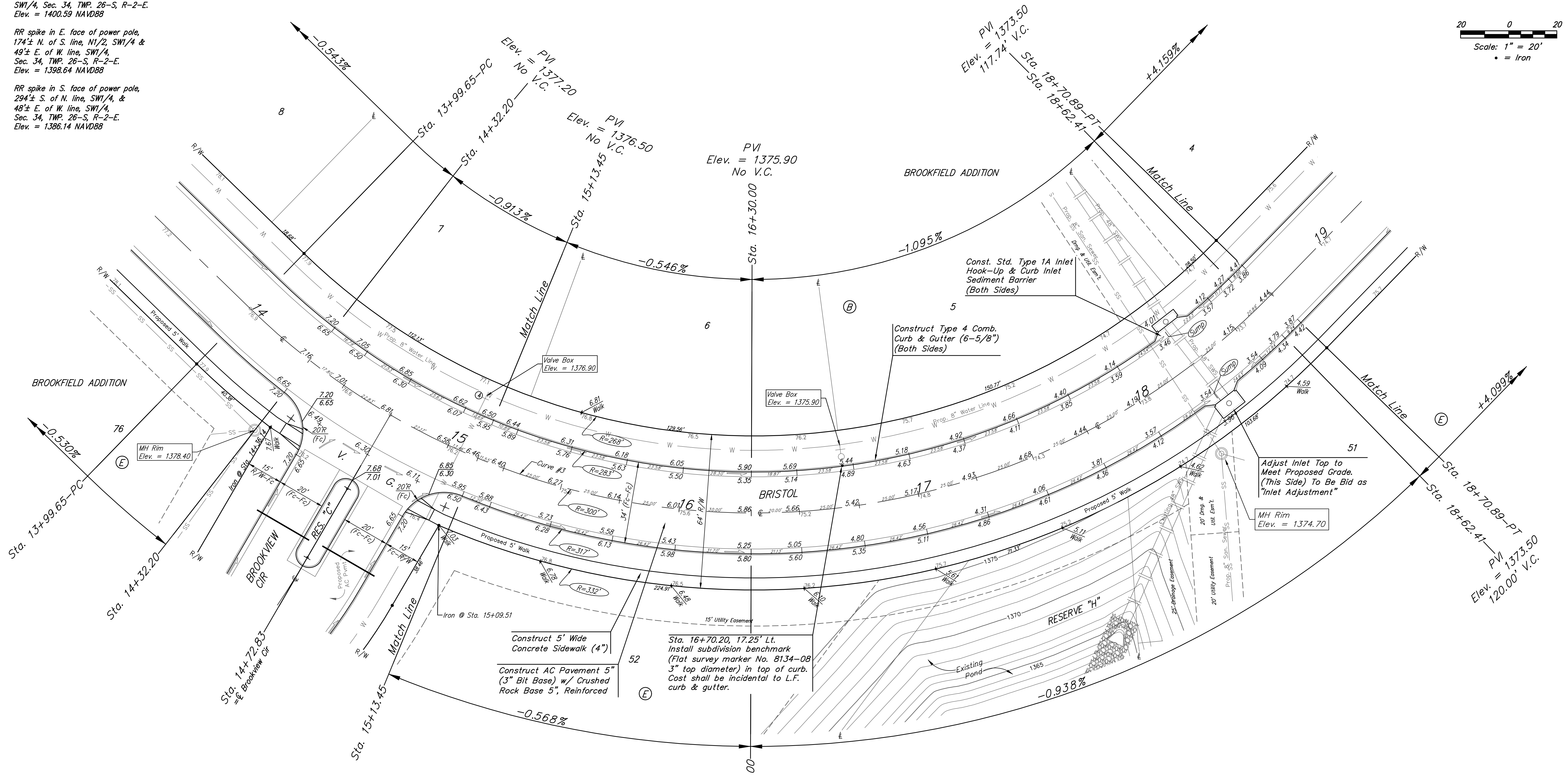
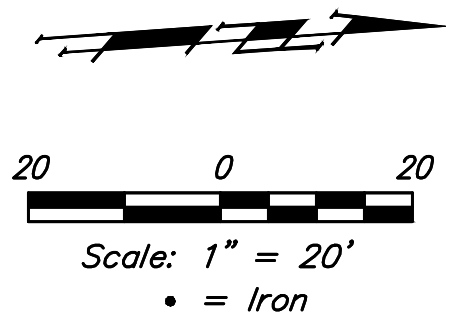

Curve #3

Curve Data Based on Centerline

Rad. = 300' Delta = 90°00'00" Tangent = 300.00'  
 Arc = 471.24' L.C. = 424.26' Def./Ft. = 5.72956 Min.

| Station  | Arc    | Face Chord Length |          | Defl.    | Total Defl. |
|----------|--------|-------------------|----------|----------|-------------|
|          |        | 8' Left           | 8' Right |          |             |
| 13+99.65 | -      | -                 | -        | 0°00'00" | 0°00'00"    |
| 14+25.00 | 25.35' | 23.23'            | 27.45'   | 2°25'15" | 2°25'15"    |
| 14+32.20 | 7.20'  | 6.60'             | 7.80'    | 0°41'15" | 3°06'30"    |
| 14+50.00 | 17.80' | 16.31'            | 19.28'   | 1°41'59" | 4°48'29"    |
| 14+75.00 | 25.00' | 22.91'            | 27.08'   | 2°23'14" | 7°11'43"    |
| 15+00.00 | 25.00' | 22.91'            | 27.08'   | 2°23'15" | 9°34'58"    |
| 15+13.45 | 13.45' | 12.33'            | 14.57'   | 1°17'03" | 10°52'01"   |
| 15+25.00 | 11.55' | 10.59'            | 12.51'   | 1°06'11" | 11°58'12"   |
| 15+50.00 | 25.00' | 22.91'            | 27.08'   | 2°23'14" | 14°21'26"   |
| 15+75.00 | 25.00' | 22.91'            | 27.08'   | 2°23'15" | 16°44'41"   |

| Station  | Arc    | Face Chord Length |          | Defl.    | Total Defl. |
|----------|--------|-------------------|----------|----------|-------------|
|          |        | 8' Left           | 8' Right |          |             |
| 16+00.00 | 25.00' | 22.91'            | 27.08'   | 2°23'14" | 19°07'55"   |
| 16+25.00 | 25.00' | 22.91'            | 27.08'   | 2°23'14" | 21°31'09"   |
| 16+50.00 | 25.00' | 22.91'            | 27.08'   | 2°23'15" | 23°54'24"   |
| 16+75.00 | 25.00' | 22.91'            | 27.08'   | 2°23'14" | 26°17'38"   |
| 17+00.00 | 25.00' | 22.91'            | 27.08'   | 2°23'14" | 28°40'52"   |
| 17+25.00 | 25.00' | 22.91'            | 27.08'   | 2°23'15" | 31°04'07"   |
| 17+50.00 | 25.00' | 22.91'            | 27.08'   | 2°23'14" | 33°27'21"   |
| 17+75.00 | 25.00' | 22.91'            | 27.08'   | 2°23'15" | 35°50'36"   |
| 18+00.00 | 25.00' | 22.91'            | 27.08'   | 2°23'14" | 38°13'50"   |
| 18+25.00 | 25.00' | 22.91'            | 27.08'   | 2°23'14" | 40°37'04"   |
| 18+50.00 | 25.00' | 22.91'            | 27.08'   | 2°23'15" | 43°00'19"   |
| 18+70.89 | 20.89' | 19.15'            | 22.63'   | 1°59'41" | 45°00'00"   |

Sta. 16+30.00  
 PVI  
 Elev. = 1375.80  
 No V.C.

**Baughman**

ENGINEERING | SURVEYING | PLANNING | LANDSCAPE ARCHITECTURE

Brookfield Addition - Phase I

**BRISTOL**

Sta. 15+13.45 to Sta 18+70.89

|                             |  |                |                         |
|-----------------------------|--|----------------|-------------------------|
| PROJECT NUMBER<br>472-85344 |  | DESIGN<br>AEG  | DRAWN<br>JAK            |
| REVISIONS:                  |  | APPROVED       | DATE<br>6/30/17         |
|                             |  | SCALE<br>Noted | SHEET<br><b>9 OF 56</b> |

E:\Projects\Brookfield Addition\_1604F190\Engineering\Phase I\STR\_1608E544\STR PLANS.dwg