

SOUTH END ELEVATION

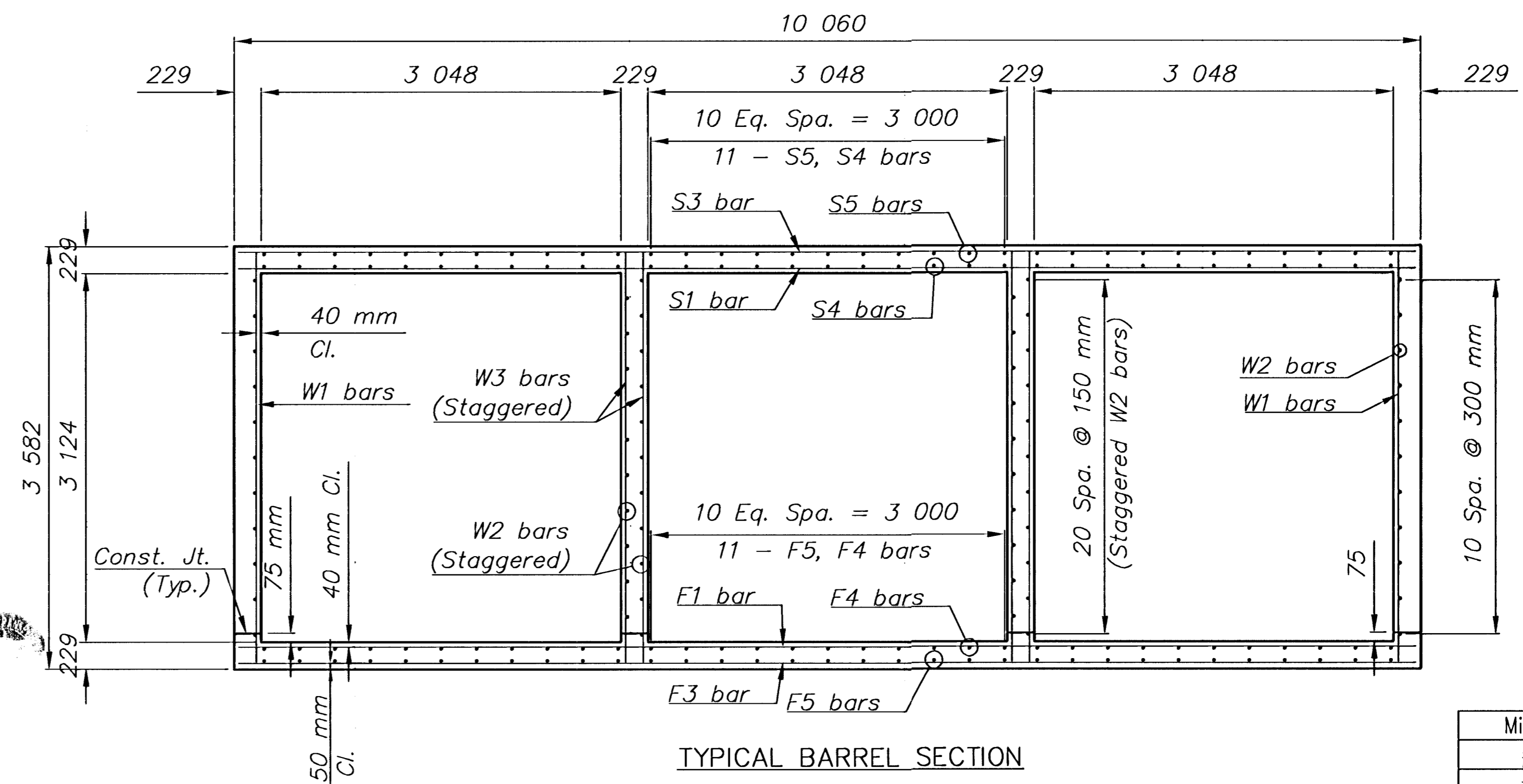

TYPICAL BARREL SECTION

Minimum Splice Lengths	
#10	400 mm
#13	500 mm
#16	600 mm

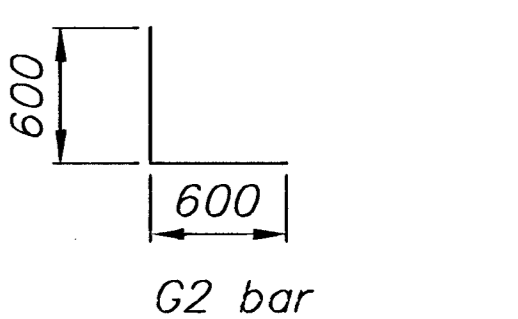

BENDING DIAGRAM

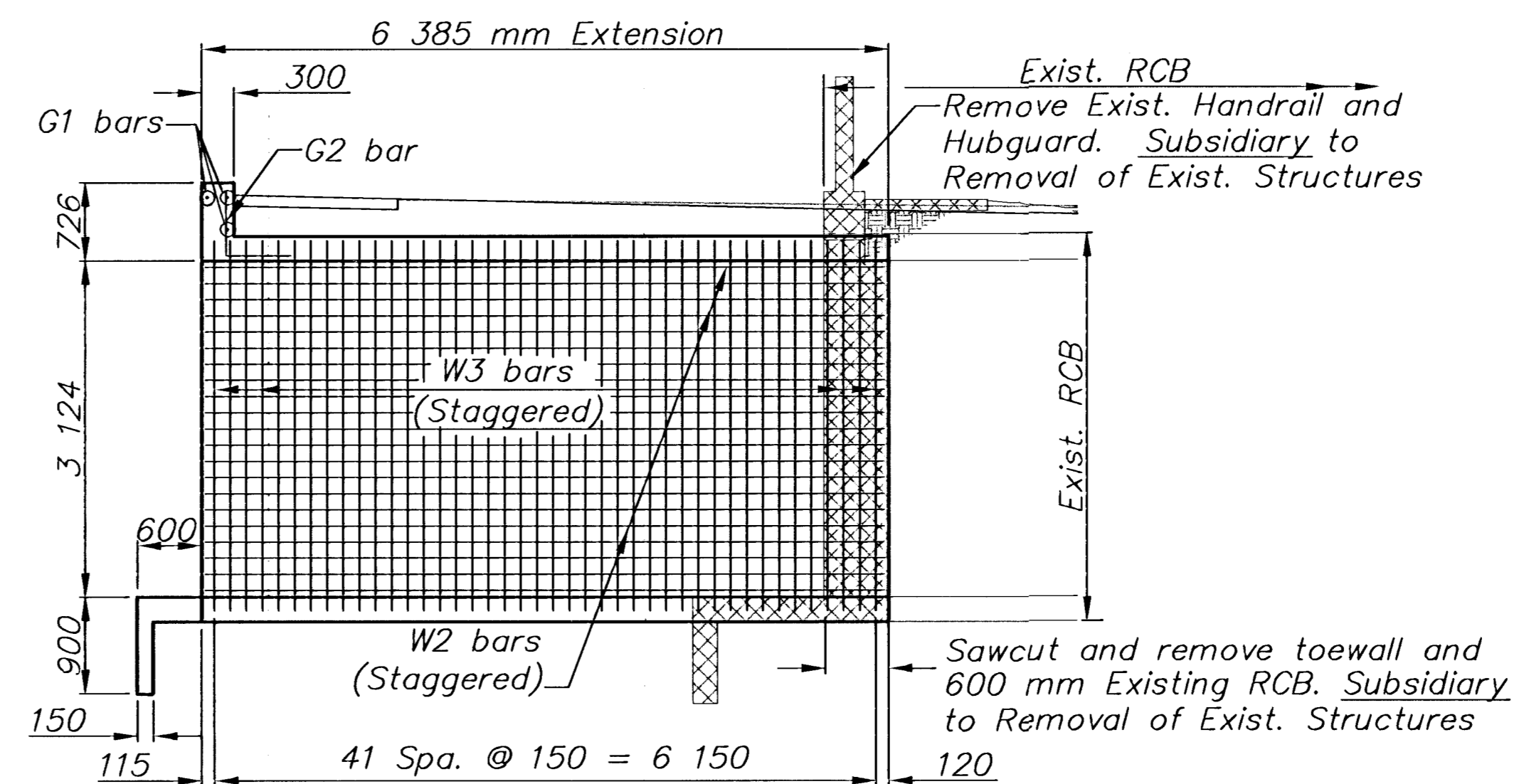

SOUTH END LONGITUDINAL SECTION

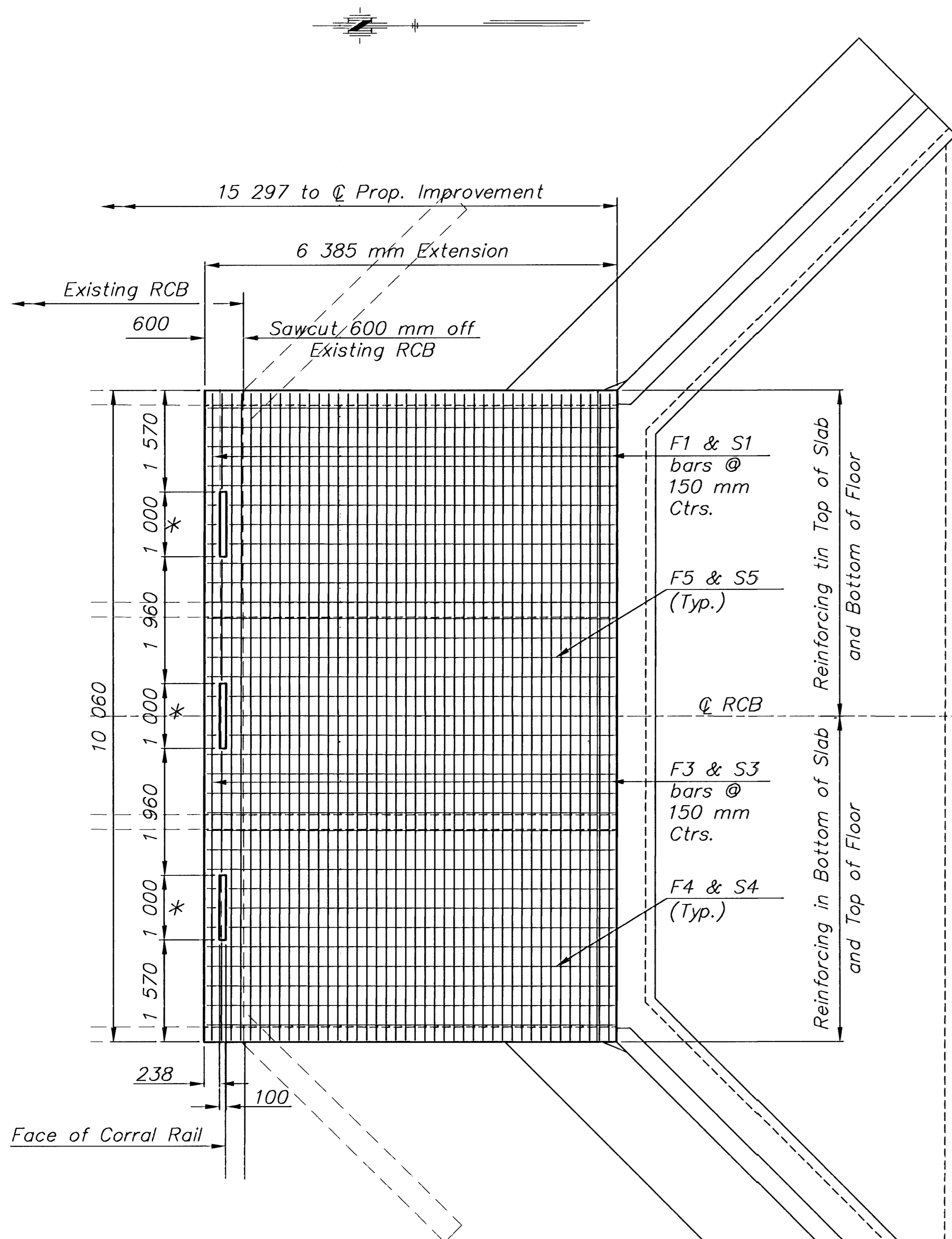

SOUTH END PLAN

*100 x 1,000 mm opening through top slab of RCB. Reinforcing steel shall be field cut as necessary to avoid running through opening.

G:\CIVIL\01079\DETAILS\01079RCBS.DWG 9/9/2003 4:29:45 PM CST

NO.	DATE	REVISIONS	BY	APP'D
2				
1				

KANSAS DEPARTMENT OF TRANSPORTATION

TRIPLE 3.048 x 3.124 m
SOUTH END (0° SKEW)

PROJ. NO. 87 N-0141-01 SEDGWICK CO.

MKEC ENGINEERING CONSULTANTS, INC.
WICHITA, KANSAS

DESIGNED BY: KJS CHECKED BY: KJS
DRAWN BY: RSB DATE: JAN. 2003 SHEET 17 OF 48