

**INDEX TO DRAWINGS**

SHEET NO.	DESCRIPTION
1	TITLE SHEET
2	GENERAL NOTES
3	TYPICAL SECTIONS
4-16	PAVING PLANS/PROFILES - SENECA
17-18	INTERSECTION PLANS
19	SCHOOL CROSSING DETAILS
20-29	WATER MAIN PLANS
30	SANITARY SEWER PLANS
31-35	PAVING DETAILS
36-41	STORM SEWER DETAILS
42	WATER MAIN DETAILS
43-45	EROSION CONTROL
46	SUMMARY OF QUANTITIES
47-56	SIGNALIZATION PLANS
57-60	PAVEMENT MARKING & SIGNING PLANS
61-62	STREET LIGHTING PLANS
63	CONSTRUCTION SEQUENCE AND TRAFFIC HANDLING
64-71	TRAFFIC CONTROL
72-87	CROSS SECTIONS

PAVING PLANS FOR  
**SENECA STREET**

CITY OF WICHITA  
SEDGWICK COUNTY, KANSAS

**PROJECT NO. 472-82966**

MICHAEL E. LINDEBAK, CITY ENGINEER

**OCA NO. 706747**

**WATER PROJECT NO. 448-89631 OOA 631846**

**SENECA STREET: MAPLE TO 3RD. STREET**

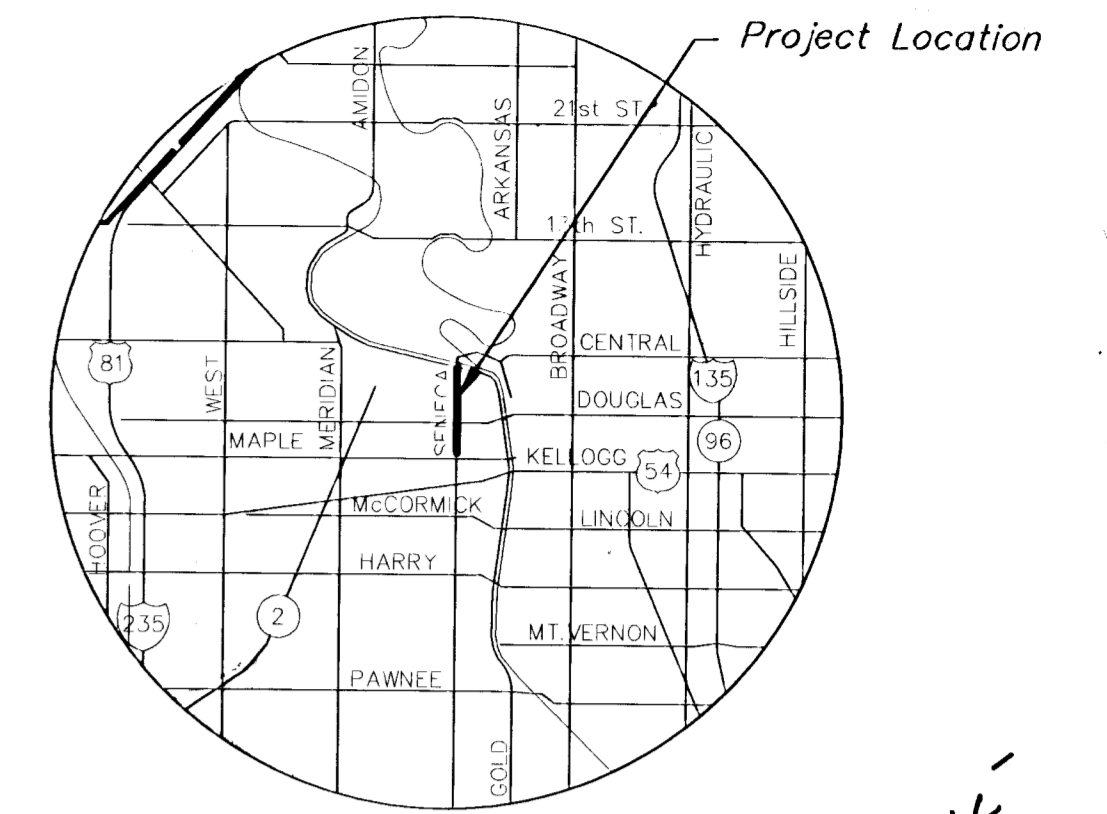

LOCATION MAP

*DRAINAGE  
BOOKED  
2-1-03  
MCG  
C-243*

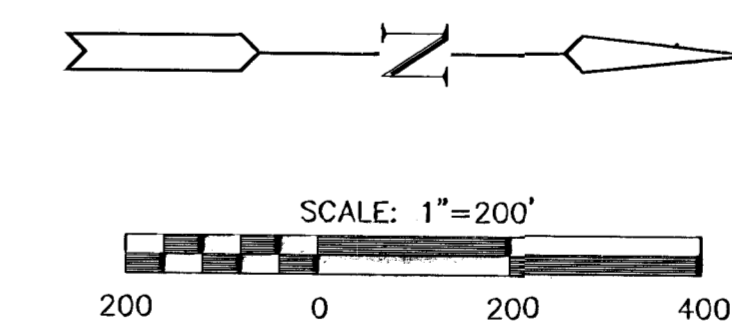
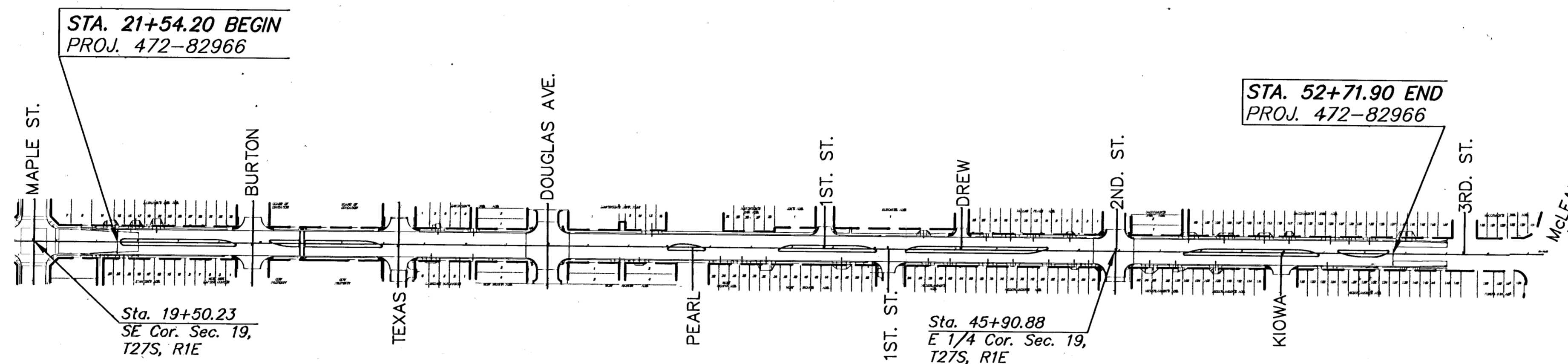

**BENCHMARKS**

- BM #2 COW BENCHMARK, 39.0' WEST AND 32.6' SOUTH OF CENTERLINE, SENECA AND MAPLE. ELEV.=109.78
- BM #3 CHISELED "I" TC, 20.1' EAST AND 36.1' SOUTH OF CENTERLINE, SENECA AND TEXAS. ELEV.=111.53
- BM #3A CHISELED "+", CENTERLINE 4' CONCRETE SIDEWALK, SOUTHEAST CORNER OF SENECA AND BURTON, WEST SIDE BAPTIST CHURCH. ELEV.=111.65
- BM #4 CHISELED "+", TOP OF SOUTHWEST BOLT, RR SIGNAL LIGHT, 24.5' WEST AND 380' NORTH OF CENTERLINE SENECA AND DOUGLAS. ELEV.=115.36
- BM #4A CHISELED "I" SOUTHEAST CORNER CONCRETE CURB INLET ON NORTHWEST CORNER SENECA AND DOUGLAS. ELEV.=112.56
- BM #4B CHISELED "I" TOP NORTHEAST CORNER 2.3' x 2.3' CONCRETE FLAGPOLE BASE, JAMES ALLISON SCHOOL. ELEV.=111.84
- BM #5 CHISELED "I" TOP OF EAST SIDE, 24" DIAMETER CONCRETE BASE, NORTHWEST CORNER, JOE'S EXPRESS LUBE AND OIL. ELEV.=116.94
- BM #6A RR SPIKE IN SOUTH SIDE OF 2ND. PP NORTH OF THE NORTHWEST CORNER OF SECOND AND DODGE. ELEV.=111.86
- BM #7 CHISELED "I" TOP SOUTHEAST CORNER 4' x11' CONCRETE STOOP, SENECA VETERINARY CLINIC, 435 N. SENECA. ELEV.=112.65

\* Established by Larkin Associates, 3-5-92

Background Topography established by Larkin Associates, circa 1992, supplemented with vertical data obtained by MKEC, May 1999.



S:\CIVIL\98092\PAV\98092\_ET.DWG

<p><b>MKEC</b> ENGINEERING CONSULTANTS 411 N. WEBB ROAD WICHITA, KS. 67206 316-684-9600</p>	<b>SENECA PAVING PLANS</b>	
	PROJECT NAME	
	<b>TITLE SHEET</b>	
	SHEET TITLE	
DESIGN BY: <b>DCH</b>	DRAWN BY: <b>WNJ</b>	CHECKED BY: <b>DCH</b>
DATE: <b>OCT. 2001</b>	JOB NO.: <b>98092_ET</b>	SHEET/OF: <b>1 / 87</b>

S:\CIVIL\98092\PAV\98092\_ET.DWG