

CENTERLINE VERTICAL CONTROL			
Station	P.V.I.	P.V.I. Elevation	Vertical Curve
51+64	H.P.	111.56	No
52+38.96	L.P.	110.97	No
52+71.90		110.97	No

Sta. 49+20.63 Seneca, Const. Std. Manhole (Type P), 25.00' Lt. Dia.=6'-0" Manhole Top=110.28 Install 36" x 318.33' Storm Swr. (RCP)(N)

Sta. 52+38.96 Seneca, Const. Std. Manhole (Type P), 25.00' Lt. Dia.=6'-0" Manhole Top=110.45 Install 36" x 50.00' Storm Swr. (RCP)(E)

Sta. 52+40.34 Seneca, Const. Curb Inlet (Type II, 32.18' Lt. L=6'-2-1/2", W=3'-4-3/8" Inlet Top=110.69 Install 15" x 7.18' Storm Swr. (RCP)(E)

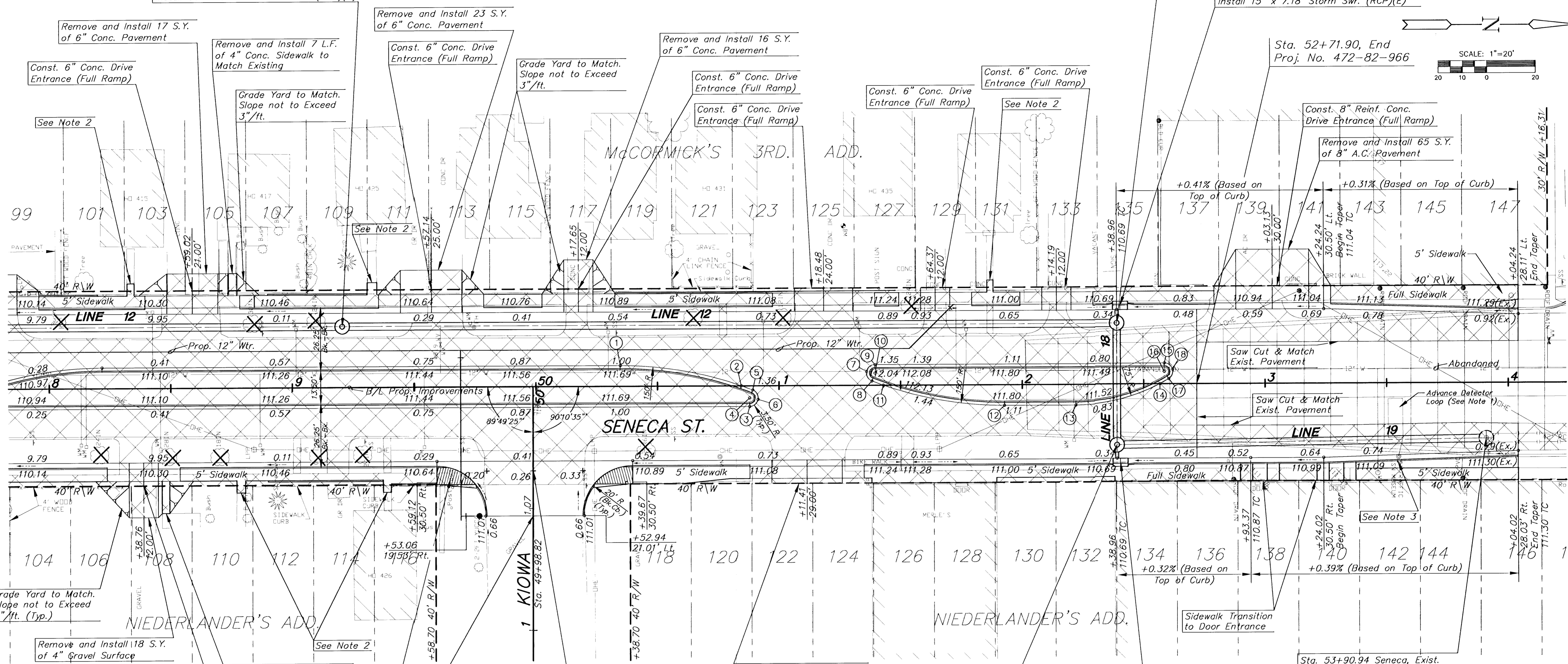
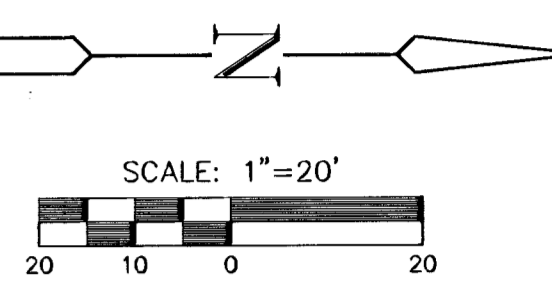

MEDIAN LOCATION				
Pt. No.	Station	Offset	Elevation High Edge	Elevation Top Curb
1	50+34.71	8.50' Lt.	110.99	111.68
2	50+84.49	0.00' Rt.	111.31	112.00
3	50+87.91	8.50' Rt.	111.15	111.84
4	50+87.91	5.00' Rt.		Radius Point
5	50+89.18	1.74' Rt.	111.29	111.94
6	50+91.35	5.65' Rt.	111.21	111.88
7	51+36.04	5.65' Rt.	111.35	112.02
8	51+38.21	1.74' Lt.	111.44	112.09
9	51+39.48	8.50' Lt.	111.31	112.00
10	51+39.48	5.00' Lt.		Radius Point
11	51+42.90	0.00' Rt.	111.49	112.18
12	51+92.68	8.50' Rt.	111.16	111.85
13	52+22.04	8.50' Rt.	110.93	111.62
14	52+56.72	0.00' Rt.	110.99	111.68
15	52+58.51	8.50' Lt.	110.83	111.52
16	52+58.51	5.00' Lt.		Radius Point
17	52+60.30	1.99' Lt.	110.95	111.60
18	52+61.89	5.93' Lt.	110.88	111.55

- Notes;
1. Replace detector loop, junction Box, conduit, wiring, and appurtenances in like kind. A continuous run of 2/c #14 shall be provided from junction box to McLean signal controller. Notify Jim Parks, Signal Supervisor, 268-4033, 48 hours prior to disconnecting from circuits and when reconnecting.
 2. Remove and Install Sidewalk 3' Min. beyond Right-of-Way to match existing.
 3. See Pavement Marking and Signing Detail.

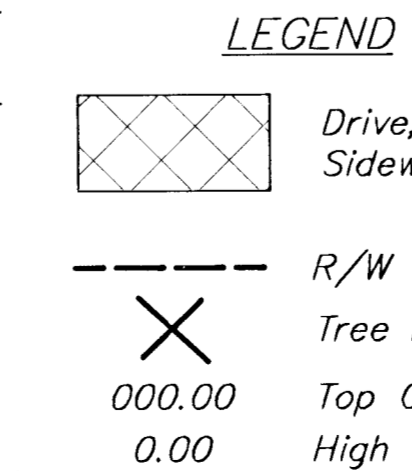

Sta. 52+38.96 Seneca, Const. Std. Manhole (Type P), 25.00' Rt. Dia.=6'-0" Manhole Top=110.45 Install 36" x 151.99' Storm Swr. (RCP)(N)

Sta. 52+40.34 Seneca, Const. Curb Inlet (Type II, 32.18' Rt. L=6'-2-1/2", W=3'-4-3/8" Inlet Top=110.69 Install 15" x 7.18' Storm Swr. (RCP)(W)

Sta. 53+90.94 Seneca, Exist. Reinf. Conc. Manhole, 22.82' Rt. L=6'-2", W=6'-2" Exist. Manhole Top=110.99 Prop. Manhole Top=110.99 Connect 36" RCP (S) to Exist. 36" RCP Stub at Manhole

SENECA STREET
PROJECT NAME

PAVING PLANS
SHEET TITLE

DCH, ASH
DESIGN BY:

HNJ
DRAWN BY:

GJA
CHECKED BY:

OCT. 2001
DATE

98092_E6
DRAWING NAME

14 / 87
SHEET/OF