

BILL OF MATERIALS (FOR INFORMATION ONLY)		
ITEM	UNIT	QUANTITY
JUNCTION BOX - 24 IN. DIA.	EACH	2
CONDUIT CLAMP	EACH	AS REQUIRED
DETECTOR LOOP WIRE NO. 14, AWG 1/c (TYPE THHN)	LIN. FT.	400
SHIELDED DETECTOR LEAD-IN NO. 14 AWG 2/C	LIN. FT.	700
CONDUIT 3/4"	LIN. FT.	170

GENERAL NOTES

- Conduit shall be jacked or bored if not installed before placing of new pavement.
- Placement of Junction Boxes and conduit runs are typical and may be adjusted as directed by the Engineer to facilitate installation.
- The Contractor shall contact all utility companies which may be affected by the installation of Traffic Signalization prior to any construction.
- Install continuous runs of 2/c #14 in existing RGC to Maple St. Signal Controller.
- Replace detector loop, junction box, conduit, wiring and appurtenances in like kind.
- Notify Jim Parks, Signal Supervisor, 268-4033, 48 hours prior to disconnecting from circuits and when reconnecting.

LEGEND

- Junction Box
- Vehicle Detector Loop
- Detector Number
- Rigid Galvanized Conduit (RGC)

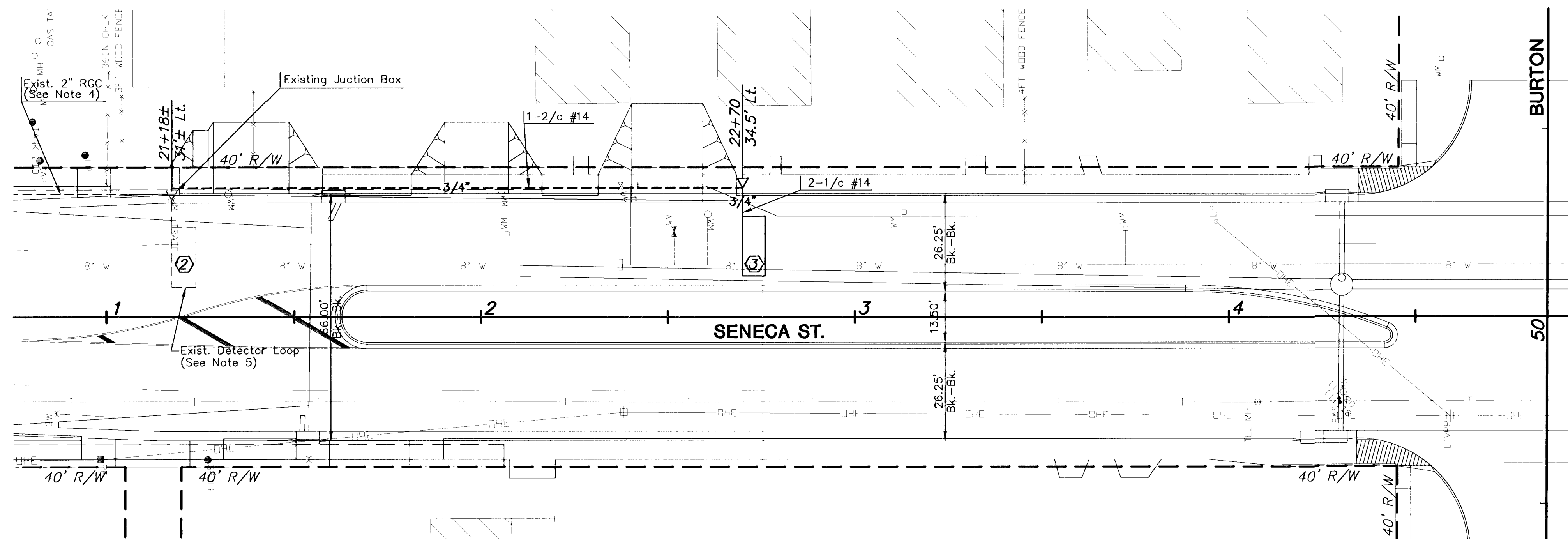
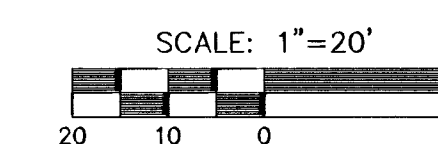
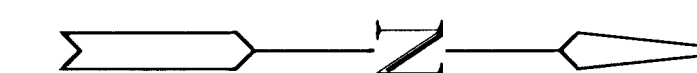

RECAPITULATION OF TRAFFIC SIGNAL QUANTITIES		
BID ITEM	QUANTITY	UNIT
VEHICLE DETECTOR LOOP (SENECA & MAPLE)	2	LUMP SUM

DETECTORS			
LOOP NO.	SIZES (W x L)	NO. OF TURNS	MOVEMENT CALLED
2	16' x 6'	4	
3	16' x 6'	4	

SENECA STREET
PROJECT NAME

SENECA/MAPLE SIGNALIZATION
SHEET TITLE

MID-KANSAS ENGINEERING CONSULTANTS, INC.
411 N. WEBB ROAD
WICHITA, KS. 67206
316-684-9600

DESIGN BY: WNJ DRAWN BY: _____
OCT. 2001 98092SG4 52 / 87
DATE JOB NO. SHEET / OF

DCH DCH
CHECKED BY: _____
CHECKED BY: _____

G:\CIVIL\98092\SIG\98092SG4.dwg Mid Oct 24 17:06:11 2001

G:\CIVIL\98092\SIG\98092SG4.dwg