

SENECA ST. STA. 21+50 TO STA. 32+50

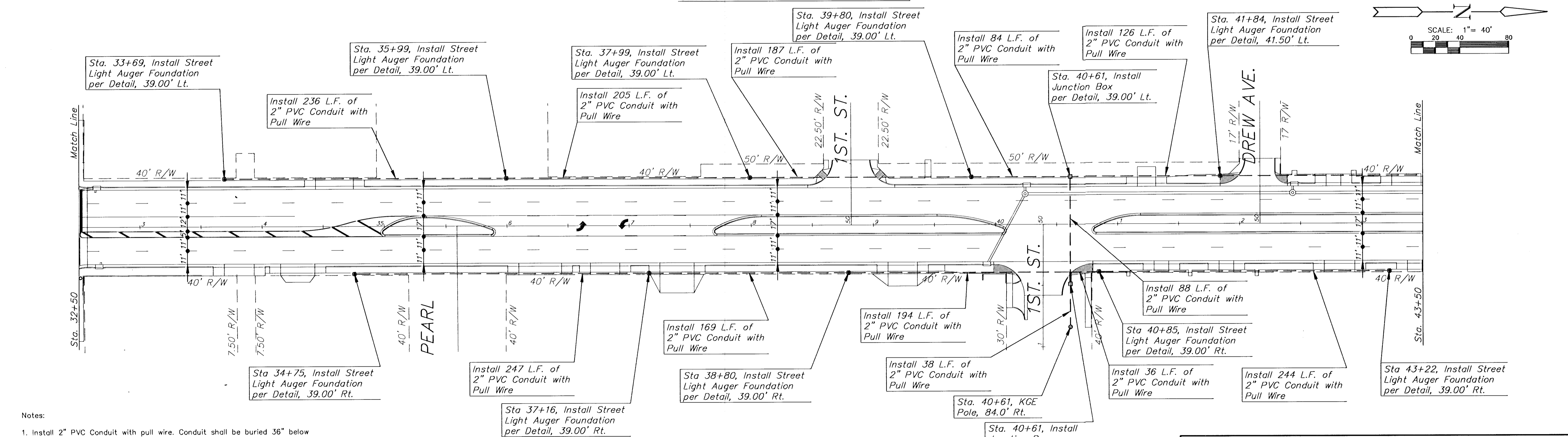

SENECA ST. STA. 32+50 TO STA. 43+50

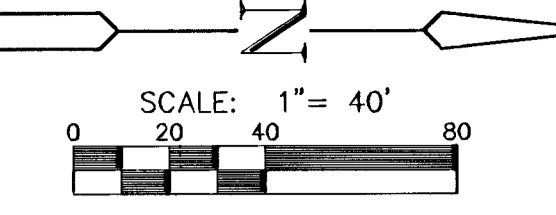
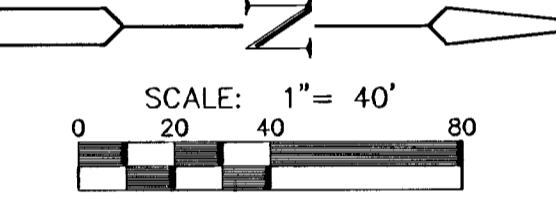

Notes:

1. Install 2" PVC Conduit with pull wire. Conduit shall be buried 36" below finish grade.
2. Terminate conduit at KGE poles with 24" sweep elbow and vertical stub extended above grade. Coordinate with KGE.
3. At Douglas intersection, terminate conduit at KGE manholes. Coordinate with KGE.
4. Junction boxes shall be installed per standard detail on traffic signalization sheets. Cover lettering shall be "KGE".
5. Install Auger Foundation for light poles per detail and manufacturer's instructions. Terminate conduit inside foundation at top of base plate.
6. Pole locations may be moved up to 10' from plan location to avoid conflict with other improvements, as approved by the Engineer. Relocation of more than 10', will require KGE concurrence.

MID-KANSAS ENGINEERING
CONSULTANTS, INC.
411 N. WEBB ROAD
WICHITA, KS. 67206
316-684-9600

SENECA STREET PROJECT NAME		
STREET LIGHTING PLAN SHEET TITLE		
DCH DESIGN BY:	WNJ DRAWN BY:	DCH CHECKED BY:
OCT. 2001 DATE	98092SL1 JOB NO.	61, 87 SHEET NO.

G:\MKT\198092\LIGHTING\98092SL1.dwg Thu Oct 25 14:16:18 2001