

FHWA REGION NO.	STATE	PROJECT NUMBER	FISCAL YEAR	SHEET NUMBER	TOTAL SHEETS
7	KANSAS	87N-0080-01	1997	5	162

DATE	
BY	
REFERENCES NOTED	
REFERENCES CHECKED	

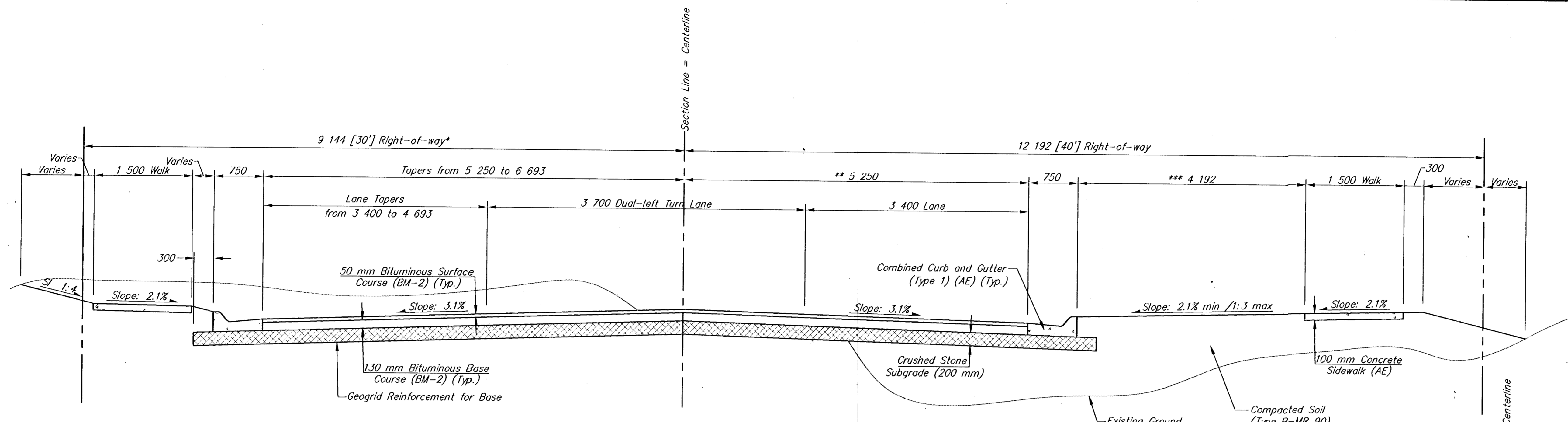

IN CUT

* 12.192 [40'] from Station 1+452.455 to 1+460.216
 ** Tapers from 5.250 at Station 1+408.772 to 7.042 at Station 1+436.236
 *** 2.418 from Station 1+431.734 to 1+460.216

**TYPICAL SECTION
 MERIDIAN - STATION 1+400.668 TO 1+460.216**

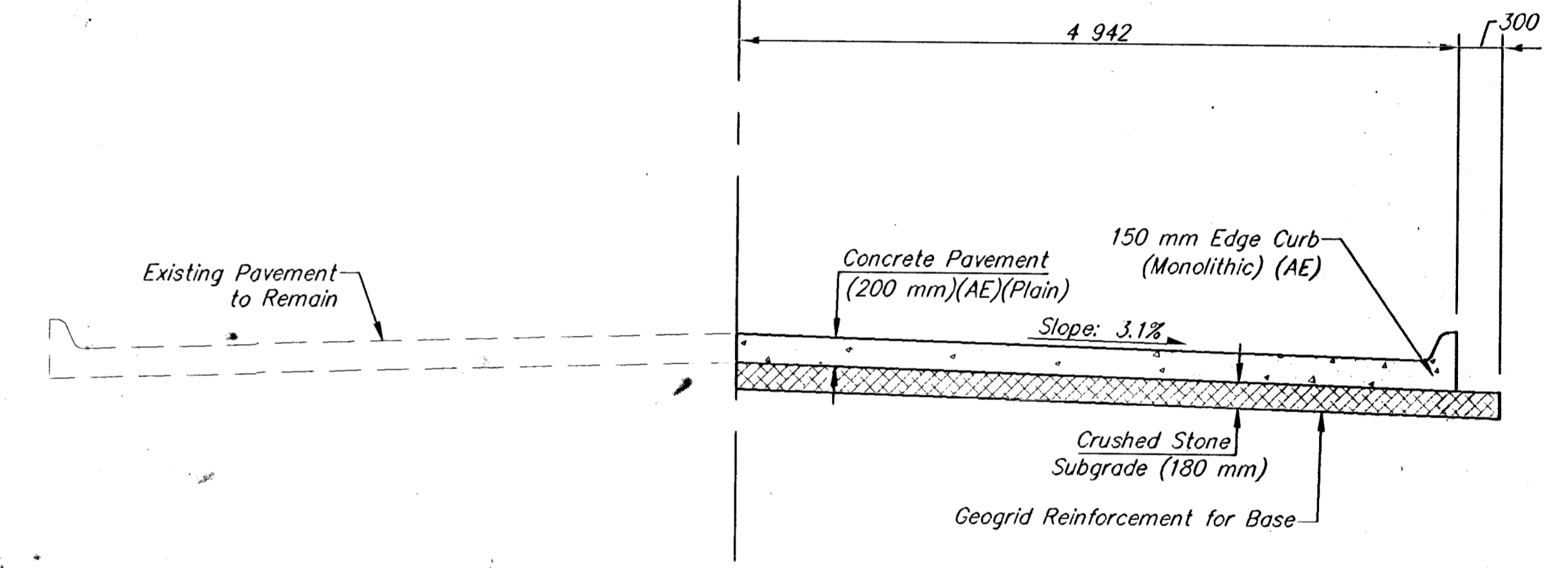

**TYPICAL SECTION
 MERIDIAN - STATION 1+527.611 TO 1+590.810**

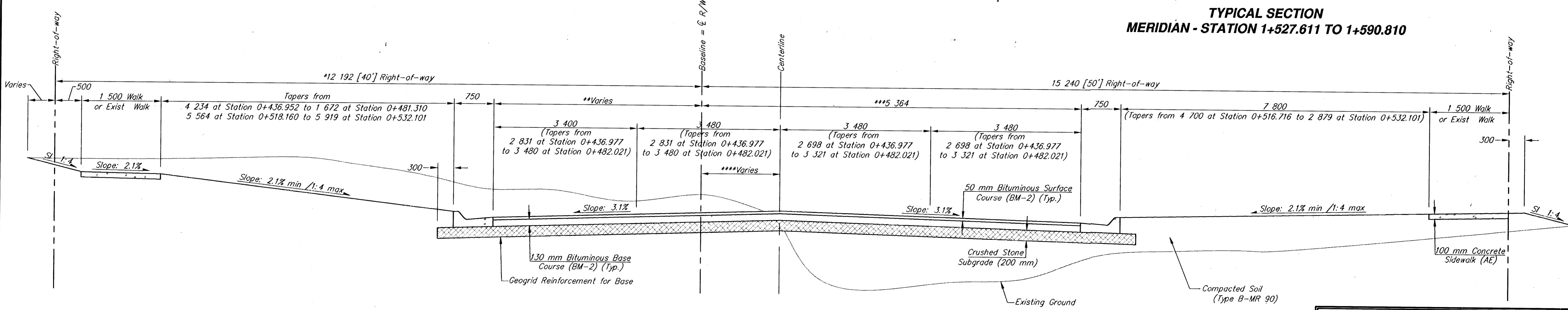

IN CUT

* 15.240 [50'] from Station 0+514.019 to Station 0+532.101
 ** Tapers from 5.673 at Station 0+436.952 to 8.383 at Station 0+484.067
 Tapers from 5.935 at Station 0+518.160 to 6.973 at Station 0+532.101
 *** Tapers from 8.218 at Station 0+516.716 to 7.073 at Station 0+532.101
 **** Tapers from 0 mm at Station 0+436.977 to 2.664 at Station 0+500 (ℓ is Left of Baseline)
 Tapers from 2.389 at Station 0+500 to 0 mm at Station 0+532.101 (ℓ is Right of Baseline)

**TYPICAL SECTION
 DOUGLAS - STATION 0+436.977 TO 0+484.067
 DOUGLAS - STATION 0+518.160 TO 0+532.101**

**MERIDIAN IMPROVEMENTS
 TYPICAL SECTIONS**

SRB 924 NORTH MAIN WICHITA, KANSAS 67203 316-284-8008
 SAVOY, RUGGLES & BOHM, P. A. ENGINEERING & SURVEYING
 PROJECT NUMBER: 472-76-245-82740-000-000-001
 DATE: Feb. 24, 1998

DESIGNER: J. Long/TEE
 CHECKER: T.C.R.
 REVIEWER: SCR
 DATE: Feb. 24, 1998
 SHEET NO.: 539T

Sheet 5 of 5
 Total Sheets 162