

FHWA REGION NO.	STATE	PROJECT NUMBER	FISCAL YEAR	SHEET NUMBER	TOTAL SHEETS
7	KANSAS	87N-0080-01	1997	23	162

STATION 1+246.817 LT., CONSTRUCT INLET (TYPE II) (CURB).
INSTALL 450 mm x 1.944 m STORM SEWER (RCP) (E.).
SEE SHEETS 31, 62

STATION 1+322.447 LT., CONSTRUCT INLET (TYPE II) (CURB).
SEE SHEETS 34, 61

STATION 1+246.817, 2 744 LT., CONSTRUCT MANHOLE (TYPE P) (1.525 m DIA.).
INSTALL 450 mm x 17.942 m STORM SEWER (RCP) (E.).
INSTALL 900 mm x 73.878 m STORM SEWER (RCP) (N.).
SEE SHEETS 24, 37, 66

STATION 1+322.220, 2 744 LT., CONSTRUCT MANHOLE (TYPE P) (1.525m DIA.).
INSTALL 1.955m 375mm STORM SEWER (RCP) (W.).
INSTALL 30.191m 900mm STORM SEWER (RCP) (N.).
SEE SHEETS 24, 34, 66

STATION 1+183.846, 2 734 LT., BEGIN 1350 mm x 35.000 m STEEL CASING.
INSTALL BY BORING AND JACKING.

BY	DATE

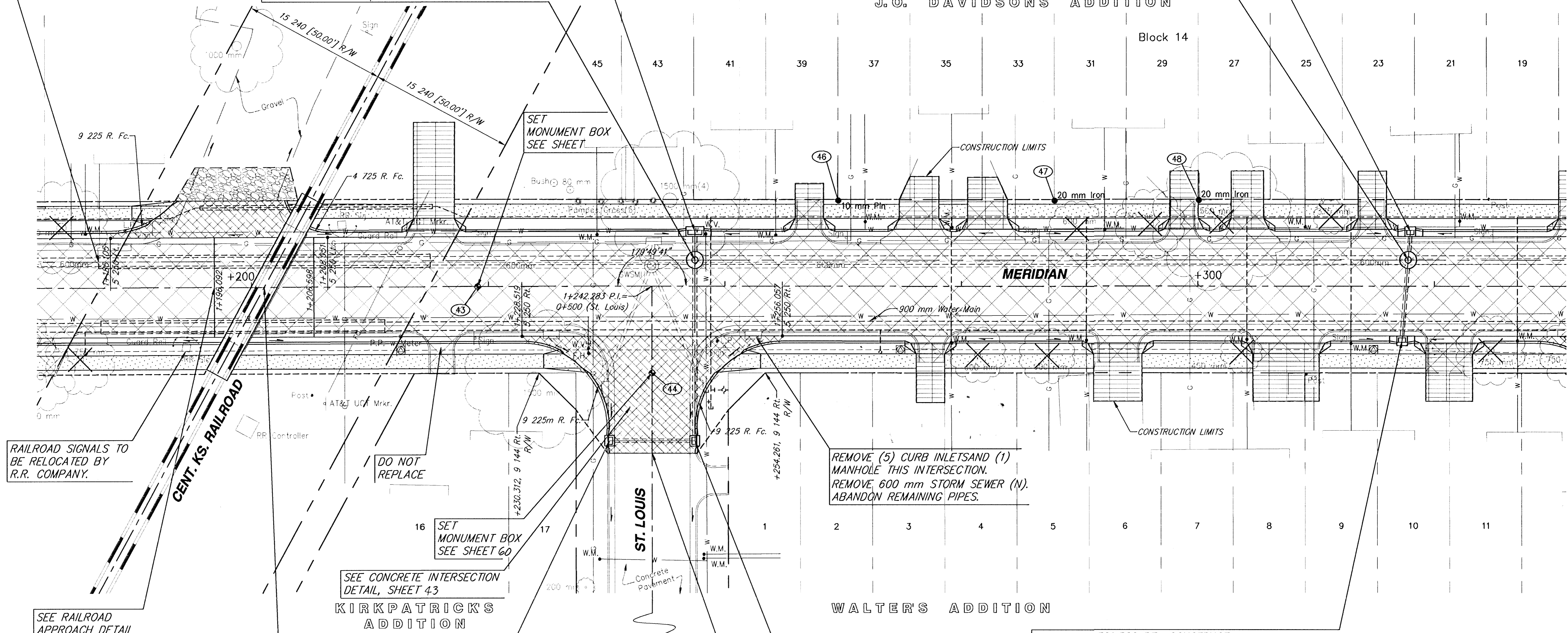

RAILROAD SIGNALS TO BE RELOCATED BY R.R. COMPANY.

DO NOT REPLACE

REMOVE (5) CURB INLETS AND (1) MANHOLE THIS INTERSECTION.
REMOVE 600 mm STORM SEWER (N).
ABANDON REMAINING PIPES.

EXCEPTION FOR RAILROAD, STATION 1+199.946 TO 1+202.735 = 2.789 m

STATION 0+516.311 RT. (ST. LOUIS), CONSTRUCT INLET (TYPE II) (CURB).
SEE SHEETS 37, 61

STATION 0+517.635 (ST. LOUIS), SAW EXISTING PAVEMENT TO NEAT LINE AND MATCH.

STATION 1+321.580 RT., CONSTRUCT INLET (TYPE II) (CURB).
INSTALL 375 mm x 7.458 m STORM SEWER (RCP) (W.).
SEE SHEETS 34, 61

BM #8 "□" CUT IN TOP OF CURB AT 30 m± EAST OF CENTERLINE OF MERIDIAN AND SOUTH SIDE OF ST. LOUIS.
ELEV. 397.031

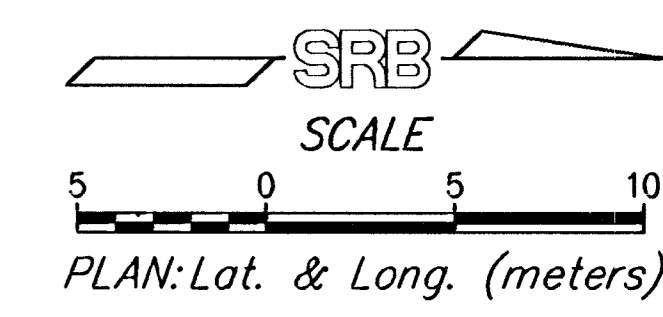

MERIDIAN STATION 1+180 TO STATION 1+335			
SRB	924 NORTH MAIN WICHITA, KANSAS 67203 http://www.srb.com	316-264-8008 FAX 264-4821 E-Mail: srb@srbc.com	REVISED
SAVOY, RUGGLES & BOHM, P.A. ENGINEERING & SURVEYING			
472-76-245-82740-000-001			
DRAWN U. Long/TEB	DESIGN T.C.R.	DATE Jan. 8, 1999	UTILITY SRB JOB 539T
SHEET NUMBER 23			TOTAL SHEETS 162