

FHWA REGION NO.	STATE	PROJECT NUMBER	FISCAL YEAR	SHEET NUMBER	TOTAL SHEETS
7	KANSAS	87N-0080-01	1997	27	162

CONSTRUCT 1 500 SIDEWALK (AE)
(100 mm) BETWEEN EXISTING
DRIVE APPROACHES (8 LOCATIONS).

STATION 1+505.000, 2 744 LT., CONSTRUCT
MANHOLE (TYPE P) (1.525 m DIA.).
INSTALL 900 mm x 19.563 m STORM SEWER (RCP) (N.E.).
SEE SHEETS 28, 66

REMOVE EXISTING ISLAND AND
RE-CONSTRUCT WITH CONCRETE
MONOLITHIC EDGE CURB (200 mm)
SEE SHEETS 6, 56

PROPOSED CURB
(PROJ. 87-STP-N-0094-01)

STATION 1+590.810, END PROJECT
MATCH PAVEMENT AT EXISTING JOINT
(PROJ. 87-STP-N-0094-01).

SEE CONCRETE INTERSECTION
DETAILS, SHEETS 45, 6

STATION 1+525.000, 3 941 RT., CONSTRUCT
MANHOLE (TYPE P) (1.525 m DIA.). INSTALL
900 mm x 62.712 m STORM SEWER (RCP) (N.).
SEE SHEETS 28, 66

STATION 1+527.611, END VALLEY
GUTTER PAVEMENT. BEGIN
CONCRETE PAVEMENT (RT. ONLY)

DATE	
BY	
REFERENCES NOTED	
REFERENCES CHECKED	

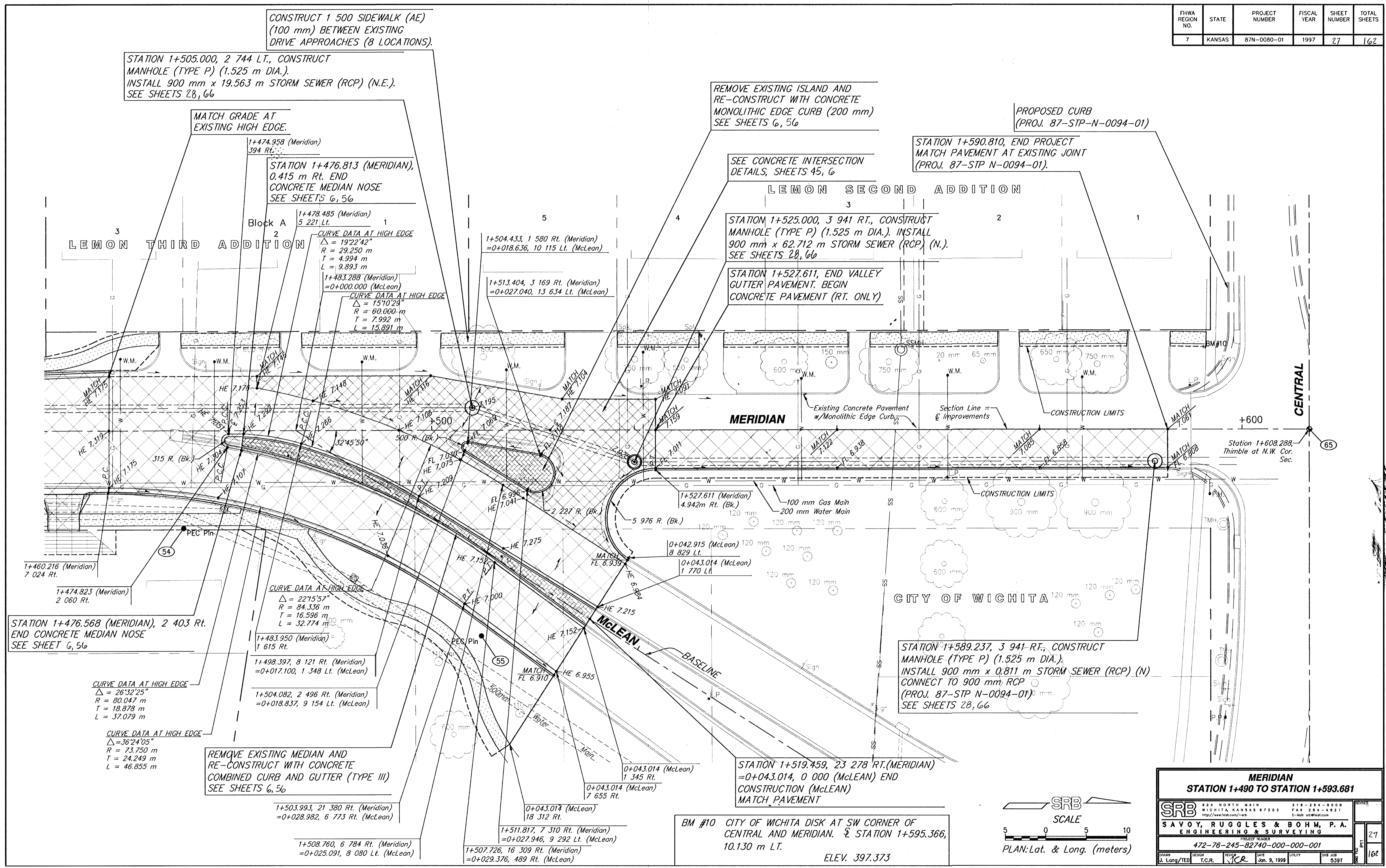

STATION 1+476.568 (MERIDIAN), 2 403 RT.
END CONCRETE MEDIAN NOSE
SEE SHEET 6, 56

CURVE DATA AT HIGH EDGE
 $\Delta = 26^{\circ}32'25''$
 $R = 80.047$ m
 $T = 18.878$ m
 $L = 37.079$ m

CURVE DATA AT HIGH EDGE
 $\Delta = 36^{\circ}24'05''$
 $R = 73.750$ m
 $T = 24.249$ m
 $L = 46.855$ m

REMOVE EXISTING MEDIAN AND
RE-CONSTRUCT WITH CONCRETE
COMBINED CURB AND GUTTER (TYPE III)
SEE SHEETS 6, 56

1+503.993, 21 380 Rt. (Meridian)
=0+028.982, 6 773 Rt. (McLean)

1+508.760, 6 784 Rt. (Meridian)
=0+025.091, 8 080 Lt. (McLean)

1+511.817, 7 310 Rt. (Meridian)
=0+027.946, 9 292 Lt. (McLean)

1+507.726, 16 309 Rt. (Meridian)
=0+029.376, 489 Rt. (McLean)

0+043.014 (McLean)
13 312 Rt.

0+043.014 (McLean)
7 655 Rt.

0+043.014 (McLean)
1 345 Rt.

STATION 1+519.459, 23 278 RT.(MERIDIAN)
=0+043.014, 0 000 (McLEAN) END
CONSTRUCTION (McLEAN)
MATCH PAVEMENT

BM #10 CITY OF WICHITA DISK AT SW CORNER OF
CENTRAL AND MERIDIAN. \pm STATION 1+595.366,
10.130 m LT.
ELEV. 397.373

STATION 1+589.237, 3 941 RT., CONSTRUCT
MANHOLE (TYPE P) (1.525 m DIA.).
INSTALL 900 mm x 0.811 m STORM SEWER (RCP) (N)
CONNECT TO 900 mm RCP
(PROJ. 87-STP-N-0094-01)
SEE SHEETS 28, 66

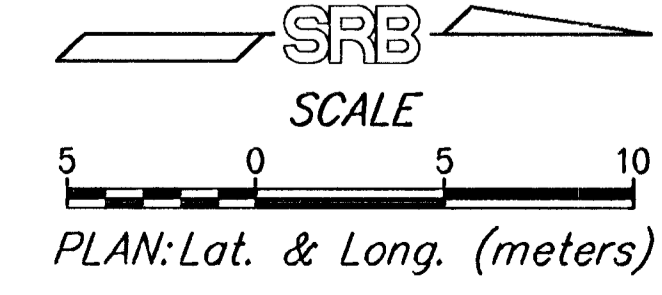

MERIDIAN	
STATION 1+490 TO STATION 1+593.681	
824 NORTH MAIN WICHITA, KANSAS 67203 316-254-8008 http://www.srb.com/~srb FAX 264-4821 E-Mail: srb@srbs.com	
SAVOY, RUGGLES & BOHM, P.A. ENGINEERING & SURVEYING	
PROJECT NUMBER: 472-76-245-82740-000-000-001	
DRAWN J. Long/T.E.C.	DESIGN T.C.R.
DATE Jan. 9, 1999	UTILITY SRB JOB 5397
27	162