

FHWA REGION NO.	STATE	PROJECT NUMBER	FISCAL YEAR	SHEET NUMBER	TOTAL SHEETS
7	KANSAS	87N-0080-01	1997	29	162

BY	DATE
REFERENCES NOTED	
REFERENCES CHECKED	

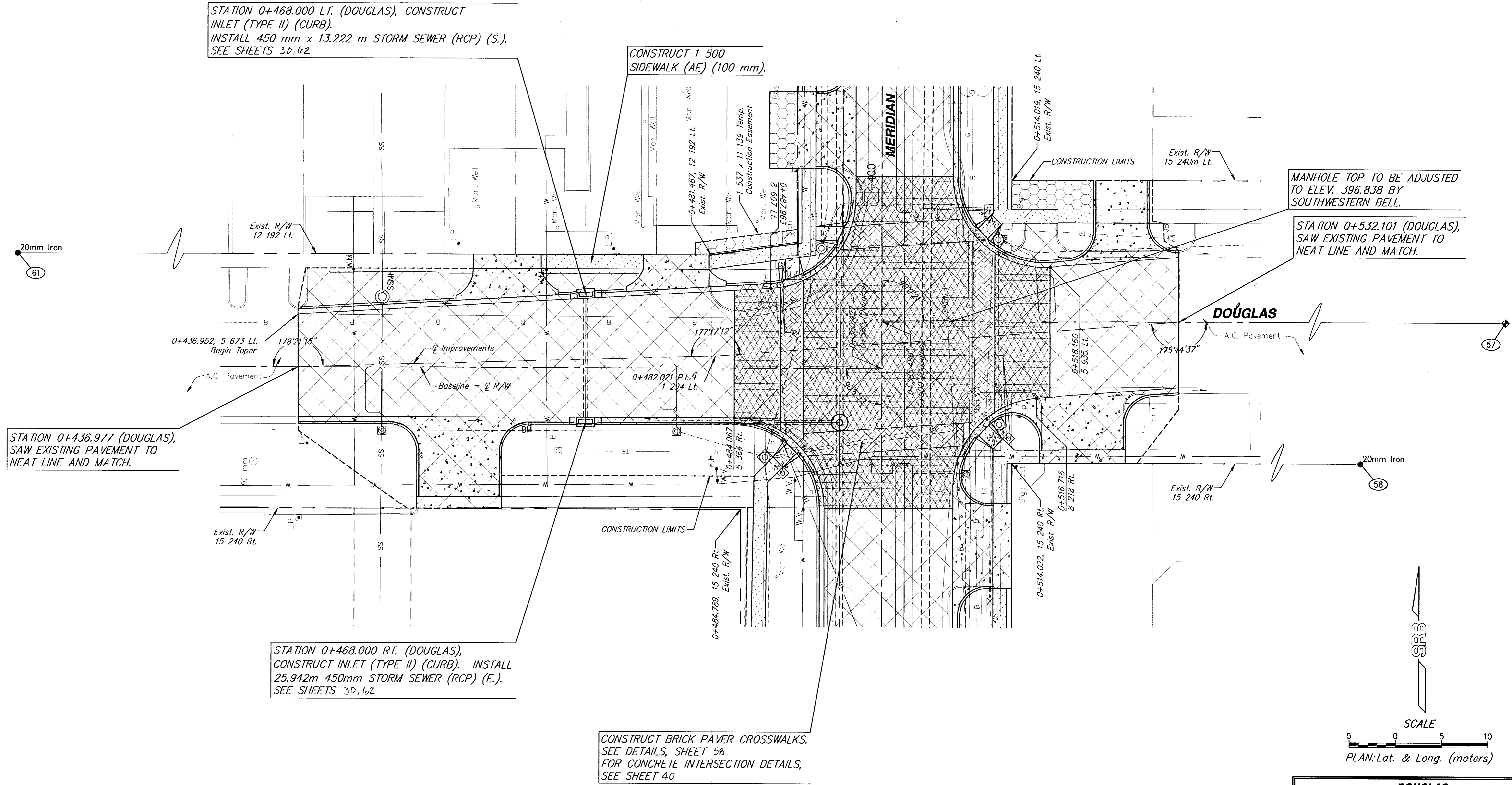

STATION 0+468.000 LT. (DOUGLAS), CONSTRUCT INLET (TYPE II) (CURB). INSTALL 450 mm x 13.222 m STORM SEWER (RCP) (S.). SEE SHEETS 30, 42

CONSTRUCT 1 500 SIDEWALK (AE) (100 mm).

MANHOLE TOP TO BE ADJUSTED TO ELEV. 396.838 BY SOUTHWESTERN BELL.

STATION 0+532.101 (DOUGLAS), SAW EXISTING PAVEMENT TO NEAT LINE AND MATCH.

STATION 0+436.977 (DOUGLAS), SAW EXISTING PAVEMENT TO NEAT LINE AND MATCH.

STATION 0+468.000 RT. (DOUGLAS), CONSTRUCT INLET (TYPE II) (CURB). INSTALL 25.942m 450mm STORM SEWER (RCP) (E.). SEE SHEETS 30, 62

CONSTRUCT BRICK PAVER CROSSWALKS. SEE DETAILS, SHEET 58 FOR CONCRETE INTERSECTION DETAILS, SEE SHEET 40

BM #3 "□" CUT ON TOP OF CURB AT EAST RETURN OF NORTH ENTRANCE TO DILLONS AT DOUGLAS & MERIDIAN ELEV. 396.842

DOUGLAS
STATION 0+436.977 TO STATION 0+532.101

SRB 924 NORTH MAIN WICHITA, KANSAS 67203 316-284-3008 FAX 284-4821 http://www.srb.com/~srb

SAVOY, RUGGLES & BOHM, P.A.
ENGINEERING & SURVEYING

PROJECT NUMBER: 472-76-245-82740-000-000-001

DATE: Jan. 8, 1999

DESIGN: J. Long/TEB T.C.R.

REVISION: [Signature]

UTILITY: [Signature]

SRB JOB: 5397

REVISION: [Signature]

DATE: Feb. 17, 1999

29

162