

- QUANTITIES:**
- PIPE:
 - 8" C900 PVC - 884.6'
 - 8" DICL - 15.4'
 - VALVES:
 - 8" - 1
 - HYDRANT:
 - RELOCATED - 1
 - SERVICES:
 - LONG - 1
 - SHORT - 4

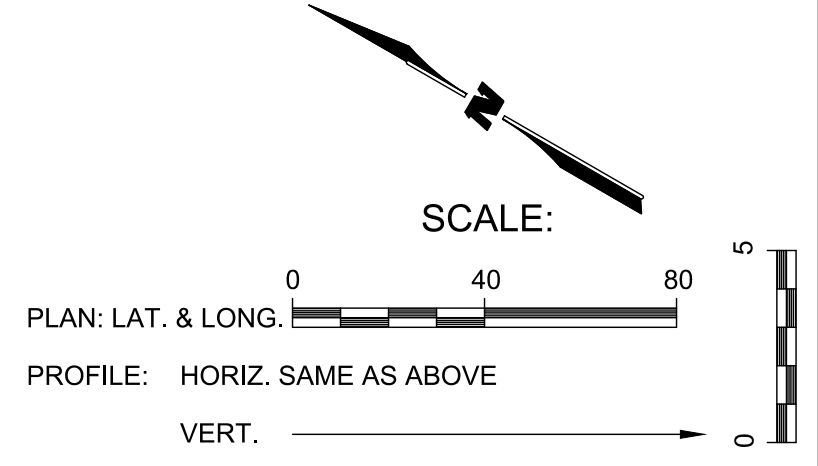

WATERLINE 3S

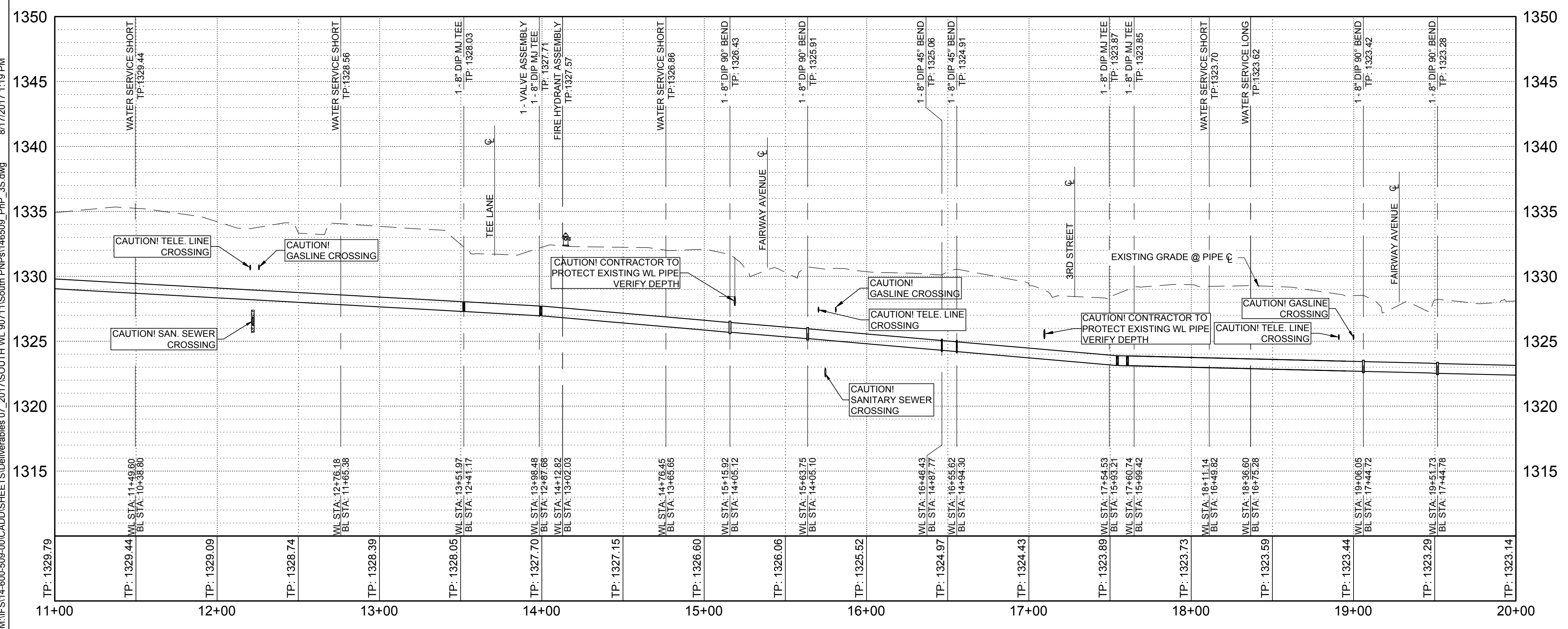

M:\PFS\14-600-509-00\CADD\SSHEETS\Deliverables 07_2017\SOUTH WL 90711\SOUTH PNP\146509_PnP_3S.dwg 8/7/2017 1:19 PM

WICHITA COUNTRY ACRES
 WATER MAIN REPLACEMENT PHASE 2B
 WATERLINE 3S PLAN & PROFILE
 CITY OF WICHITA PROJECT NO. 448-90711

1700 EAST IRON AVE
 SALINA, KS 67401
 PHONE: 785-827-0833
 FAX: 785-827-0836
 WWW.WILSON-AND-COMPANY.COM

Designed By: BPS
 Drawn By: DCK
 Job No.: 14-600-509-00
 Date: FEBRUARY 2016

