

**GENERAL NOTES**

1. THE CONTRACTOR SHALL SCHEDULE CONSTRUCTION ACTIVITIES SO AS TO LIMIT WATER SERVICE DOWN TIME TO RESIDENCES. WHEREVER POSSIBLE, THE PROPOSED WATER DISTRIBUTION SYSTEM SHALL BE IN PLACE AND ACTIVE ALONGSIDE THE EXISTING SYSTEM WHILE NEW SERVICE LINES ARE INSTALLED TO THE PROPOSED MAINS. ALL PROPOSED SERVICES SHALL BE CONNECTED TO THE PROPOSED MAINS PRIOR TO DISCONNECTING EXISTING WATER MAINS. THE CONTRACTOR WILL BE RESPONSIBLE FOR PROVIDING A COPY OF HIS CONSTRUCTION SCHEDULE TO THE PROJECT ENGINEER AND THE CITY OF EASTBOROUGH, KANSAS FOR APPROVAL PRIOR TO CONSTRUCTION START.
2. CONTRACTOR TO VERIFY LOCATION AND ELEVATION OF EXISTING UTILITIES PRIOR TO CONSTRUCTION START.
3. EXISTING WATER LINE DISCONNECTS SHALL BE SCHEDULED AND EXECUTED IN A MANNER THAT MINIMIZES WATER SERVICE DOWN TIME AND DISRUPTION TO TRAFFIC FLOW IN ALL AREAS.
4. THE "ABANDON EXISTING SYSTEM" BID ITEM WILL COVER ALL COSTS FOR TAKING THE EXISTING WATER MAINS OUT OF SERVICE WITH THIS PROJECT. THIS INCLUDES CUTTING AND CAPPING OF EXISTING LINES, VALVE REMOVAL, METER CANS ETC. CALLED OUT IN THE PLANS FOR MAINS AND LINES CONNECTED TO MAINS.
5. WHEN WORKING IN AREAS SURROUNDING EXISTING TREES, THE CONTRACTOR SHALL PROCEED WITH CAUTION AVOIDING DAMAGE TO ROOT STRUCTURES OR LOW-LYING BRANCHES. IT WILL BE THE RESPONSIBILITY OF THE CONTRACTOR TO ADDRESS ANY DAMAGES TO EXISTING TREES PRIOR TO END OF CONSTRUCTION ACTIVITIES ON SITE.
6. IN AREAS WHERE CURB AND GUTTER IS REMOVED OR EXCAVATION TAKES PLACE WITHIN TEN FEET OF THE BACK OF EXISTING CURB, BACK OF CURB PROTECTION SHALL BE REQUIRED.
7. ADDITIONAL PAVEMENT AND OR CURB REMOVAL MAY BE REQUIRED AND SHALL BE SUBSIDIARY TO PROJECT.

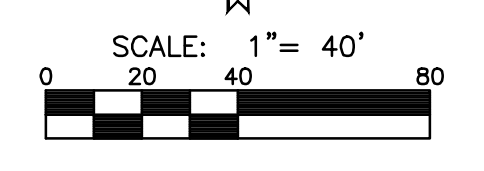
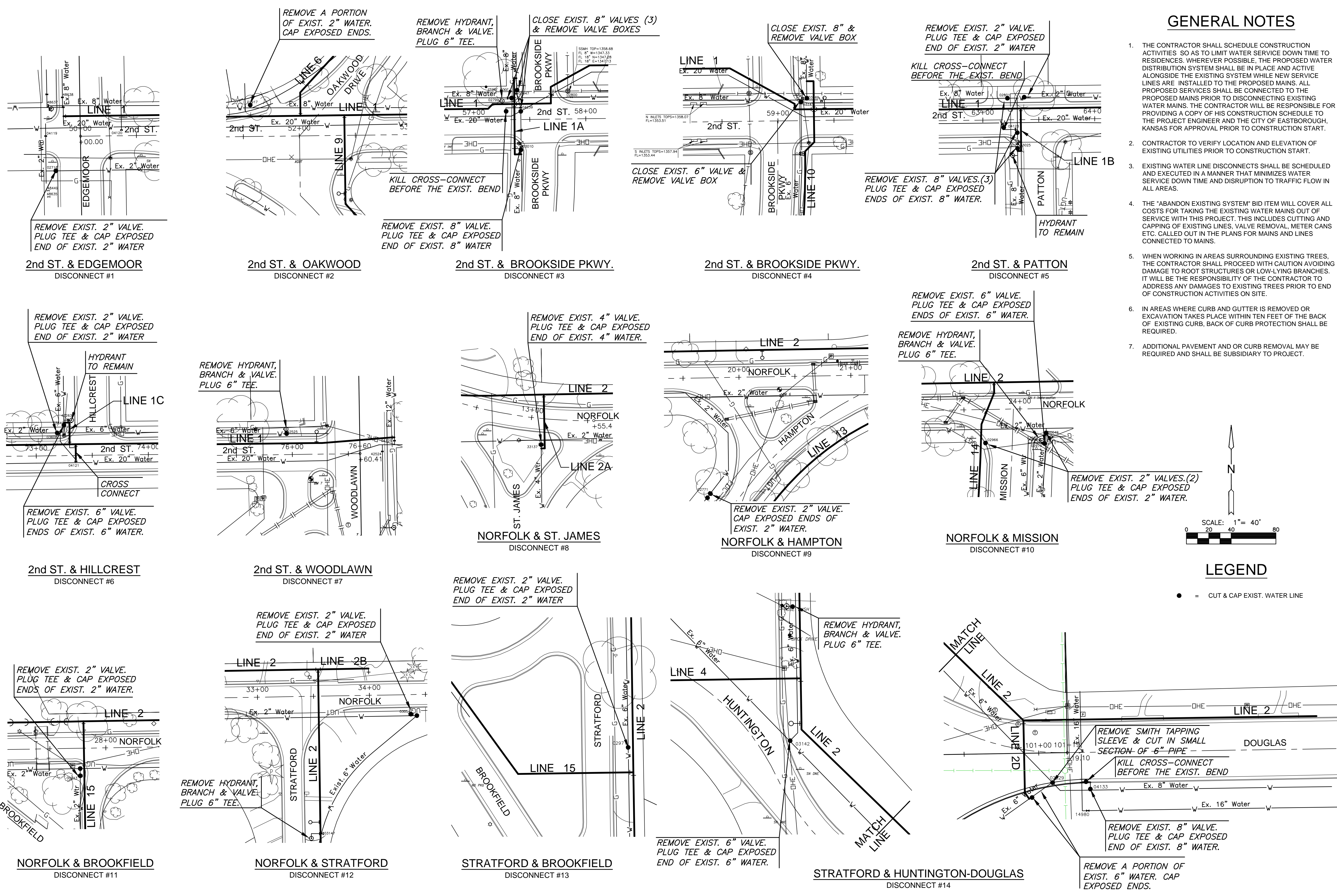

**LEGEND**

● = CUT & CAP EXIST. WATER LINE



©2013 MKEC Engineering All Rights Reserved  
www.mkec.com  
These drawings and their contents, including, but not limited to, all concepts, designs, & ideas are the exclusive property of MKEC Engineering (MKEC), and may not be used or reproduced in any way without the express consent of MKEC.

**DISCONNECT DETAILS 1-14**

PROJECT NO.	448-90610	
DATE	SEPT. 2017	
SCALE	AS SHOWN	
DESIGNED	DRAWN	CHECKED
JTC	DM	JRA
NO.	REVISION	DATE

J:\PROJECTS\2013\1301010713\_C001\_EASTBOROUGH NORTH WATER REPLACEMENT\CIVIL\DWG\TR1313\_C27.DWG