

DOUGLAS AVE.-BNSF
 RAILROAD UNDERPASS
 IMPROVEMENTS
 WICHITA, KS

LKArchitecture



Architecture • Engineering • Planning • Interior Design • Landscape Architecture

Inc. ©
 345 RIVERVIEW, WICHITA, KS 67203
 Phone (316) 268-0230 Fax: (316) 268-0205

CONTACT: -
 PROJECT NUMBER:
17145

SHEET TITLE:
TRAFFIC CONTROL PLAN
PHASE 3
 SHEET NUMBER:

34

LAT: 37.68622°N
 LONG: 97.33001°W

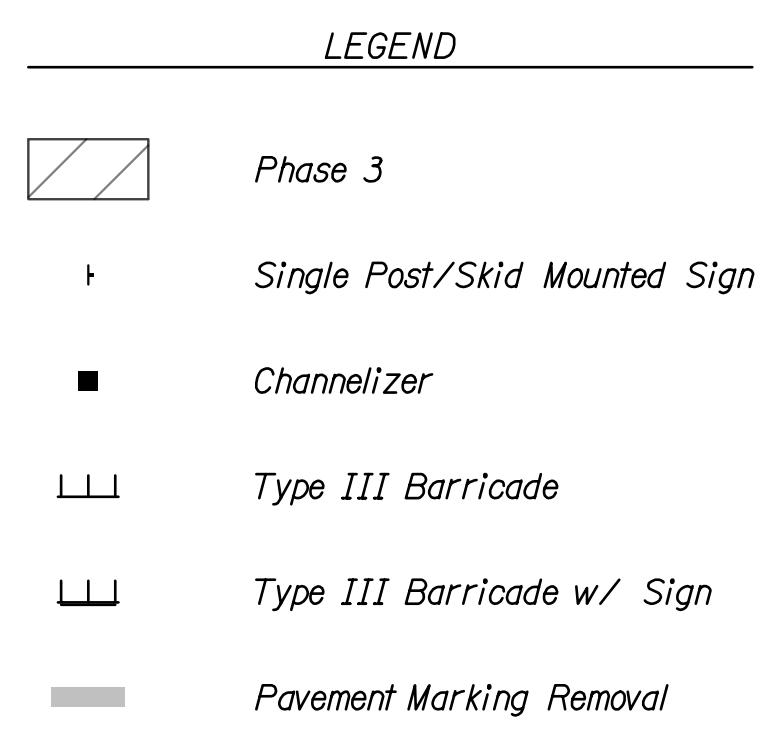
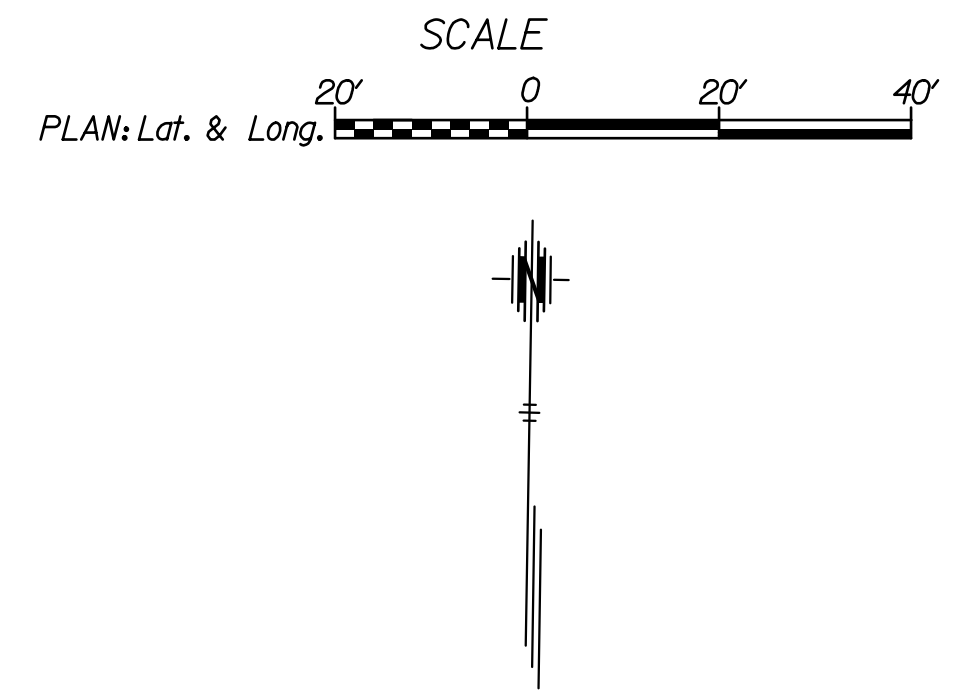

Note:
 Throughout construction the Contractor may have to alter the lane arrangements to complete the removal and construction of the fascia beam. The Contractor shall submit plans to the Engineer for approval prior to changing the lane configurations. During this time, the Contractor shall always maintain one (1) lane traffic in all directions.

Pavement marking removal shall be in accordance with the City of Wichita Standard Specifications. The Contractor shall have the option to either remove the existing pavement marking or mask with an appropriate type of removable table.

If the Contractor decides to remove the existing pavement marking in conflict, the Contractor is responsible for the replacement of the removed markings as needed throughout construction. The Contractor shall restore all pavement markings to reflect the existing conditions after construction is complete. All work and material needed to replace the pavement marking back to existing conditions shall be considered **SUBSIDIARY** to the bid item, "Traffic Control".

The Contractor shall maintain pedestrian access to all businesses throughout the duration of construction. These routes shall be ADA compliant and shall meet the specifications spelled out in the latest edition of, "Proposed Accessibility Guidelines for Pedestrian Facilities in the Public Right-of-Way"

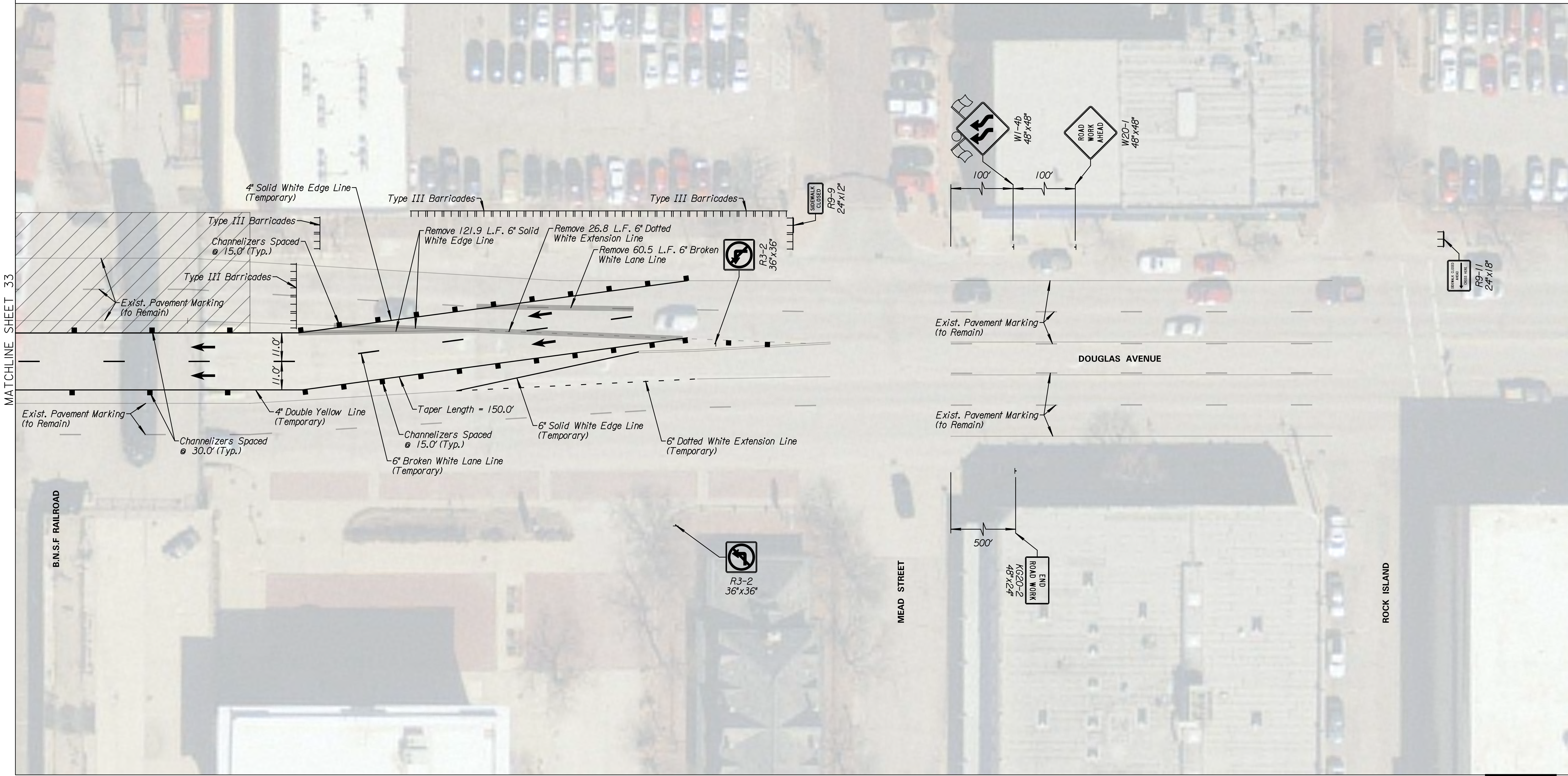

MATCHLINE SHEET 33

B.N.S.F. RAILROAD

MEAD STREET

ROCK ISLAND

