

J:\PROJECTS\2017\1701010587_COW_STRYKER_170567_CADD\SH1505_DVLS\DWG\170567-05-2500.DWG
 PLOTTED: Wednesday, January 10, 2018 @ 08:50AM

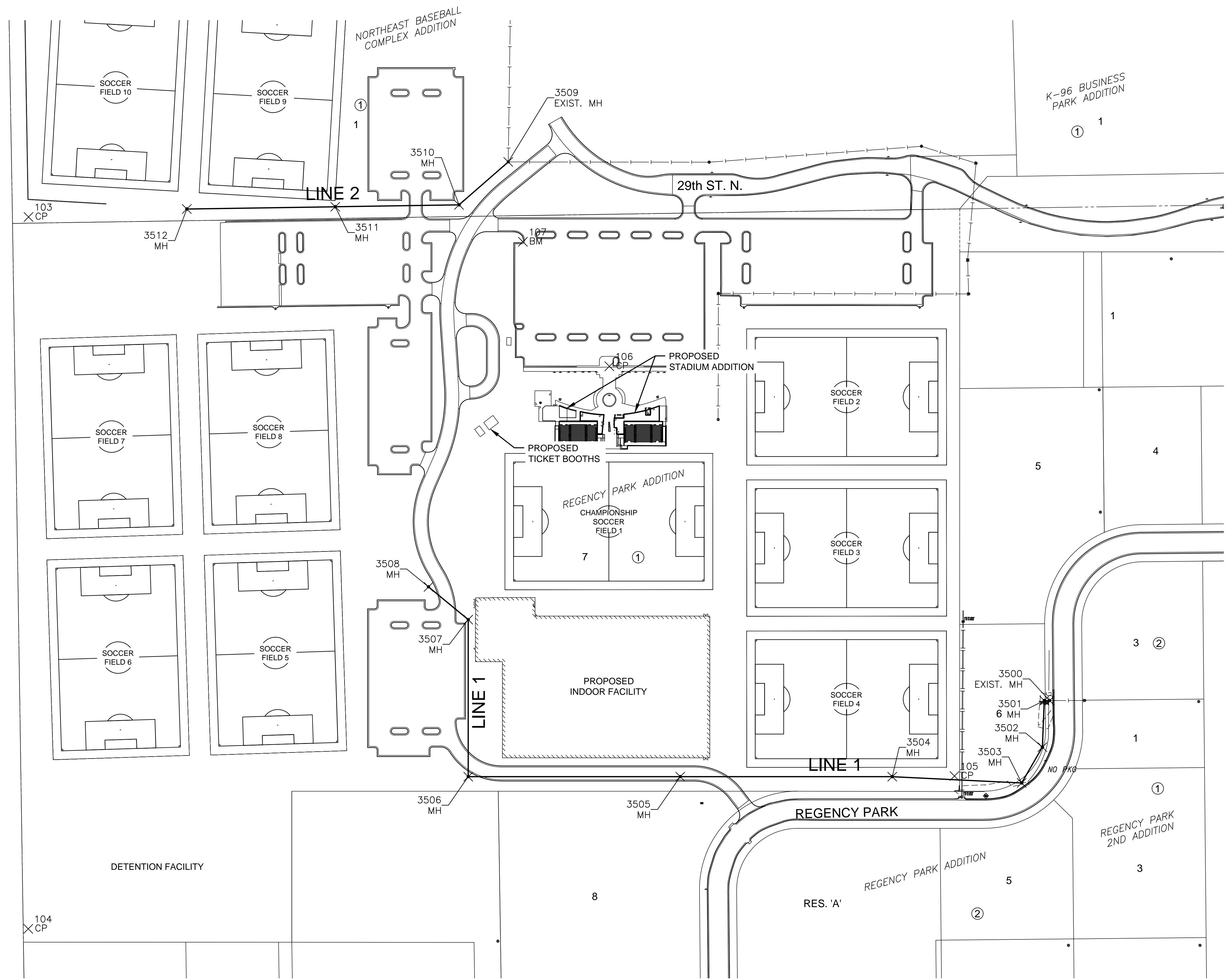

SANITARY POINTS			
Point #	Northing	Easting	Desc.
3500	1704181.43	1685449.13	EXIST. MH
3501	1704181.39	1685439.12	MH
3502	1704093.62	1685435.54	MH
3503	1704026.06	1685396.52	MH
3504	1704037.87	1685152.38	MH
3505	1704037.88	1684752.38	MH
3506	1704037.87	1684352.38	MH
3507	1704334.15	1684352.38	MH
3508	1704395.89	1684277.39	MH
3509	1705197.43	1684427.83	EXIST. MH
3510	1705116.46	1684334.97	MH
3511	1705112.87	1684101.43	MH
3512	1705108.56	1683821.47	MH

CONTROL POINTS			
Point #	Northing	Easting	Desc.
100	1705129.39	1686099.44	CP
101	1706443.67	1686059.90	CP
102	1706375.64	1683490.77	CP
103	1705093.62	1683522.84	CP
104	1703750.96	1683522.34	CP
105	1704039.08	1685269.60	CP
106	1704811.93	1684618.58	CP
107	1705046.74	1684455.47	BM

DATUM:
 1 - The Project Horizontal Datum is based on the NAD83, Kansas State Plane Coordinate System, South Zone, (US Survey Feet Definition), with a Combined Adjustment Factor (CAF) of 1.0001200144. All coordinates and dimensions shown on these plans are modified to Ground values.
 The following equations can be used for conversion:
 Ground Coordinates to State Plane Coordinates = Ground x 1/CAF
 State Plane Coordinates to Ground Coordinates = State Plane x CAF
 2 - The Vertical Datum used is NAVD88.

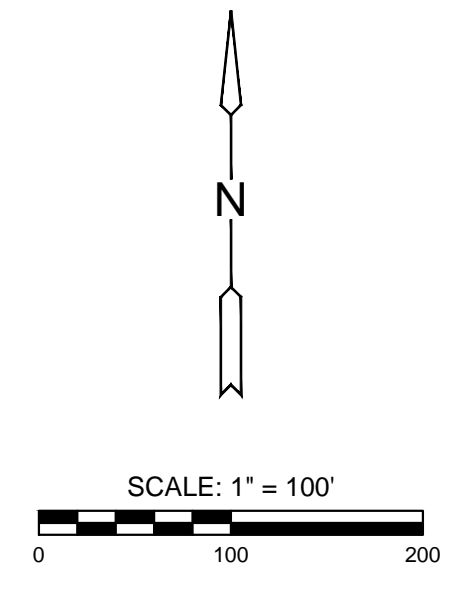

EVERY ATTEMPT HAS BEEN MADE TO INSURE ALL COORDINATE VALUES SHOWN ARE AN ACCURATE AND TRUE REPRESENTATION OF THE CURRENT PLANS. ALL VALUES ARE TO BE CONFIRMED WITH THE FINAL SIGNED PLAN SET BEFORE USE.



GRADING AND UTILITY PLANS FOR
STRYKER SPORTS
 WICHITA, KANSAS



©2018 MKEC Engineering All Rights Reserved www.mkec.com
 These drawings and their contents, including, but not limited to, all concepts, designs, & ideas are the exclusive property of MKEC Engineering (MKEC), and may not be used or reproduced in any way without the express consent of MKEC.

SANITARY BUBBLE MAP

PROJECT NO.	170567	
DATE	01-10-18	
SCALE	1" = 100'	
DESIGNED	MAB	
DRAWN	CRM	
CHECKED	MAB	
ISSUED FOR CONST.	01-10-18	
NO.	REVISION	DATE