

Phase I
 Construct East Bound Lanes From
 Sta. 1+097.002 To Sta. 2+187.295 Rt.

Construct Right Turn Lane Onto
 Tyler From Sta. 2+513.799 To Sta.
 2+613.688 Rt.

Phase III
 Construct East Bound Lanes From
 Sta. 2+187.295 To Sta. 2+324.262 Rt.

Phase Description

Phase II
 Construct West Bound Lanes From
 Sta. 1+092.782 To Sta. 2+187.295 Lt.

Phase IV
 Construct East Bound Lanes From
 Sta. 2+187.295 To Sta. 2+324.262 Rt.

Legend

- Phase I
- Phase II
- Phase III
- Phase IV

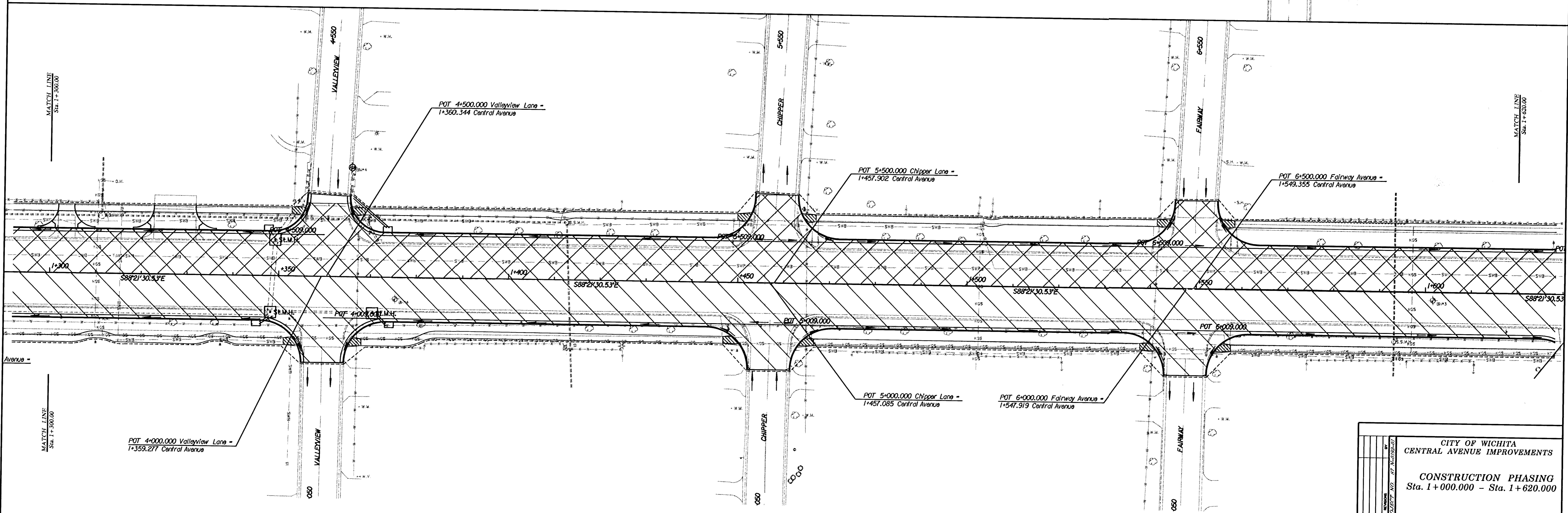

CITY OF WICHITA CENTRAL AVENUE IMPROVEMENTS			
CONSTRUCTION PHASING Sta. 1+000.000 - Sta. 1+620.000			
WICHITA		KANSAS	
DESIGNED B.A.L.	DATE 1/2003	DESIGNED M.P.M.	DATE 1/2003
CHECKED J.R.L.	SCALE 1:100	CHECKED J.R.L.	SCALE 1:100
TRANSSYSTEMS 245 North Wood Suite 400 Wichita, Kansas 67202		SHEET NO. 37	