

**BENCHMARKS:**  
 City of Wichita Benchmark Disk  
 34.9' S. & 31.2' W. of the SW Cor.,  
 NW1/4, Sec. 2, Twp. 27-S, R-1-W.  
 Elev. = 1327.57 NAVD88

"□" cut in top of curb 1.5'  
 north of the northeast corner of  
 Lot 20, Block B, Sandcrest Addn.  
 Elev. = 1327.21 NAVD88

"□" cut in top of east curb  
 inlet at the southeast corner of  
 the southern intersection of Curtis  
 & Sandcrest.  
 Elev. = 1322.05 NAVD88

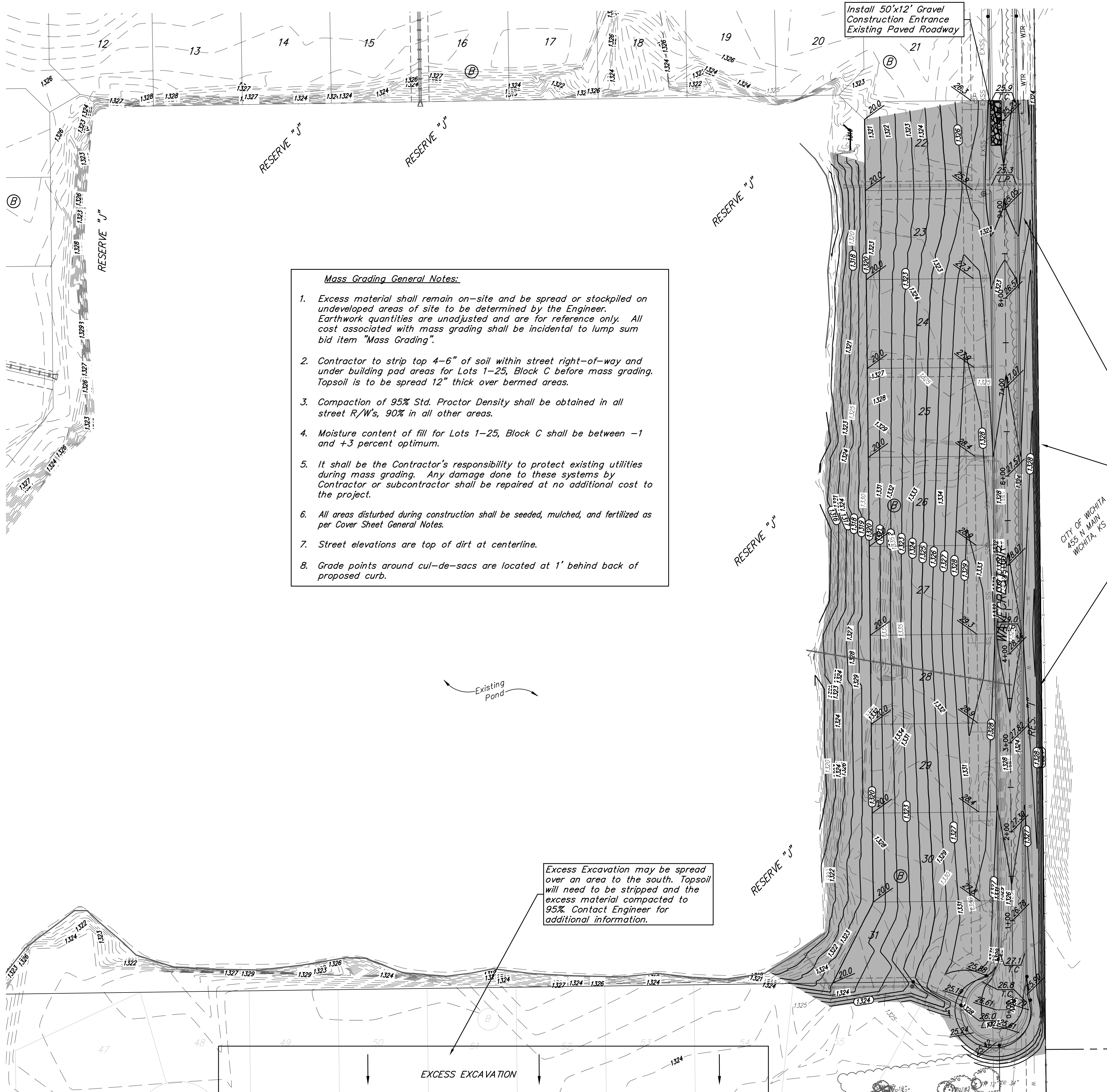

Install 50'x12' Gravel  
 Construction Entrance  
 Existing Paved Roadway

- Mass Grading General Notes:**
1. Excess material shall remain on-site and be spread or stockpiled on undeveloped areas of site to be determined by the Engineer. Earthwork quantities are unadjusted and are for reference only. All cost associated with mass grading shall be incidental to lump sum bid item "Mass Grading".
  2. Contractor to strip top 4-6" of soil within street right-of-way and under building pad areas for Lots 1-25, Block C before mass grading. Topsoil is to be spread 12" thick over bermed areas.
  3. Compaction of 95% Std. Proctor Density shall be obtained in all street R/W's, 90% in all other areas.
  4. Moisture content of fill for Lots 1-25, Block C shall be between -1 and +3 percent optimum.
  5. It shall be the Contractor's responsibility to protect existing utilities during mass grading. Any damage done to these systems by Contractor or subcontractor shall be repaired at no additional cost to the project.
  6. All areas disturbed during construction shall be seeded, mulched, and fertilized as per Cover Sheet General Notes.
  7. Street elevations are top of dirt at centerline.
  8. Grade points around cul-de-sacs are located at 1' behind back of proposed curb.

Excess Excavation may be spread  
 over an area to the south. Topsoil  
 will need to be stripped and the  
 excess material compacted to  
 95%. Contact Engineer for  
 additional information.

Remove trees  
 only as necessary  
 for construction

Existing Trees Shall be trimmed/removed  
 ONLY with approval of the Developer.  
 Trimming will be permitted only with  
 chainsaws. Trees Not In Direct Conflict  
 With Proposed New Construction Shall  
 Remain And Be Protected From Damage.  
 All Trimming or removal shall be  
 Included in Bid Item "Site Clearing"

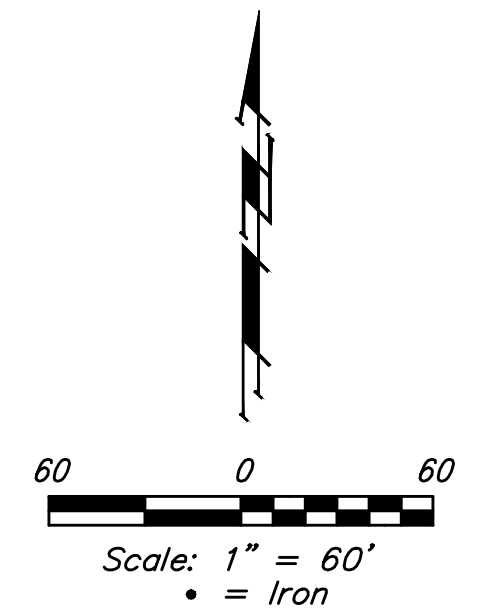

- Area to be graded
- Proposed Grade
- Existing Grade
- X Silt Fencing

**EARTH WORK TOTALS (Unadjusted)**  
 (for information only)

	C.Y. Cut	C.Y. Fill
Mass Grading	60,460	47,638

Earthwork quantities are for reference only. All cost associated with earthwork shall be included in L.S. "Grading, Mass"

EROSION CONTROL MEASURE	INSTALL	MAINTAIN
CONSTRUCTION ENTRANCE (EA)	2	0
SILT FENCE (LF)	1,052	0
DITCH CHECKS (EA)	0	0
DROP INLET PROTECTION (EA)	0	0
EROSION CONTROL MAT (SY)	0	0
MULCH WATTLE SED. BARRIER (LF)	0	0

\* ALL EXISTING BMPs INCLUDING CONSTRUCTION ENTRANCE, SEDIMENT BARRIERS, SILT FENCE, CUT-OFF TRENCH, AND EROSION CONTROL MAT SHALL BE MAINTAINED AND REPAIRED IF NECESSARY.

**Sandcrest 3rd Addition  
 MASS GRADING &  
 EROSION CONTROL**  
 Storm Water Drain #695

Baughman Company, P.A. 315 Ellis St. Wichita, KS 67211 P 316-262-7271 F 316-262-0149 ENGINEERING   SURVEYING   PLANNING   LANDSCAPE ARCHITECTURE			
PROJECT NUMBER 468-85272	DESIGN AEG	DRAWN JAK	
REVISIONS:	APPROVED	DATE 1/18/17	
	SCALE Noted	SHEET	<b>4 OF 12</b>

I:\Projects\Sandcrest 3rd Addition\_1706P290\Engineering\Phase 1\SWD\_1710E829\SWD PLANS.dwg