

PLOTTED: Wednesday, November 29, 2017 @ 02:49PM
 J:\PROJECTS\2017\1401040290 - COWI_127THE_13TH TO 21ST STS-CIVIL\CAO\PAV\42826D06.DWG

STATE	PROJECT NO.	YEAR	SHEET NO.	TOTAL SHEETS
KANSAS	87 N-0615-01	2017	40	183



GENERAL NOTES

- UNIT STRESSES:**
 Concrete $f'_c = 4 \text{ ksi}$
 Reinforcing Steel (Epoxy-Coated) $T_y = 60 \text{ ksi}$
- Special Concrete Bridge Approach shall be paid for as sq. yds of "Concrete Approach 12", "Bridge" and includes all work and materials required to construct the approach slab as shown on this sheet.
 - Formed joints shall be edged with 1/4" radius tool for length of joint.
 - Clearance from the face of concrete for all reinforcing steel, unless noted, shall be 2".
 - All casting to existing concrete, if cast previously, shall be brush blasted and power washed prior to casting concrete.
 - All reinforcing steel shall be epoxy coated. All epoxy coating damaged or removed through cutting shall be replaced as required by Specifications. WWF does not require epoxy-coating.
 - Standard reinforcing bar hooks in accordance with the latest ACI specifications shall be used throughout.
 - All work and materials required for installation of expansion joints shall be subsidiary to the bid item "Concrete Approach 12", "Bridge".
 - Skew Angle to match existing bridge E.W.S.
 - Cork Exp. Jt. and 20# Roofing Felt at each bridge E.W.S. shall be subsidiary to "Concrete Approach 12", "Bridge".

BILL OF REINFORCING STEEL
 (All Typ. Lane Slabs & Joint Bars)
 (Grade 60, Epoxy-Coated)

See Bending Diagram

Bar	B1	B2	C1	C2	C3
No.	96	185	45	45	60
Size	5	6	5	5	5
Length	14'-7"	15'-3"	9'-3"	8'-1"	14'-2"

Bar	C4	C5	C6	D1	D2
No.	60	30	30	141	42
Size	5	5	5	6	6
Length	13'-0"	14'-7"	13'-5"	3'-0"	4'-0"

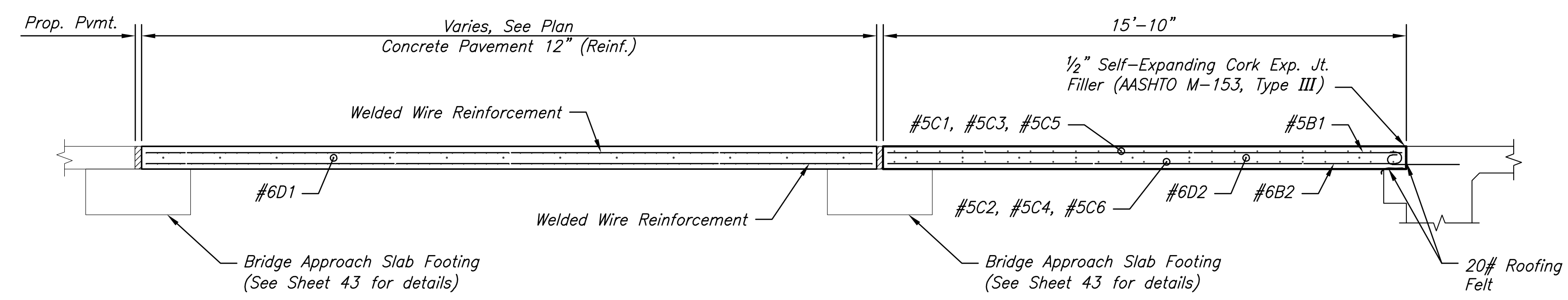

LONGITUDINAL SECTION
 Shown parallel to \perp Prop. Imp.
 (South Approach Looking West) (North Approach Looking East)

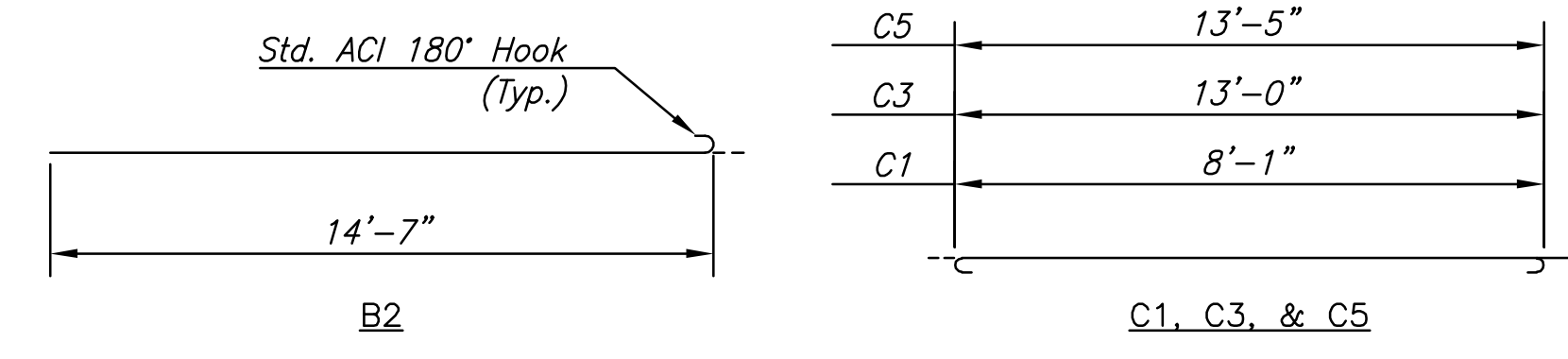

BAR BENDING DIAGRAMS
 All dimensions are out to out of bars.

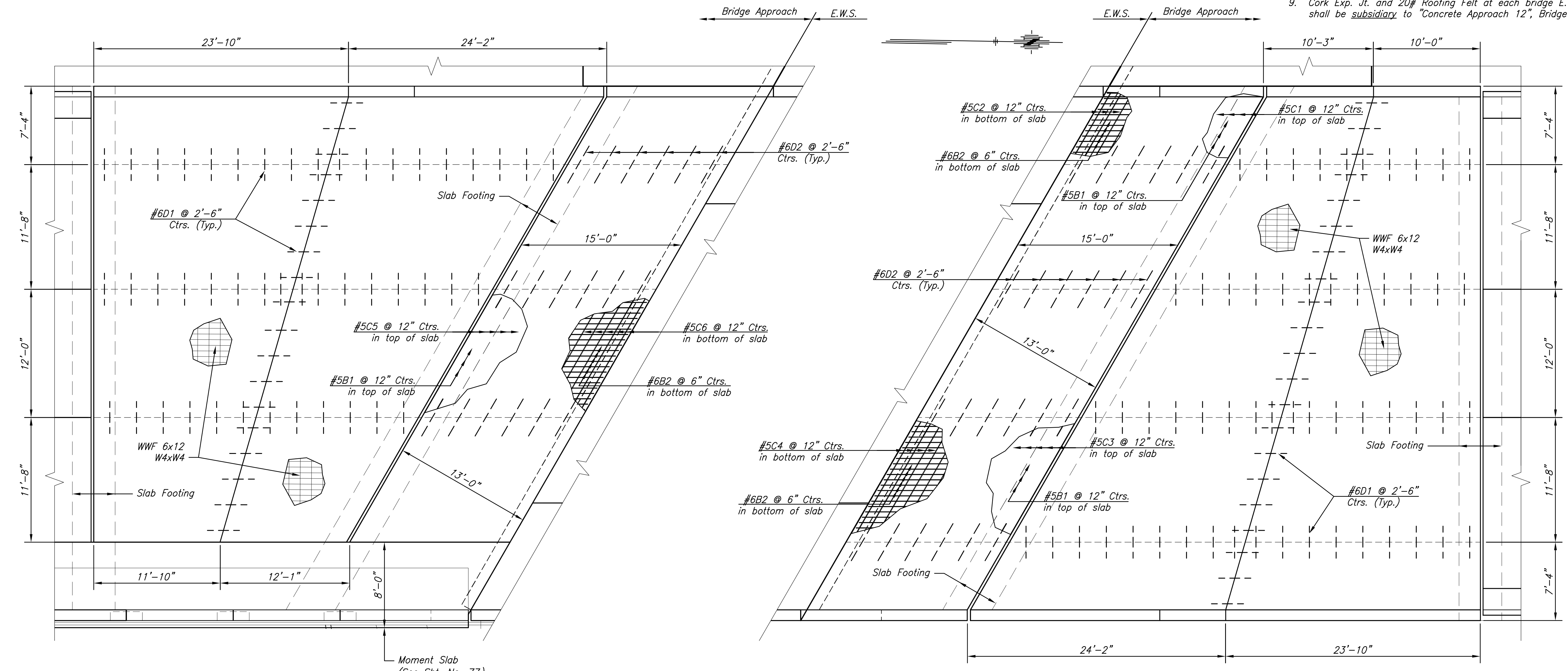

SOUTH APPROACH SLAB

NORTH APPROACH SLAB

STREET IMPROVEMENTS FOR
127TH STREET EAST
 FROM 13TH STREET NORTH TO 21ST STREET NORTH

©2017 MKEC Engineering
 All Rights Reserved
 www.mkec.com
 These drawings and their contents, including, but not limited to, all concepts, designs, & ideas are the exclusive property of MKEC Engineering (MKEC), and may not be used or reproduced in any way without the express consent of MKEC.

APPROACH SLAB DETAILS

PROJECT NO.	472-85158	
DATE	11/29/17	
SCALE	NTS	
DESIGNED	DRAWN	CHECKED
KJS	RAM	KJS

NO.	REVISION	DATE
-----	----------	------

SHEET NO.