

PLOT DATE: Wednesday, November 29, 2017 @ 03:30PM

STATE	PROJECT NO.	YEAR	SHEET NO.	TOTAL SHEETS
KANSAS	87 N-0615-01	2017	132	183

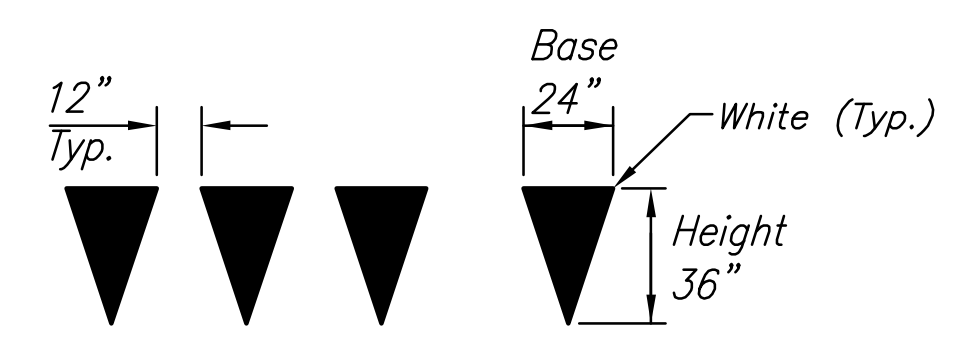

**YIELD LINE DETAILS**  
NOT TO SCALE

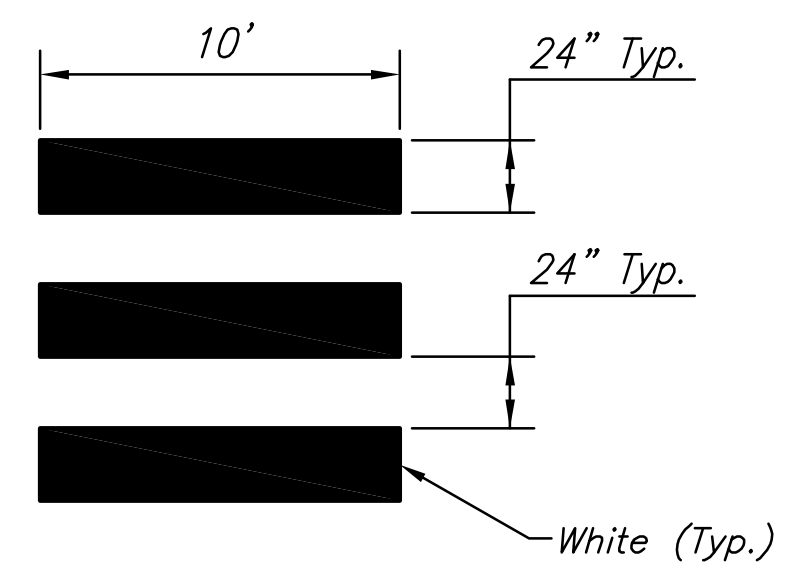

**HIGH VISIBILITY CROSSWALK LINE (BARS) DETAILS**  
NOT TO SCALE

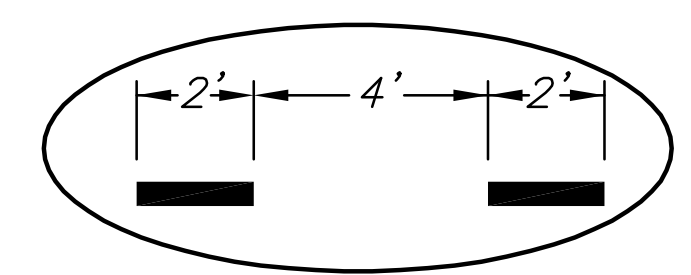

**TYPICAL SPACING FOR 4" DOTTED WHITE EXTENSION LINE**

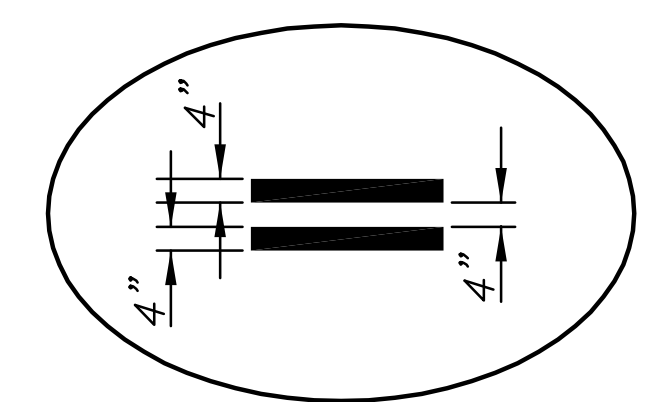

**TYPICAL SPACING FOR 4" DOUBLE YELLOW LINE**

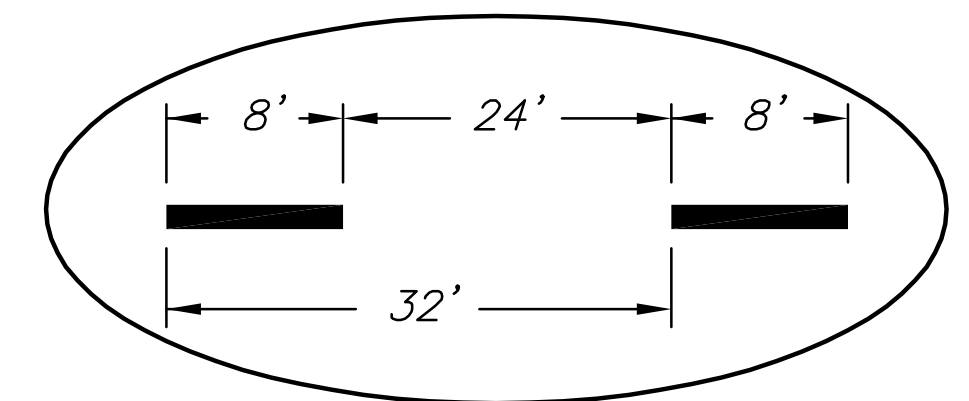

**TYPICAL SPACING FOR 6" BROKEN WHITE LANE LINES AND 4" BROKEN YELLOW LINES**

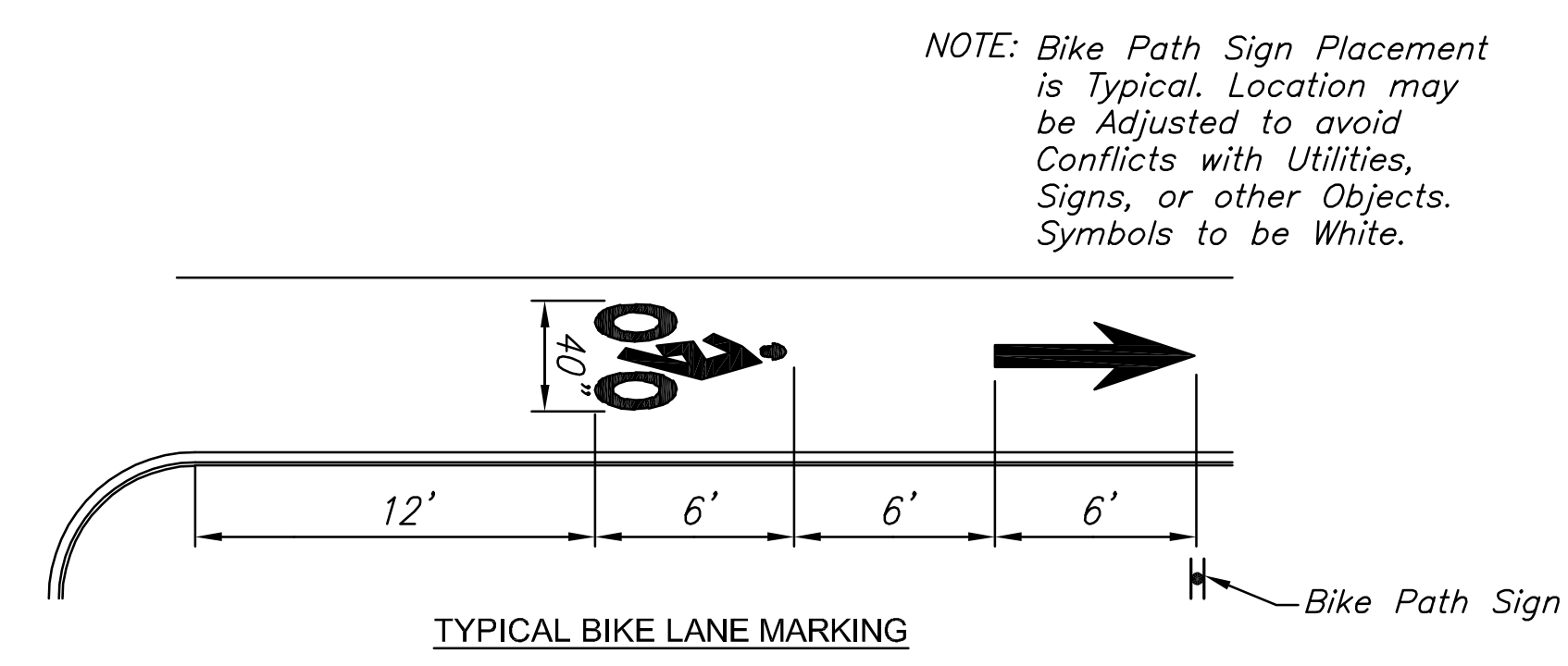

**TYPICAL BIKE LANE MARKING**

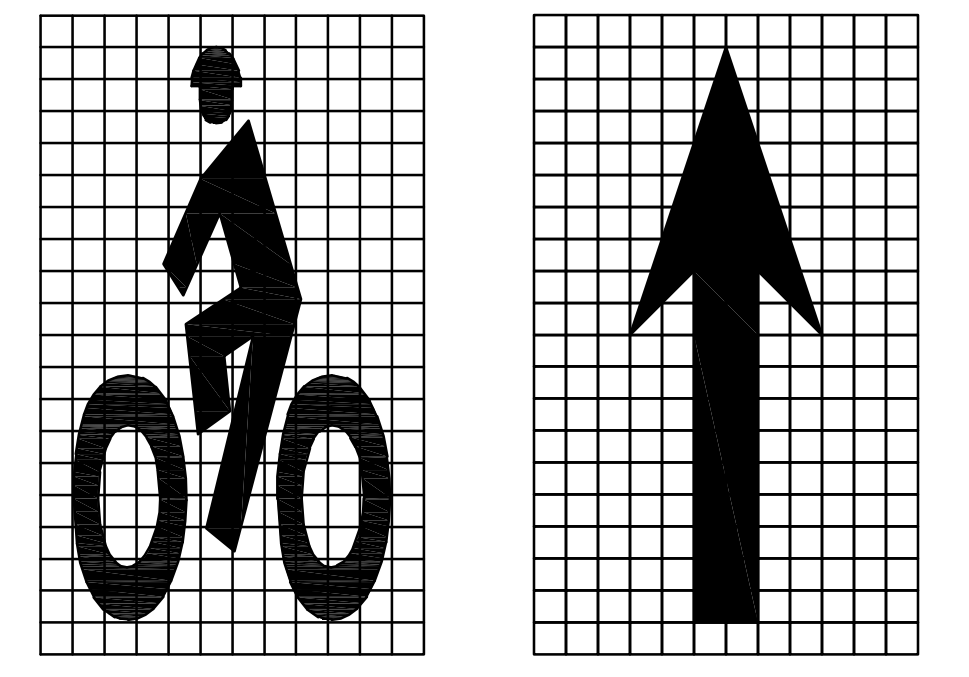

**TYPICAL BIKE LANE SYMBOLS**

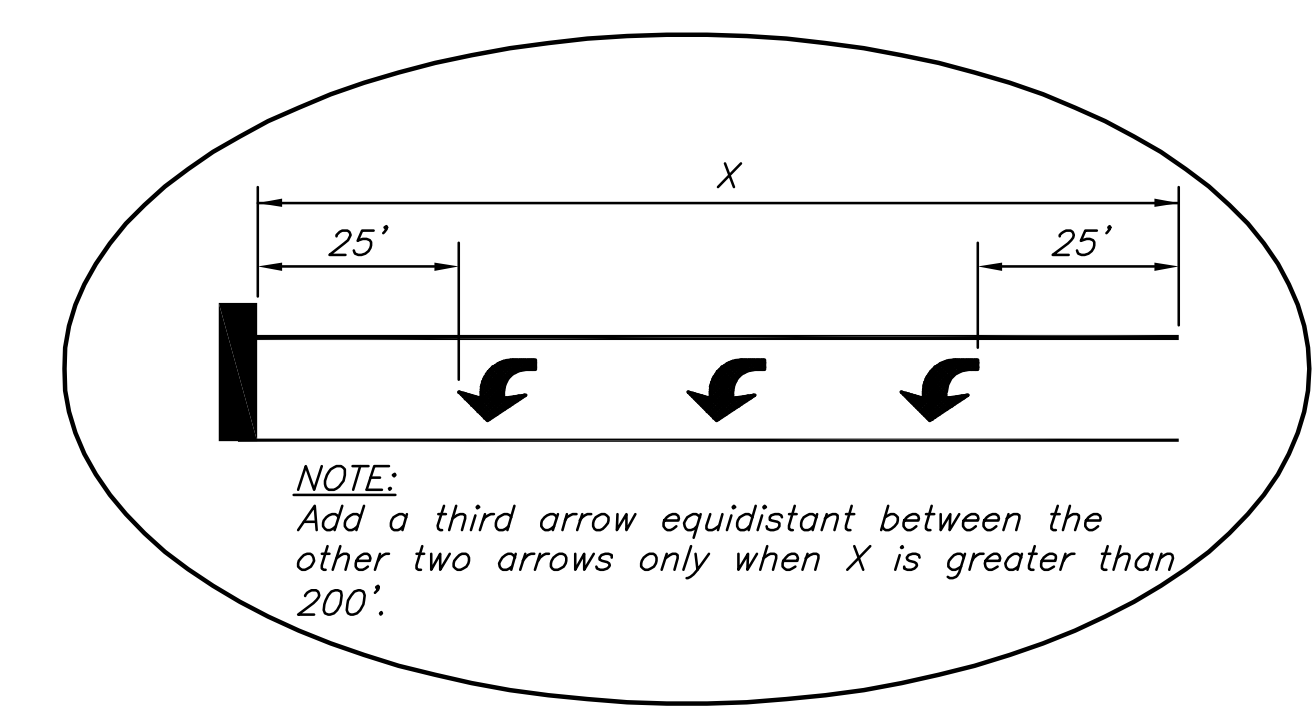

**ARROW SPACING DETAIL**

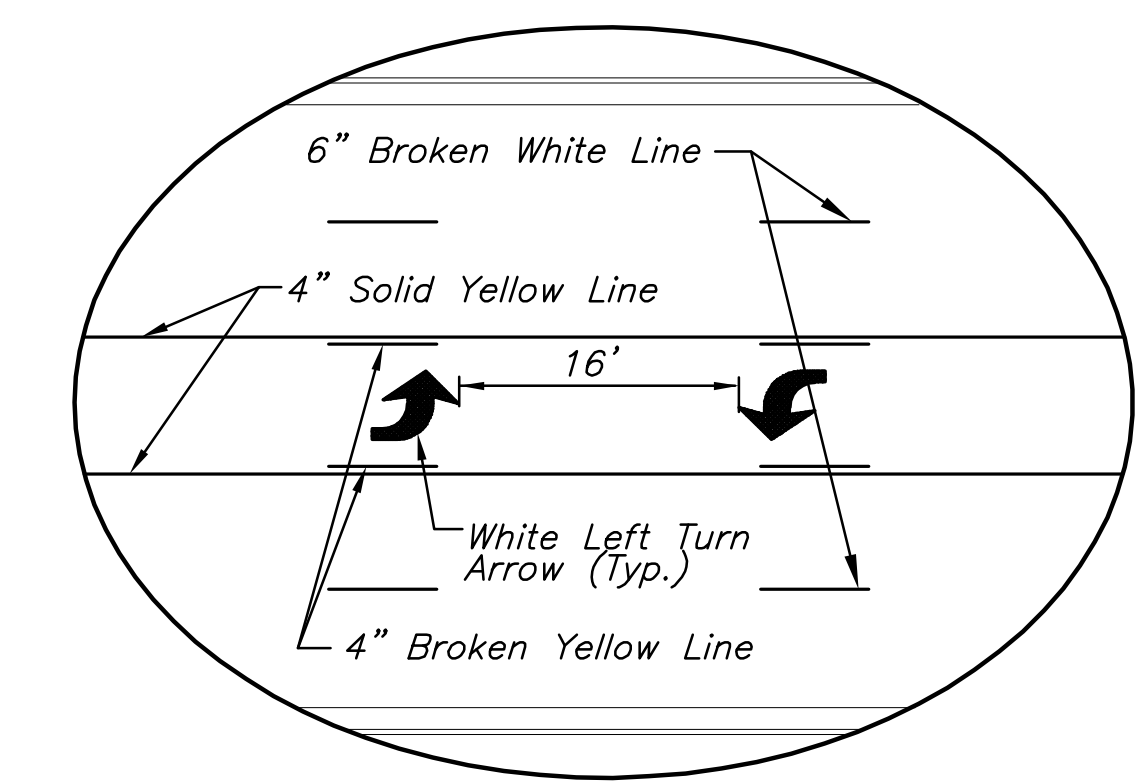

**TWO WAY LEFT TURN DETAIL**

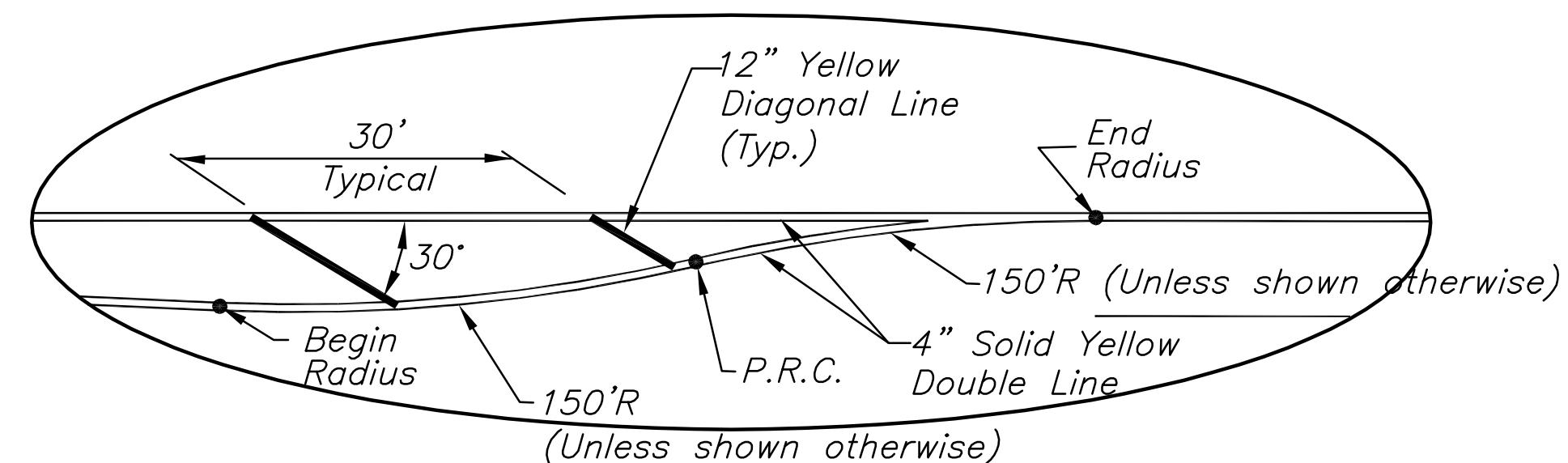

**TYPICAL APPROACH TAPER DETAIL**

STREET IMPROVEMENTS FOR  
**127TH STREET EAST**  
FROM 13TH STREET NORTH TO 21ST STREET NORTH

©2017 MKEC Engineering  
All Rights Reserved  
www.mkec.com  
These drawings and their contents, including, but not limited to, all concepts, designs, & ideas are the exclusive property of MKEC Engineering (MKEC), and may not be used or reproduced in any way without the express consent of MKEC.

**PAVEMENT MARKING DETAILS**

PROJECT NO.	472-85158	
DATE	11/29/17	
SCALE	NTS	
DESIGNED	DRAWN	CHECKED
JRA	BKS	JRA

NO.	REVISION	DATE

SHEET NO.

132 OF 183

J:\PROJECTS\2017\1401040280 - COM\_127THE\_13TH TO 21ST\05-CIVIL\CAD\PAV\4280EM05.DWG