

FHWA REG NO.	STATE	PROJECT NO.	YEAR	SHEET NO.	TOTAL SHEETS
7	KANSAS	87 N-0199-01	2002	41	158

FED. AID NO. CMQ-NO19(901)

N. 21st STREET

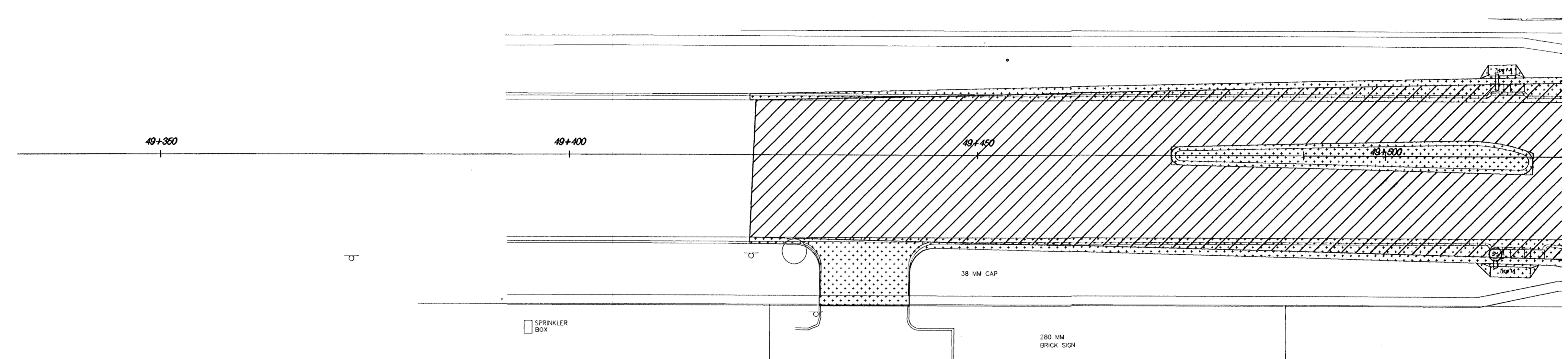

N. 21st STREET

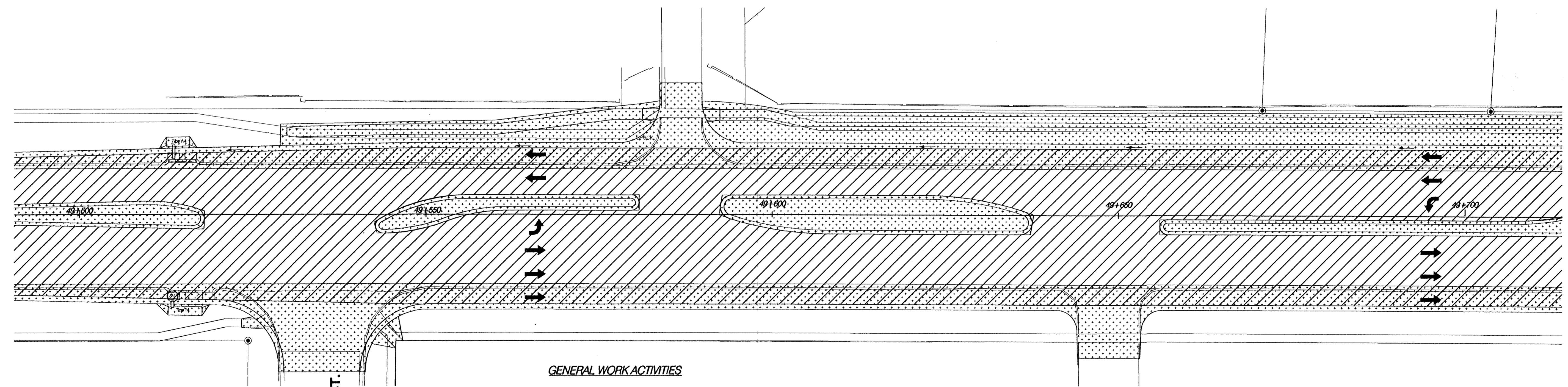

Legend

- Area Under Construction In Phase 9
N. 21st STREET Sta. 49+422.160 to Sta. 50+360.751
- Area Previously Constructed (Phases 1,2,3,4,5,6,7 & 8)

GENERAL WORK ACTIVITIES

1. Cold Plane Existing Pavement Surface
2. Construct Asphaltic Base Wedge Course
3. Construct Asphaltic Surface Course
4. Final Permanent Lane Striping Striping

See Plan Sheets for Removal and Construction Information

N. 21st STREET
PHASE 9
STA. 49+350 - 49+700

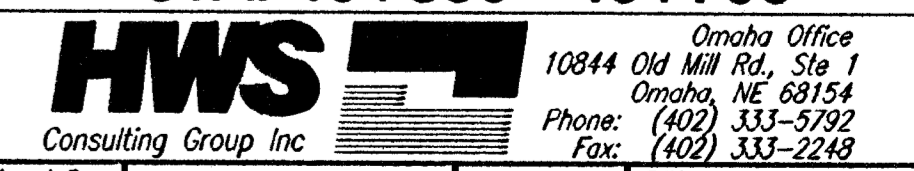

Designed By: BWE	Checked By: RJK
Drawn By: HS	Date: 03-25-2002 Job No. 55-70-2003