

NOTES:

1. REFER TO TRAFFIC SIGNAL PLANS FOR MODIFICATIONS TO EXISTING TRAFFIC SIGNALS AT THIS INTERSECTION.
2. TEMPORARY CONSTRUCTION TRAFFIC CONTROL DEVICES AND SIGNS INSTALLED DURING CONSTRUCTION SHALL BE REMOVED FROM VIEW OF VEHICULAR TRAFFIC WHEN NOT NECESSARY.
3. WHEELCHAIR RAMP SHALL HAVE RED CAST-IN-PLACE REPLACEABLE DETECTABLE WARNINGS INSTALLED AS INDICATED.
4. BRICK PAVERS REMOVED WITH THIS PROJECT SHALL BE PALATIZED AND DELIVERED TO THE CENTRAL MAINTENANCE FACILITY AT 1801 S. MCLEAN. SAID COST TO BE INCIDENTAL TO THE BID ITEM FOR "PAVEMENT REMOVAL".
5. ADD 1300 TO ALL SPOT ELEVATIONS INDICATED ON THIS SHEET FOR NAVD88 ELEVATIONS.

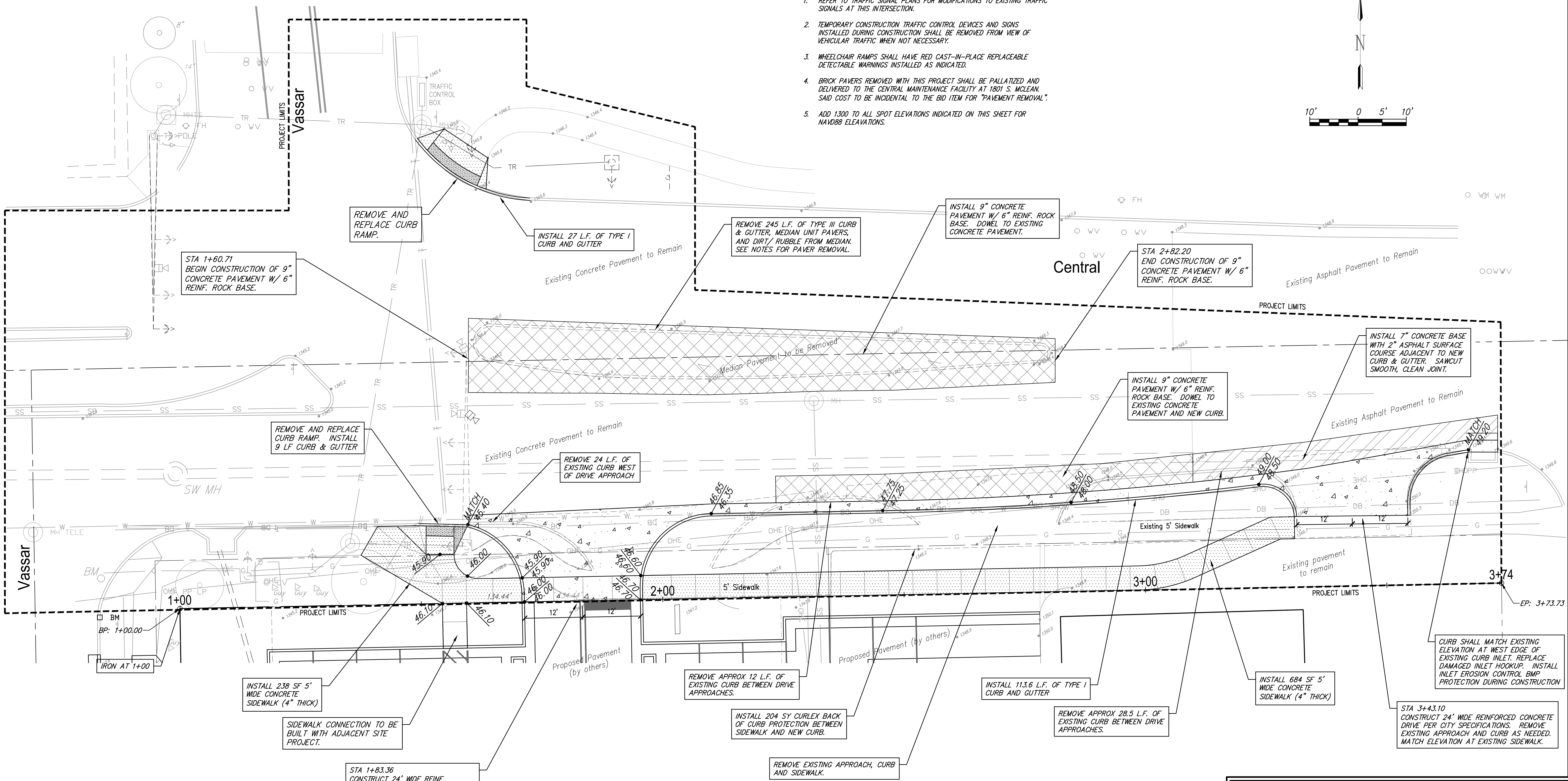
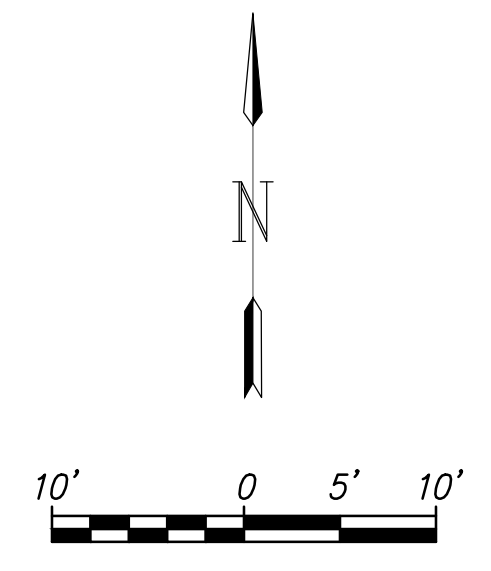

LEGEND

- W — W — EXISTING WATER
- SS — SS — EXISTING SANITARY SEWER
- AT&T — AT&T — EXISTING TELECOMMUNICATIONS (AT&T)
- CoTV — CoTV — EXISTING FIBER OPTIC LINE (AT&T OR COX)
- OHE — OHE — EXISTING WESTAR (OVERHEAD)
- UGE — UGE — EXISTING WESTAR (UNDERGROUND)
- — — EXISTING STORM WATER SEWER
- G — G — EXISTING KANSAS GAS SERVICE

STA 1+83.36
CONSTRUCT 24' WIDE REINF. CONCRETE DRIVE PER CITY SPECIFICATIONS. REMOVE EXISTING APPROACH, CURB AND SIDEWALK AS NEEDED. INSTALL RAMPS FOR SIDEWALKS.

Central & Vassar Median Modification		DATE 1-16-18
924 N. Main Wichita, Kansas 316-264-8008		DESIGN KWL
		DRAWN KWL
PROJECT NUMBER 472-85413	RB JOB NO. 4975T	REVIEW ...
DRAWING FILE 4975E Private Paving Plan Base [Median Modification]		SHEET 3
		OF 10