

**NOTE:**  
 CONTRACTOR SHALL FIELD ADJUST STRIPING LIMITS TO MATCH STRIPING ON EITHER SIDE OF PROJECT. STRIPING WILL BE REQUIRED OUTSIDE THE PAVEMENT REMOVAL LIMITS.

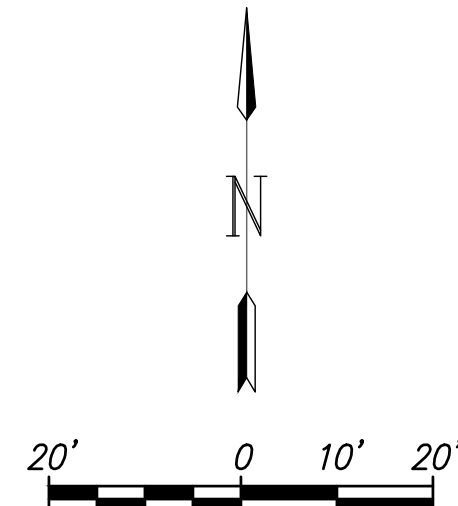
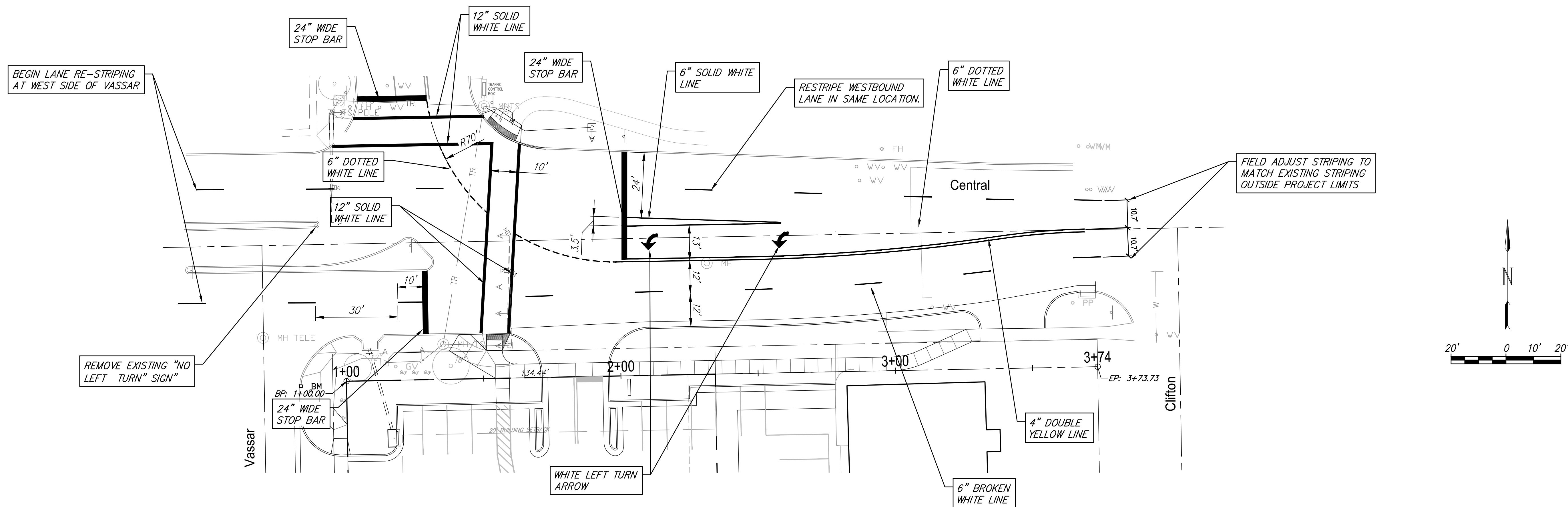

| Central & Vassar<br>Pavement Marking |   |        |         |
|--------------------------------------|---|--------|---------|
|                                      | <p><b>RUGGLES &amp; BOHM</b><br/>         ENGINEERING   SURVEYING   LANDSCAPE ARCHITECTURE   GOVERNMENT<br/>         924 NORTH MAIN WICHITA, KANSAS 67203 P (316) 264-8008 F (316) 264-4621<br/>         WWW.RBKANSAS.COM</p> | DATE   | 1-16-18 |
|                                      |   | DESIGN | KWL     |
| PROJECT NUMBER                       | 472-85413   | DRAWN  | KWL     |
| RB JOB NO.                           | 4975T   | REVIEW | KWL     |
| DWG. SCALE                           | ...   | SHEET  | 4       |
| DRAWING FILE                         | 4975E Private Paving Plan Base [Pavement Marking]   | OF     | 10      |