

N. ROCK ROAD

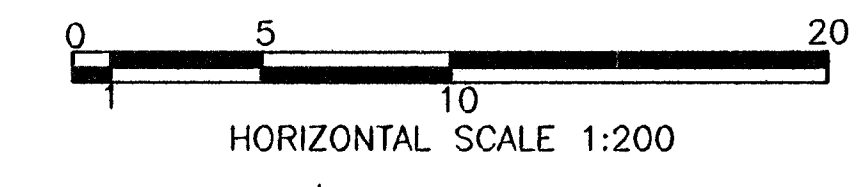

FHWA REG NO.	STATE	PROJECT NO.	YEAR	SHEET NO.	TOTAL SHEETS
7	KANSAS	87 N-0199-01	2002	81	158

FED. AID NO. - CMQ-NO19(901)

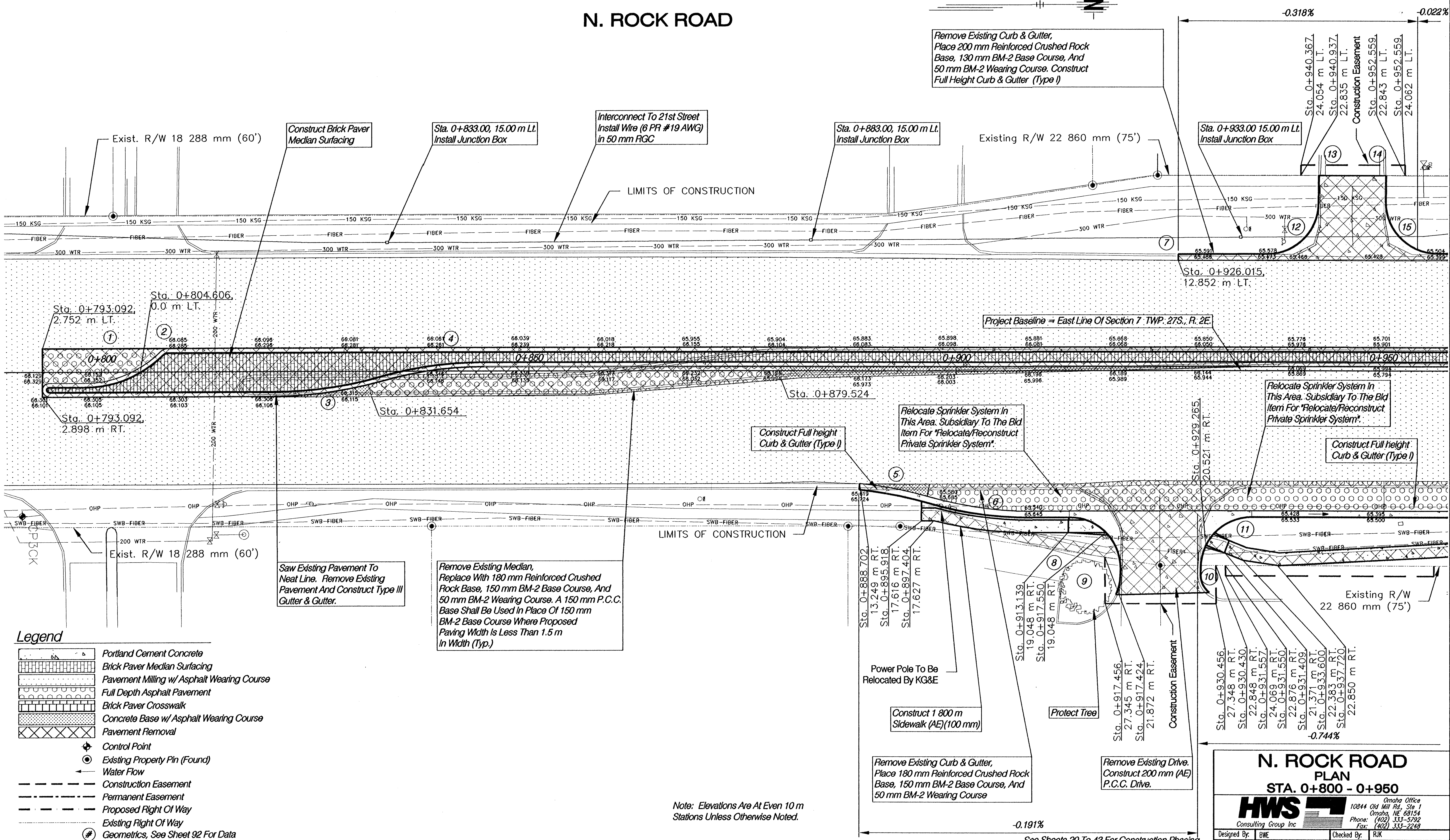

- Legend**
- Portland Cement Concrete
 - Brick Paver Median Surfacing
 - Pavement Milling w/ Asphalt Wearing Course
 - Full Depth Asphalt Pavement
 - Brick Paver Crosswalk
 - Concrete Base w/ Asphalt Wearing Course
 - Pavement Removal
 - Control Point
 - Existing Property Pin (Found)
 - Water Flow
 - Construction Easement
 - Permanent Easement
 - Proposed Right Of Way
 - Existing Right Of Way
 - Geometrics, See Sheet 92 For Data

Note: Elevations Are At Even 10 m Stations Unless Otherwise Noted.

See Sheets 20 To 43 For Construction Phasing

N. ROCK ROAD
PLAN
STA. 0+800 - 0+950

HWS Consulting Group Inc

Omaha Office
 10844 Old Mill Rd., Ste 1
 Omaha, NE 68154
 Phone: (402) 333-5792
 Fax: (402) 333-2248

Designed By: BWE	Checked By: RJK
Drawn By: HS	Date: 03-25-2002 Job No. 55-70-2003