

# N. 21st STREET

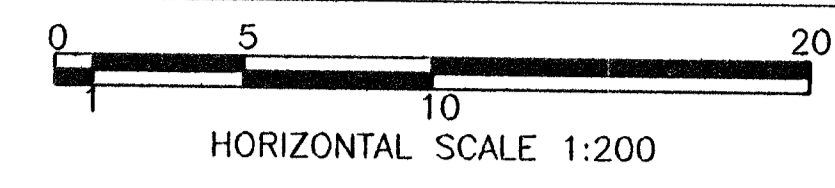

FHWA REG. NO.	STATE	PROJECT NO.	YEAR	SHEET NO.	TOTAL SHEETS
7	KANSAS	87 N-0199-01	2002	83	158

FED. AID NO. - CMQ-NO19(901)

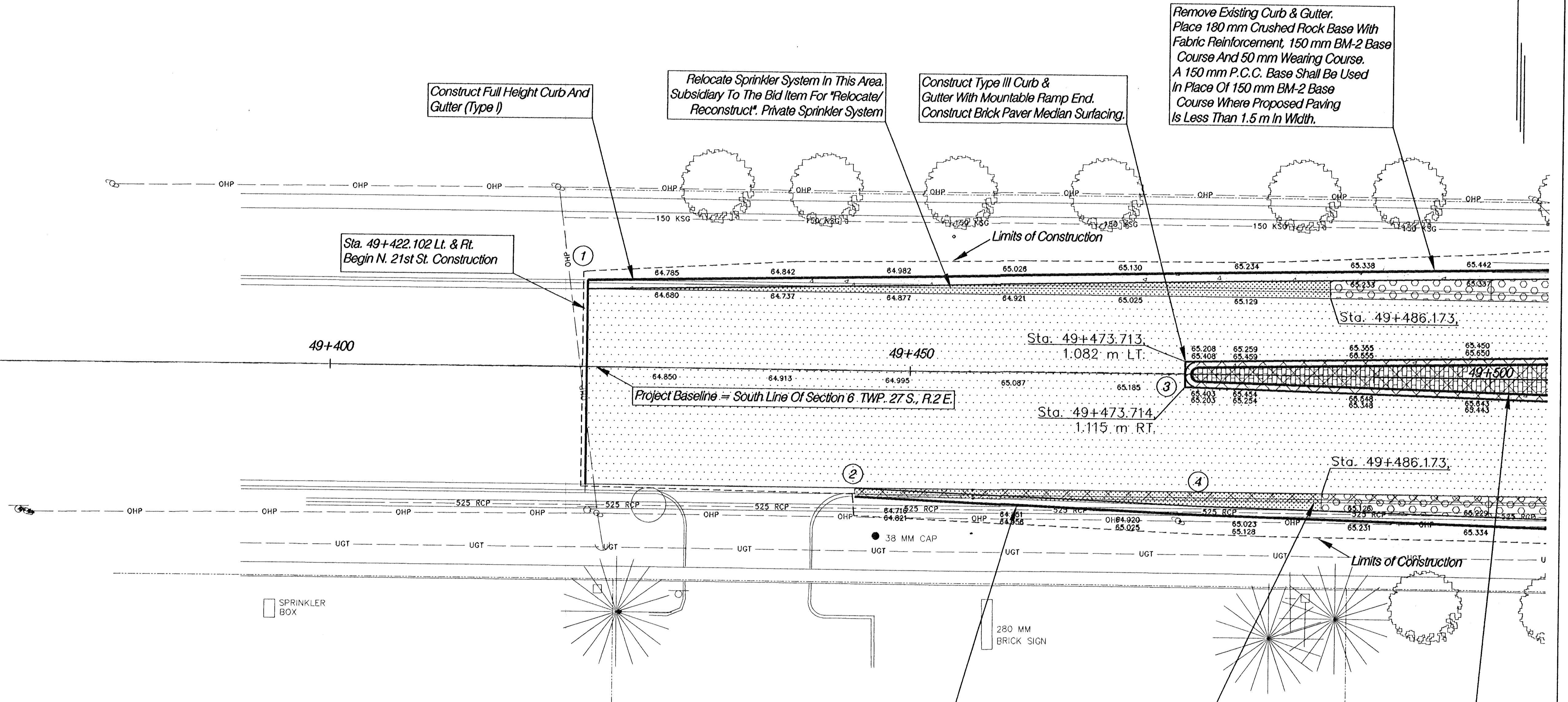
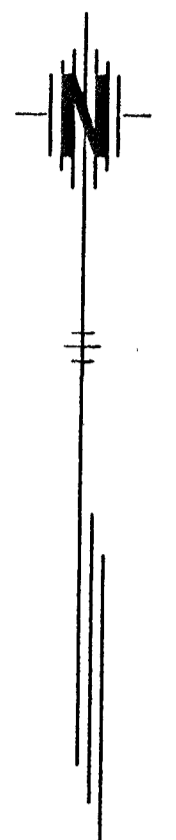

- Legend**
- Portland Cement Concrete
  - Brick Paver Median Surfacing
  - Pavement Milling w/ Asphalt Wearing Course
  - Full Depth Asphalt Pavement
  - Brick Paver Crosswalk
  - Concrete Base w/ Asphalt Wearing Course
  - Pavement Removal
  - Control Point
  - Existing Property Pin (Found)
  - Water Flow
  - Construction Easement
  - Permanent Easement
  - Proposed Right Of Way
  - Existing Right Of Way
  - Geometrics, See Sheet 93 For Data

Remove Existing Curb & Gutter. Place 180 mm Crushed Rock Base With Fabric Reinforcement, 150 mm BM-2 Base Course And 50 mm Wearing Course. A 150 mm P.C.C. Base Shall Be Used In Place Of 150 mm BM-2 Base Course Where Proposed Paving Is Less Than 1.5 m In Width.

Saw Existing Pavement To Neat Line Remove Existing Pavement. Construct Type III Curb And Gutter To Match Existing. Construct Brick Paver Median Surfacing.

Note: Elevations Are At Even 10 m Stations Unless Otherwise Noted.

**N. 21st STREET PLAN**  
**STA. 49+350 - 49+500**

**HWS** Consulting Group Inc. Omaha Office  
10844 Old Mill Rd., Ste 1  
Omaha, NE 68154  
Phone: (402) 333-5792  
Fax: (402) 333-2248

Designed By: EWE      Checked By: RJK  
 Drawn By: HS              Date: 03-25-2002      Job No. 55-70-2003

See Sheets 20 To 43 For Construction Phasing