

# N. 21st STREET

FHWA REG. NO.	STATE	PROJECT NO.	YEAR	SHEET NO.	TOTAL SHEETS
7	KANSAS	87 N-0199-01	2002	87	158

FED. AID NO. - CMQ-N019(901)  
 HORIZONTAL SCALE 1:200

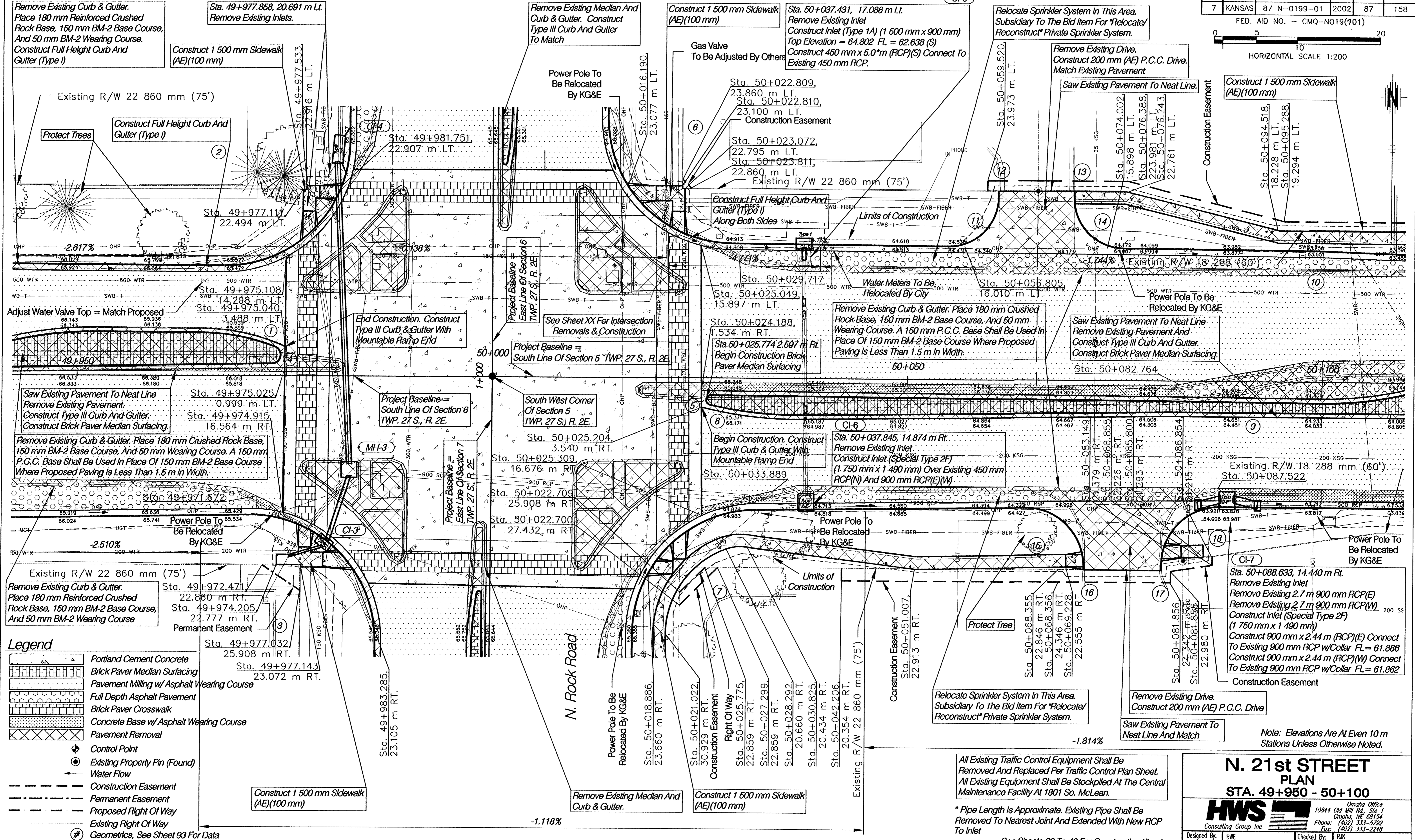

**Legend**

- Portland Cement Concrete
- Brick Paver Median Surfacing
- Pavement Milling w/ Asphalt Wearing Course
- Full Depth Asphalt Pavement
- Brick Paver Crosswalk
- Concrete Base w/ Asphalt Wearing Course
- Pavement Removal
- Control Point
- Existing Property Pin (Found)
- Water Flow
- Construction Easement
- Permanent Easement
- Proposed Right Of Way
- Existing Right Of Way
- Geometrics, See Sheet 93 For Data

All Existing Traffic Control Equipment Shall Be Removed And Replaced Per Traffic Control Plan Sheet.  
 All Existing Equipment Shall Be Stockpiled At The Central Maintenance Facility At 1801 So. McLean.  
 \* Pipe Length Is Approximate. Existing Pipe Shall Be Removed To Nearest Joint And Extended With New RCP To Inlet  
 See Sheets 20 To 43 For Construction Phasing

**N. 21st STREET PLAN**  
 STA. 49+950 - 50+100

**HWS**  
 Consulting Group Inc  
 Omaha Office  
 10844 Old Mill Rd., Ste 1  
 Omaha, NE 68154  
 Phone: (402) 333-5992  
 Fax: (402) 333-2248

Designed By: BWE  
 Checked By: RJK  
 Drawn By: HS  
 Date: 03-25-2002  
 Job No. 55-70-2003

Note: Elevations Are At Even 10 m Stations Unless Otherwise Noted.