

# N. 21st STREET

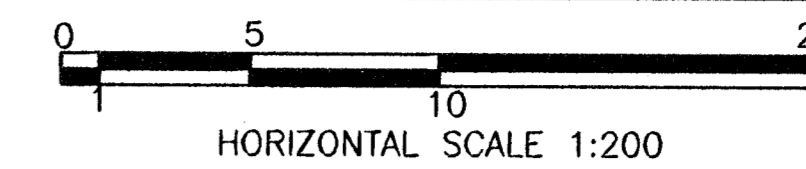

FHWA REG NO.	STATE	PROJECT NO.	YEAR	SHEET NO.	TOTAL SHEETS
7	KANSAS	87 N-0199-01	2002	88	158

FED. AID NO. - CMQ-NO19(901)

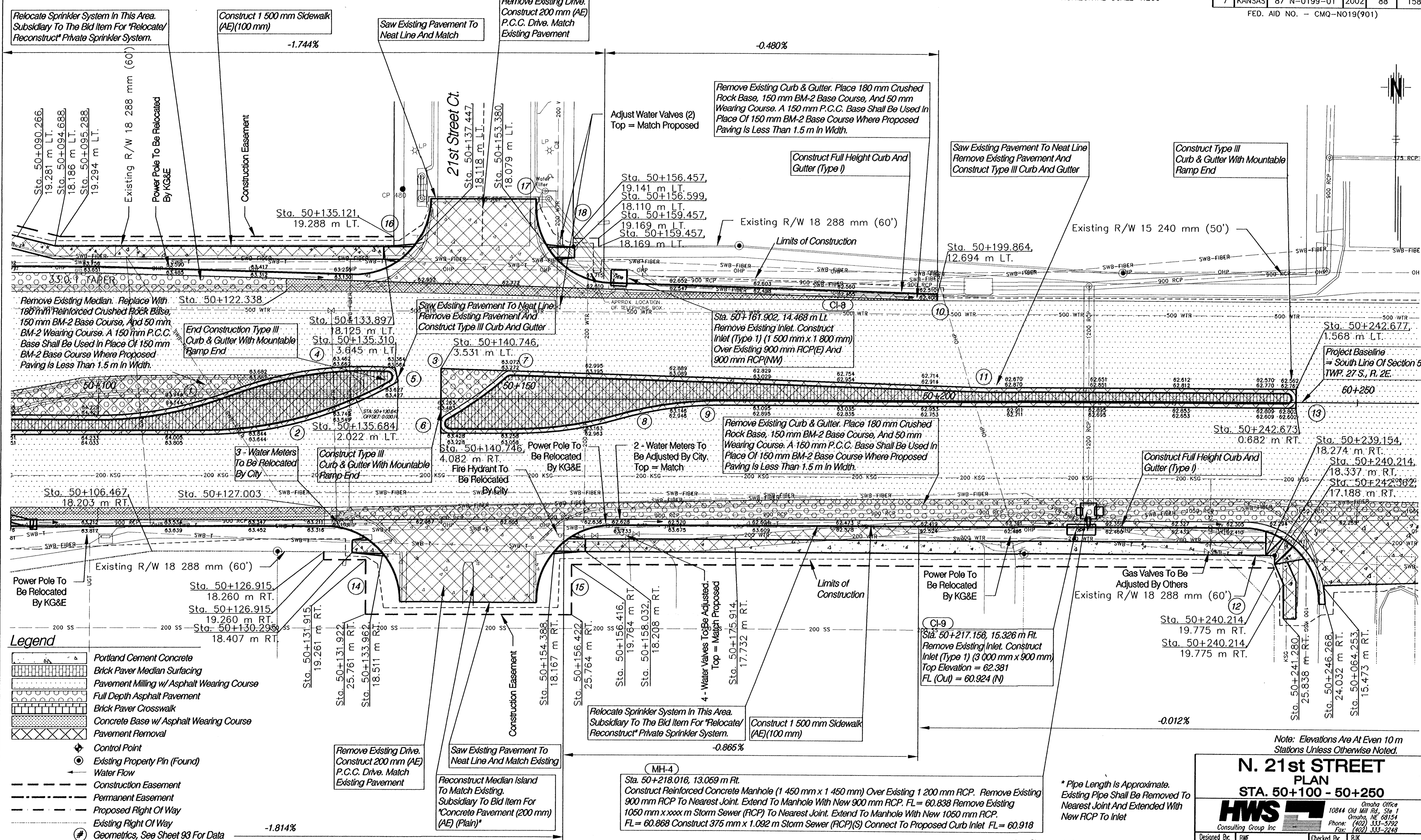

**Legend**

- Portland Cement Concrete
- Brick Paver Median Surfacing
- Pavement Milling w/ Asphalt Wearing Course
- Full Depth Asphalt Pavement
- Brick Paver Crosswalk
- Concrete Base w/ Asphalt Wearing Course
- Pavement Removal
- Control Point
- Existing Property Pin (Found)
- Water Flow
- Construction Easement
- Permanent Easement
- Proposed Right Of Way
- Existing Right Of Way
- Geometrics, See Sheet 93 For Data

Note: Elevations Are At Even 10 m Stations Unless Otherwise Noted.

## N. 21st STREET PLAN

STA. 50+100 - 50+250

Omaha Office  
10844 Old Mill Rd., Ste 1  
Omaha, NE 68154  
Phone: (402) 331-5792  
Fax: (402) 331-2448

Designed By: BWE  
Checked By: RJK  
Drawn By: HS  
Date: 03-25-2002  
Job No. 55-70-2003

See Sheets 20 To 43 For Construction Phasing

\* Pipe Length Is Approximate. Existing Pipe Shall Be Removed To Nearest Joint And Extended With New RCP To Inlet