

HORIZONTAL SCALE 1:100
 VERTICAL SCALE 1:5

FHWA REG NO.	STATE	PROJECT NO.	YEAR	SHEET NO.	TOTAL SHEETS
7	KANSAS	87 N-0199-01	2002	102	158

FED. AID NO. - CMQ-NO19(901)

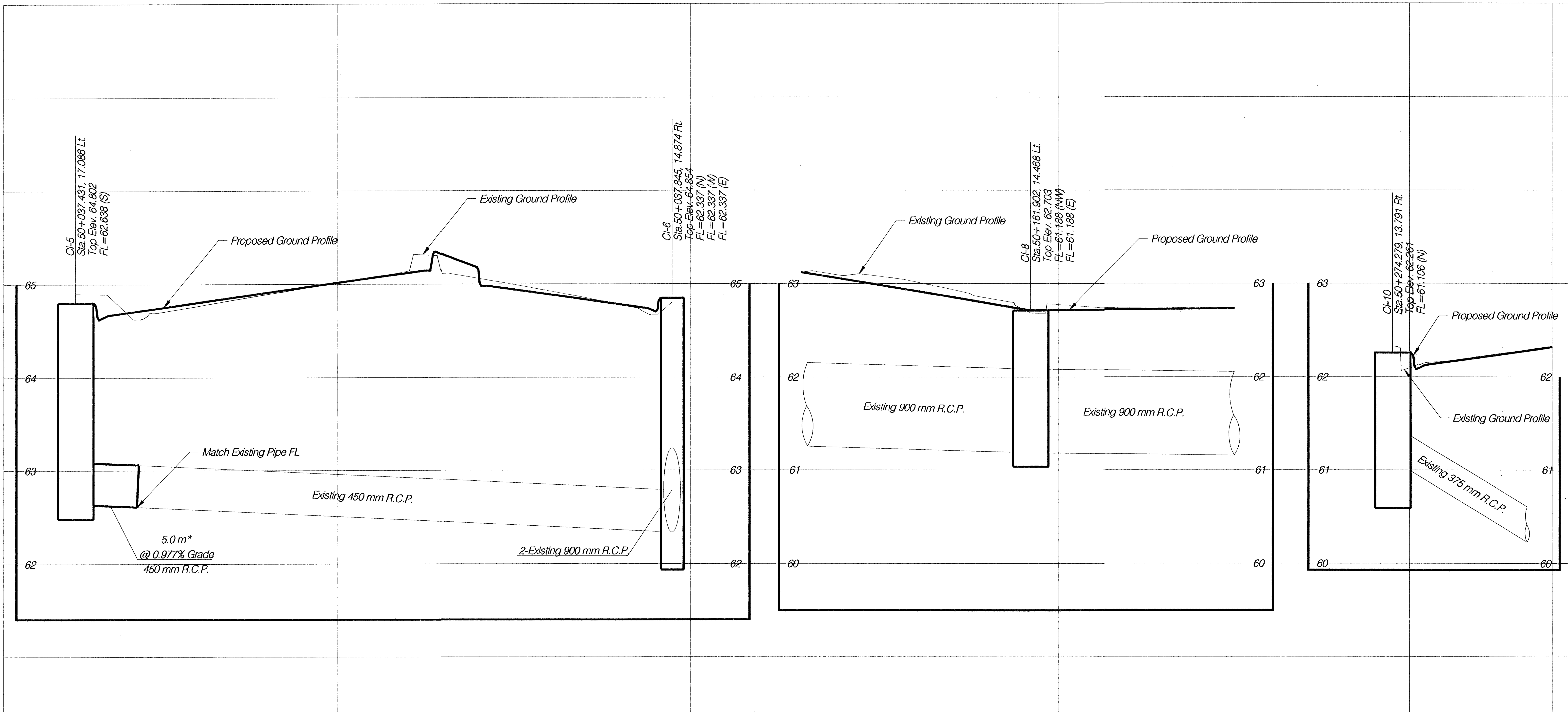

* PIPE LENGTH IS APPROXIMATE. EXISTING PIPE SHALL BE REMOVED TO NEAREST JOINT AND EXTENDED WITH NEW RCP TO INLET

**N 21st STREET
 PIPE PROFILES**

HWS Consulting Group Inc. Omaha Office
 10814 Old Mill Rd., Ste. 1
 Omaha, NE 68154
 Phone: (402) 333-5792
 Fax: (402) 333-2248

Designed By: BWE	Checked By: RJK
Drawn By: HS	Date: 03-25-2002 Job No. 55-70-2003