

LANDSCAPE NOTES

- All landscape work shall be done in accordance with industry standards.
- Refer to Engineer's Seeding plan for all turf ground cover, except turf in medians.
- Trees with broken leaders or no central leader will not be accepted.
- All planting beds shall be prepared by killing all existing vegetation with Round-Up (or equal) according to label directions. A Pre-emergent herbicide such as Treflan (5%) (or equal) shall be applied per label directions. All planting beds to receive 2" organic matter (such as cotton bur mulch, compost, or humus) and shall be rototilled in to a depth of 10-12".
- Topsoil hauled onto site shall be fertile, friable, natural loam topsoil, of uniform quality characteristic of representative local soils which produce heavy growth of crops, grass, or other vegetation. It shall be free of trash, or other matter toxic to plant growth.
- Topsoil shall be delivered in an unfrozen and non-muddy condition and shall be subject to approval by the Landscape Architect.
- Prior to any excavation for landscaping purposes the location of underground utilities shall be determined by calling Kansas One Call at 687-2470/1-800-344-7233. Contractor shall be responsible for any damage done to existing utilities.
- Report any discrepancies in the planting plan to the Landscape Architect, prior to starting construction.
- The Landscape Contractor shall coordinate with the G.C. to gain site access to install the plants and maintain grounds, until final acceptance from owner. Upon final acceptance, the one (1) year guarantee period will begin.
- The Landscape Contractor shall submit bid with unit prices for all plants, including mulch, installation, 1 year guarantee, bed preparation, fertilizer, etc.
- The Landscape Contractor is responsible for any damage done to sidewalks, curbs, pavement, utilities, existing trees to remain, or adjacent property not within project limits when installing or maintaining the plantings before final acceptance.
- General Contractor to coordinate with appropriate Local City Official to Remove/Transplant existing trees.
- Fall planting season shall be September 1 through October 31. Spring planting season shall be April 1 through June 30. For grass seeding, fall season shall be September 1 through mid October. Spring season for seeding shall be from March 15 through mid May.
- Quantities listed on the plant palette are for informational purposes only. Landscape Contractor shall be responsible for calculating quantities necessary to complete the installation of these plans.
- Landscape Contractor shall provide maintenance until final project acceptance including landscape maintenance and watering.

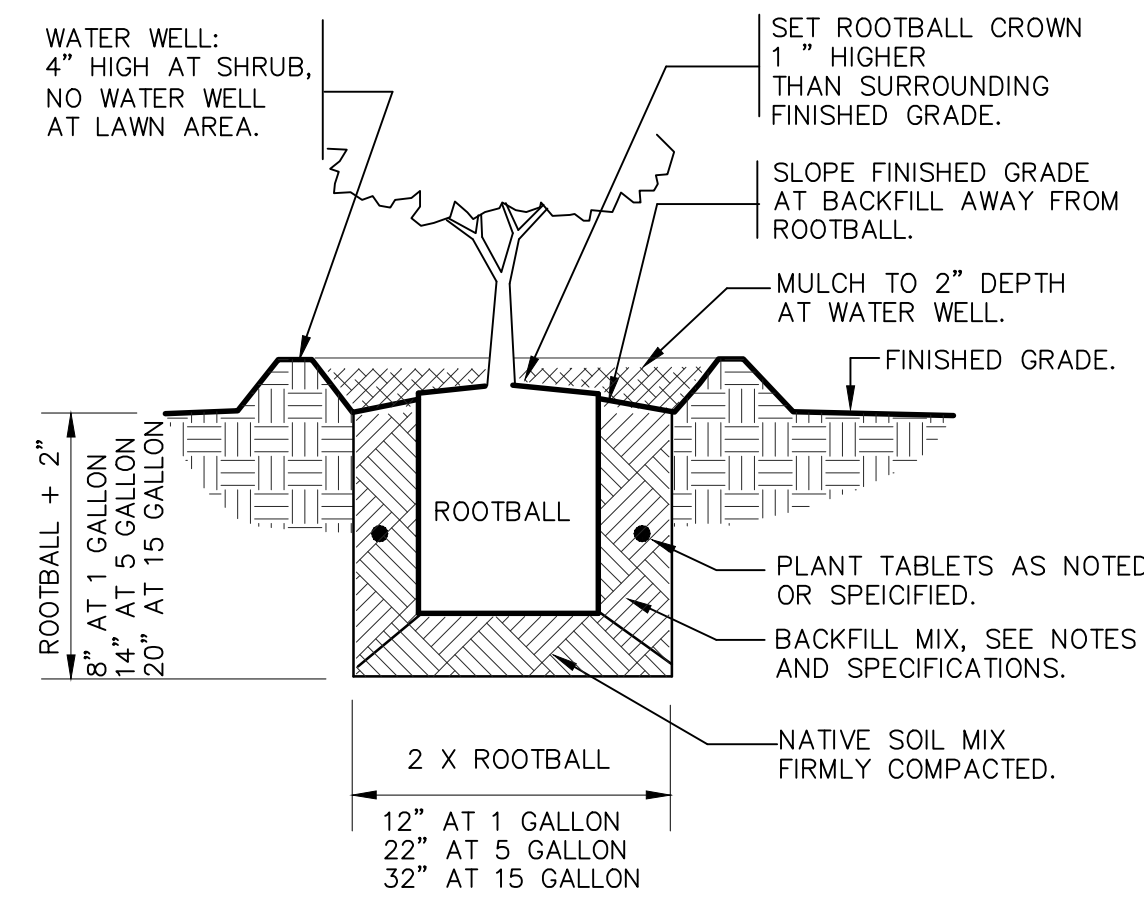

1 SHRUB PLANTING
1" = 1'-0" 329333.13-01

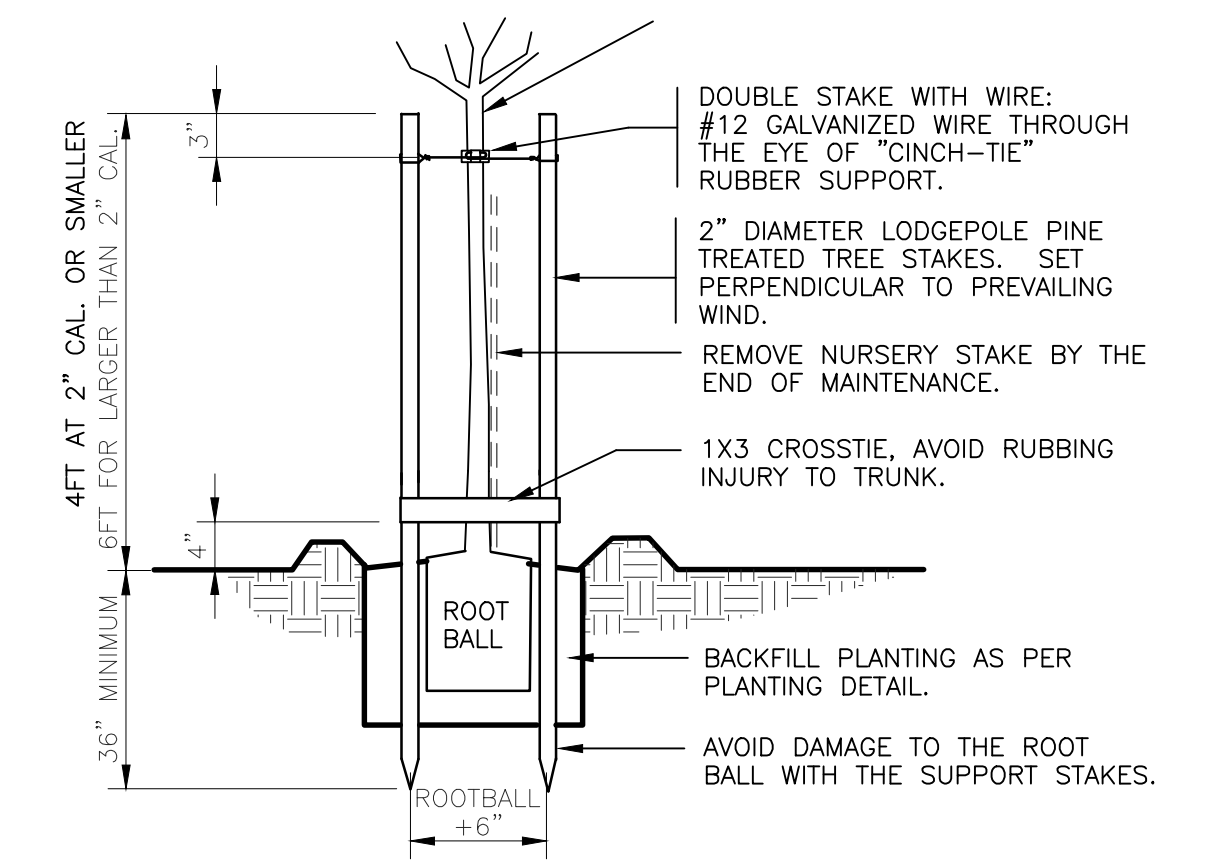

2 STAKING DETAIL

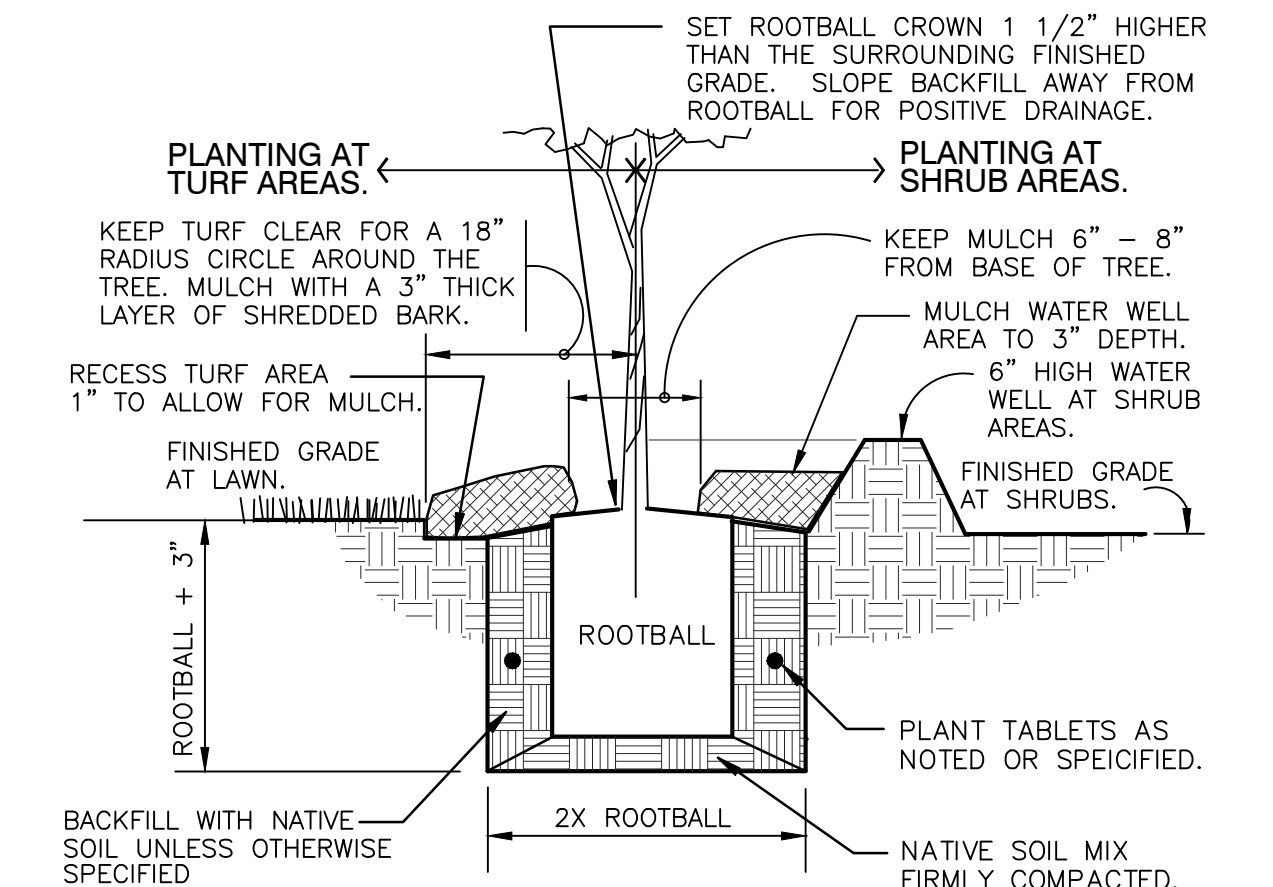

3 PLANT PIT DETAIL

PLANT SCHEDULE

TREES	QTY	12+50 TO 18+00	18+00 TO 23+50	23+50 TO 29+50	29+50 TO 35+00	3+11.05 TO 7+00	35+00 TO 41+00.3	41+00 TP HILLSIDE	7+00 TO 12+50	BOTANICAL NAME	COMMON NAME	CONT	CAL	SIZE
	11		3			5	3			CERCIS CANADENSIS 'OKLAHOMA'	OKLAHOMA REDBUD	B & B	1.5" CAL	
	12						12			JUNIPERUS VIRGINIANA 'CANAERTII'	CANAERTI JUNIPER	B & B		8'-10' H
	30	3	3	6	3		6		9	MALUS X 'PRAIRIFIRE'	PRAIRIFIRE CRAB APPLE	B & B	1.5" CAL	
	11				3		3		5	PISTACIA CHINENSIS	CHINESE PISTACHE	B & B	2" CAL	
	8		3	3	1		1			QUERCUS ACUTISSIMA	SAWTOOTH OAK	B & B	2" CAL	
	6	3		3						ULMUS PARVIFOLIA 'ALLEE'	ALLEE LACEBARK ELM	B & B	2" CAL	
	19	4		3	3		3	3	3	ZELKOVA SERRATA 'WIRELESS'	WIRELESS ZELKOVA	B & B	2" CAL	

2 TREE PLANTING DOUBLE STAKE B&B
1" = 1'-0" 329343.19-04

NOTE: Trees to be removed are marked as such:

Drawing File: E:\Projects\9th Street Corridor_16-02-E407\Civil 3D\Basemap
Project No. 16-02-E407 CAPITAL IMPROVEMENT PROJECT
Design: DPGJ
Drawn: DPGJ
Approved: PJM
Scale: NOTED

9TH STREET LANDSCAPE PLANS
Landscape Notes and Details
9TH STREET (0.135 to HILLSIDE)

Baughman Company, P.A.
315 Ellis St. Wichita, KS 67211 P 316-262-7271 F 316-262-0149
ENGINEERING | SURVEYING | PLANNING | LANDSCAPE ARCHITECTURE