

FHWA REG NO.	STATE	PROJECT NO.	YEAR	SHEET NO	TOTAL SHEETS
7	KANSAS	87 N-0287-01	2003	85	107

DATE	
BY	
REFERENCES NOTED	
REFERENCES CHECKED	

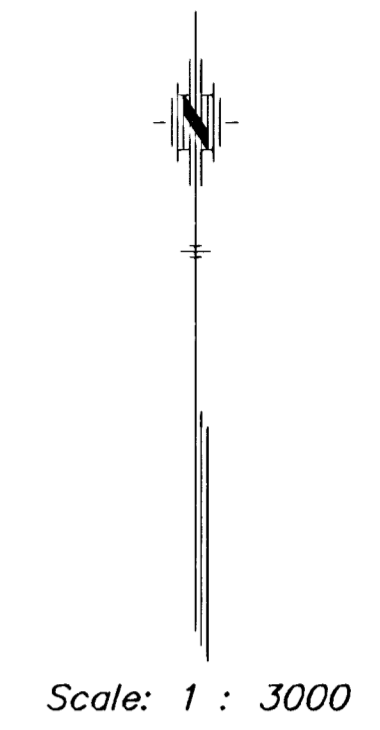
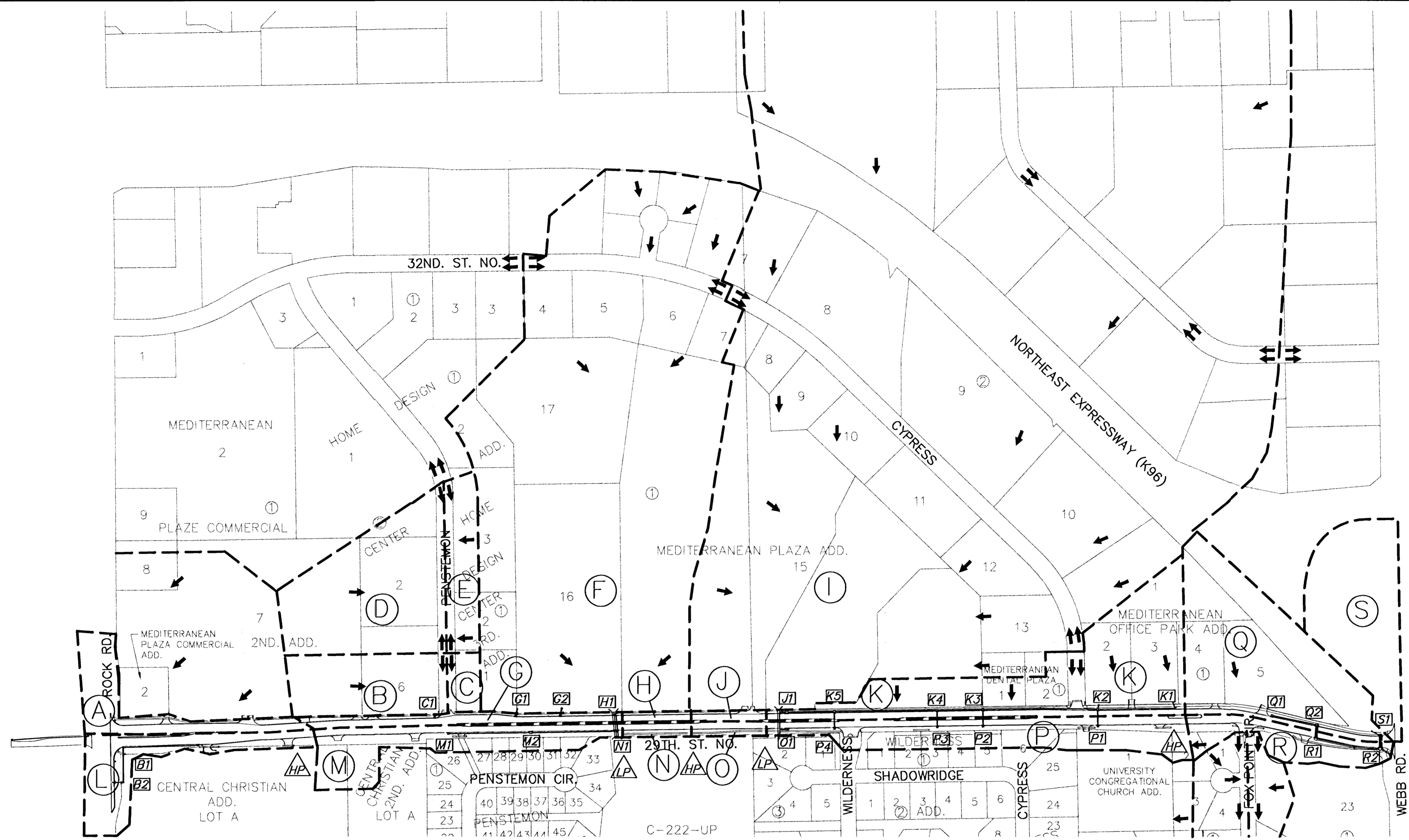

Area ID	Area ha	Accum. Area ha	C10	C100	Elev Max	Elev Min	Flow Length	Tc10 Calc	Tc100 Calc	Tc10 min	Tc100 min	I10 cm/hr	I100 cm/hr	Q10 cms	Q100 cms	Struct #	INLET (Q100)		Q100		
																	Inlet Size m	Pipe Size mm	Min Slope %		
Original Phase I Calcs																					
A	0.75		0.79	0.86	70.15	64.77	339.24	15.96	12.36	16	15	13.26	18.72	0.22	0.33						
B	1.51		0.73	0.80	70.56	67.11	221.76	15.50	12.57	16	15	132.59	187.20	0.40	0.62	B1	1.93				
C	0.30		0.73	0.80	67.97	67.13	88.85	11.36	9.21	15	15	13.26	18.72	0.08	0.13	B2	1.93				
D	3.05		0.79	0.84	70.41	67.82	242.99	15.42	12.93	15	15	13.26	18.72	0.88	1.32	C1	1.93				
E	0.91		0.79	0.84	69.49	67.82	242.08	17.77	14.91	18	15	12.57	18.72	0.25	0.39						
F	18.24		0.73	0.80	70.71	63.32	742.67	32.92	26.69	33	27	9.22	14.71	3.38	5.91	W.RCB					
G	0.64		0.72	0.82	69.77	65.23	407.56	24.13	17.78	24	18	10.72	17.78	0.14	0.26	G1	1.93	450	0.400%		
H	0.15		0.72	0.82	65.75	65.23	85.00	13.47	9.93	15	15	13.26	18.72	0.04	0.06	G2	1.93	450	0.400%		
I	62.37		0.73	0.80	75.47	63.37	1658.04	54.56	44.23	55	44	6.86	11.25	8.60	15.47	H1	3.45	W.RCB			
J	0.17		0.72	0.82	65.75	65.23	98.00	42.01	30.95	42	31	7.95	13.72	0.03	0.05	E.RCB					
K	3.69		0.73	0.80	70.71	65.23	643.43	32.27	26.16	32	26	9.22	14.71	0.68	1.20	J1	3.45	W.RCB			
																K1	1.93	450	0.80%		
																K2	1.93	600	0.45%		
																K3	1.93	600	0.65%		
																K4	1.93	750	0.85%		
																K5	1.93	900	0.40%		
L	1.20		0.79	0.86	70.20	65.23	332.78	16.13	12.49	16	15	12.90	18.72	0.34	0.53						
M	1.49		0.72	0.82	70.10	65.23	420.50	24.18	17.82	24	18	10.72	17.78	0.32	0.60	M1	1.93	450	0.600%		
																M2	3.45	600	1.500%		
N	0.15		0.72	0.82	65.29	65.23	85.00	27.39	20.26	27	20	10.11	16.59	0.03	0.06	N1	4.98	E.RCB			
O	0.17		0.72	0.82	65.29	65.23	98.00	30.95	22.81	31	23	9.55	15.90	0.03	0.06	O1	3.45	E.RCB			
P	1.92		0.72	0.82	68.32	65.23	543.32	34.84	25.67	35	26	8.92	14.99	0.34	0.65	P1	1.93	450	0.400%		
																P2	1.93	450	0.400%		
																P3	1.93	450	0.400%		
																P4	1.93	450	0.400%		
Q	1.20		0.72	0.82	67.83	67.25	241.00	17.22	14.16	17	15	4.95	7.37	0.26	0.39	Q1	1.93	600	0.300%		
																Q2	3.45	2-0.35	0.150%		
R	0.94		0.72	0.82	67.79	67.25	250.00	17.77	14.91	18	15	4.95	7.37	0.32	0.47	R1	3.45	0.90	0.200%		
																R2	3.45	0.90	0.200%		
S	2.21		0.72	0.82	68.54	67.25	685.00	30.67	20.87	31	21	3.76	6.53	1.47	2.21	S1	3.45	2-0.30	0.100%		

LEGEND

- = Drainage Area
- = Inlet I.D. Number
- = High Point/Low Point
- = Drainage Basin Boundary

2					
1					
NO.	DATE	REVISIONS	BY	APP'D	
KANSAS DEPARTMENT OF TRANSPORTATION					
<b>29TH. STREET NORTH DRAINAGE MAP</b>					
PROJ. NO. 87 N-0287-01			SEDGWICK CO.		
<b>MKEC ENGINEERING CONSULTANTS, INC.</b>					
WICHITA, KANSAS					
DESIGNED BY:	ASH	CHECKED BY:	GJA		
DRAWN BY:	WNJ	DATE:	Jan. 2003	SHEET 85 OF 107	