

Revised: See Bottom Rt. of this Sheet.

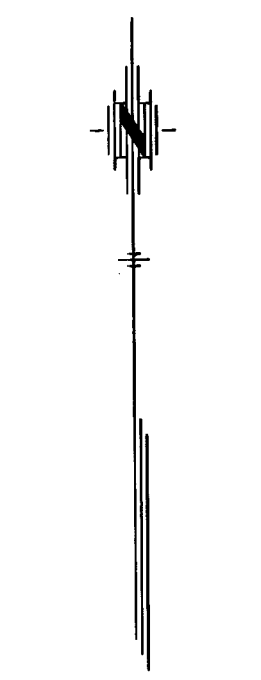

- S.W. CORNER 4-27S.-2E.
 1. 1/2" PIPE IN THIMBLE
 2. 3 NAILS IN P.P. 49.9 S.W.
 3. 3 NAILS IN COR. POST 63.25 S.E.
 4. 3 NAILS IN P.P. 60.75 N.E.

STA. 51+21.61 (WEBB RD.), LINE 2-B
 CONST. 2-STD. C.O.W. DROP INLETS
 DOUBLE 24"x24" (SIDE BY SIDE)
 W=5'-4", L=6'-8"
 INLET TOP=204.0
 103.70'LT. (§ TO C INLETS)
 E IN=198.50 (14"x23" RCPHE-E.)
 (1.5 SQ.FT.)

STA. 51+24.50 (WEBB RD.), LINE 2-B
 CONST. STD. C.O.W. TYPE 1-A CURB INLET
 W=4'-4", L=11'-4"
 INLET TOP=203.92
 42.5 FT. LT. (§ TO FRONT EXT. WALL)
 E IN=198.35 (14"x23" RCPHE-W.)(1.5 SQ.FT.)
 E OUT=198.25 (24"x38" RCPHE-E.)(5.0 SQ.FT.)

STA. 9+88.5, LINE 1
 CONST. STD. TYPE B MANHOLE STACK
 ON TOP OF SPECIAL 10'x54" RCB
 MANHOLE TOP=205.52
 31.97 FT. LT. (§ TO C OF MANHOLE)
 E IN=193.87 (10'x54" RCB-W.)
 E OUT=193.87 (43"x68" RCPHE-S.)
 (16.5 SQ.FT.)

STA. 51+25.25 (WEBB RD.), LINE 2 & LINE 2-B
 CONST. STD. C.O.W. TYPE 1-A CURB
 INLET STACK ON TOP OF 4'x3' RCB (PRECAST)
 W=4'-4", L=11'-4"
 INLET TOP=203.92
 42.5 FT. RT. (§ TO FRONT EXT. WALL)
 E IN=197.85 (24"x38" RCPHE-W.)(5.0 SQ.FT.)
 E IN=198.10 (24" RCP-N.)
 E OUT=197.85 (4'x3' RCB-S.)

STA. 11+13.5, LINE 2
 CONST. SPECIAL 45' BEND TYPE
 'B' MANHOLE STACK
 MANHOLE TOP=205.10
 44.5 FT. LT. (§ TO C MANHOLE)
 E IN=197.74 (4'x3' RCB(PRECAST)-N.W.)
 E OUT=197.74 (4'x3' RCB(PRECAST)-E.)
 SEE DETAIL SHEET 60

STA. 9+30.00, LINE 1
 CONST. STD. TYPE B MANHOLE STACK
 ON TOP OF SPECIAL 10'x54" RCB
 MANHOLE TOP=204.37
 31.97 FT. LT. (§ TO C OF MANHOLE)
 E IN=193.99 (54" RCP-W.)
 E OUT=193.99 (10'x54" RCB-W.)

STA. 51+13.5 (WEBB RD.), LINE 2
 CONST. SPECIAL 45' BEND TYPE
 'B' MANHOLE STACK
 MANHOLE TOP=203.92
 44.5 FT. RT. (§ TO C MANHOLE)
 E IN=197.84 (4'x3' RCB(PRECAST)-N.)
 E OUT=197.84 (4'x3' RCB(PRECAST)-E.)
 SEE DETAIL SHEET 60

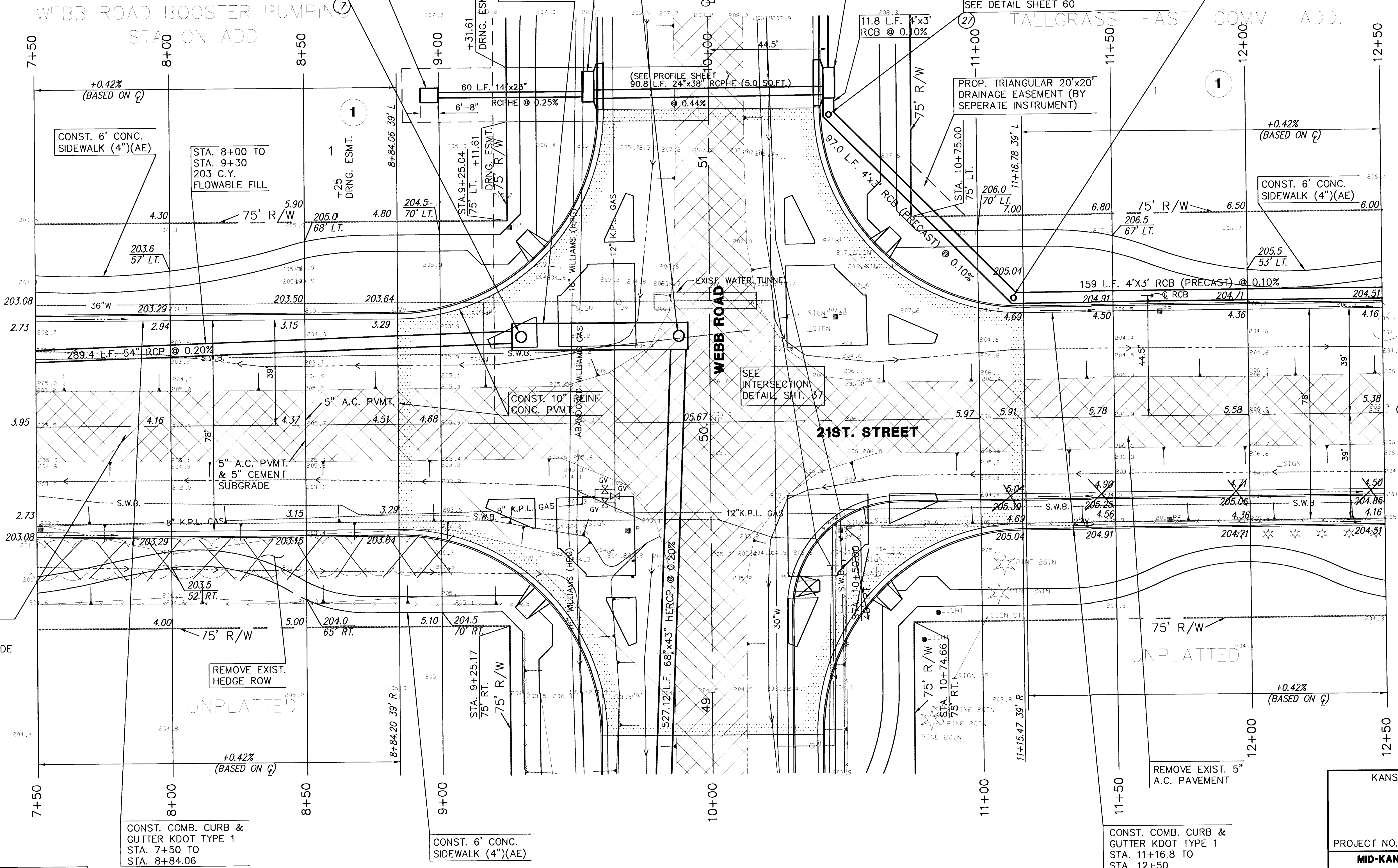

REMOVE EXIST. 5" A.C. PAVEMENT & 5" CEMENT SUBGRADE

REMOVE EXIST. HEDGE ROW

REMOVE EXIST. 5" A.C. PAVEMENT

CONST. COMB. CURB & GUTTER KDOT TYPE 1
 STA. 7+50 TO
 STA. 8+84.06

CONST. 6" CONC. SIDEWALK (4")(AE)

CONST. COMB. CURB & GUTTER KDOT TYPE 1
 STA. 11+16.8 TO
 STA. 12+50

LEGEND
 PAVEMENT, DRIVEWAY AND/OR SIDEWALK REMOVAL

REVISED 11/01/93

KANSAS DEPARTMENT OF TRANSPORTATION

**21ST. STREET NORTH
 7+50 TO 12+50**

PROJECT NO. 87-U-1362-01 SEDGWICK CO.
MID-KANSAS ENGINEERING CONSULTANTS, INC.
 WICHITA, KANSAS

DESIGNED BY:	GJA	CHECKED BY:	DLH & KJS
DRAWN BY:	WNJ	DATE:	SHEET 31 OF 149

CITY OF WICHITA WATER DEPARTMENT 268-4908
 KANSAS GAS & ELECTRIC (K.G.&E.) 262-1141
 KPL GAS SERVICE CO. 263-7511
 RURAL WATER DISTRICT 832-0213
 SOUTHWESTERN BELL TELEPHONE CO. 1-571-2811
 WILLIAMS PIPELINE 524-4390

WATER VALVE BOX ADJUSTMENTS				
STATION	OFFSET	EXISTING ELEV.	PROPOSED ELEV.	NOTES
8+83	41'L	204.25	203.65	W.V.