

FINA REGION NO.	STATE	PROJECT NO.	YEAR	SHEET NO.	TOTAL SHEETS
7	KS.	87-U-1362-01	1993	25	149

- N.W. CORNER 4-27S.-2E.  
 1. FOUND 1/2" BAR IN THIMBLE  
 2. Q PROP. IMPROVEMENTS STA. 103+44.04  
 3. CHISELED "+" ON TOP OF CURB 30.2 E.  
 4. CHISELED "+" ON TOP OF CURB 29.75 W.  
 5. CHISELED "+" ON TOP OF CURB 52.5 S.W.  
 6. CHISELED "+" ON TOP OF CURB 48.65 N.W.

REMOVE EXIST. TAPERED CURB TO NEAREST JOINT AND REPLACE W/KDOT TYPE 1 CURB & GUTTER

STA. 94+08 MATCH EXIST. SIDEWALK TRANSITION 6' WALK TO 4' WALK BETWEEN 2 TRANSVERSE JOINTS

SCALE: 1"=20'

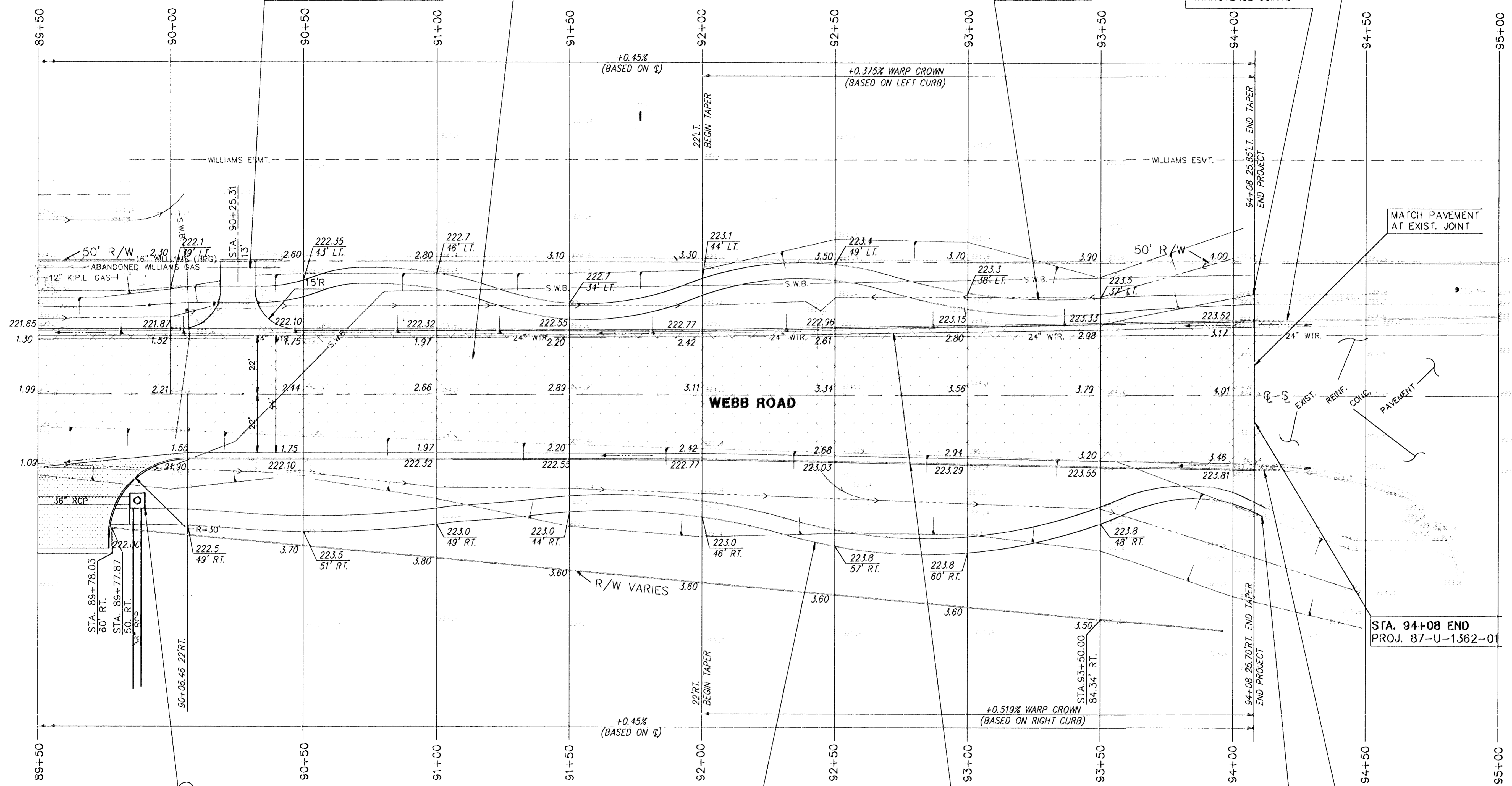

44  
 STA. 89+87.50, LINE 3  
 CONST. REINF. CONC. MANHOLE  
 W=5'-8", L=5'-8"  
 MANHOLE TOP=222.00  
 40.17 FT. RT. (8" TO Q MANHOLE)  
 E IN=211.19 (36" RCP-S.)  
 E OUT=211.09 (36" RCP-E.)

CONST. 6" CONC. SIDEWALK (4")(AE)

CONST. COMB. CURB & GUTTER KDOT TYPE 1 STA. 89+50 TO STA. 94+08

STA. 94+11 MATCH EXIST. SIDEWALK TRANSITION 6' WALK TO 4' WALK BETWEEN 2 TRANSVERSE JOINTS

REMOVE EXIST. TAPERED CURB TO NEAREST JOINT AND REPLACE W/KDOT TYPE 1 CURB & GUTTER

STA. 94+08 END PROJ. 87-U-1362-01

LEGEND  
 [Symbol] PAVEMENT, DRIVEWAY AND/OR SIDEWALK REMOVAL.

KANSAS DEPARTMENT OF TRANSPORTATION  
**WEBB ROAD**  
**89+50 TO 95+00**  
 PROJECT NO. 87-U-1362-01 SEDGWICK CO.  
**MID-KANSAS ENGINEERING CONSULTANTS, INC.**  
 WICHITA, KANSAS

DESIGNED BY:	GJA	CHECKED BY:	DLH & KJS
DRAWN BY:	DLM	DATE:	SHEET 25 OF 149

WATER VALVE BOX ADJUSTMENTS

STATION	OFFSET	EXISTING ELEV.	PROPOSED ELEV.	NOTES
90+10	26'L	221.16	222.00	W.M.

B.M. #9 "U" CUT ON SOUTHEAST CORNER R.C.B. UNDER WEBB RD.  
 72' RT., STATION 97+38.7  
 ELEV.=219.648

KANSAS GAS & ELECTRIC (K.G.&E.) 264-1141  
 KPL GAS SERVICE CO. 263-7511  
 CITY OF WICHITA WATER DEPARTMENT 268-4908  
 SOUTHWESTERN BELL TELEPHONE CO. 1-571-2611  
 WILLIAMS PIPELINE 524-4390