

SCALE: 1"=20'

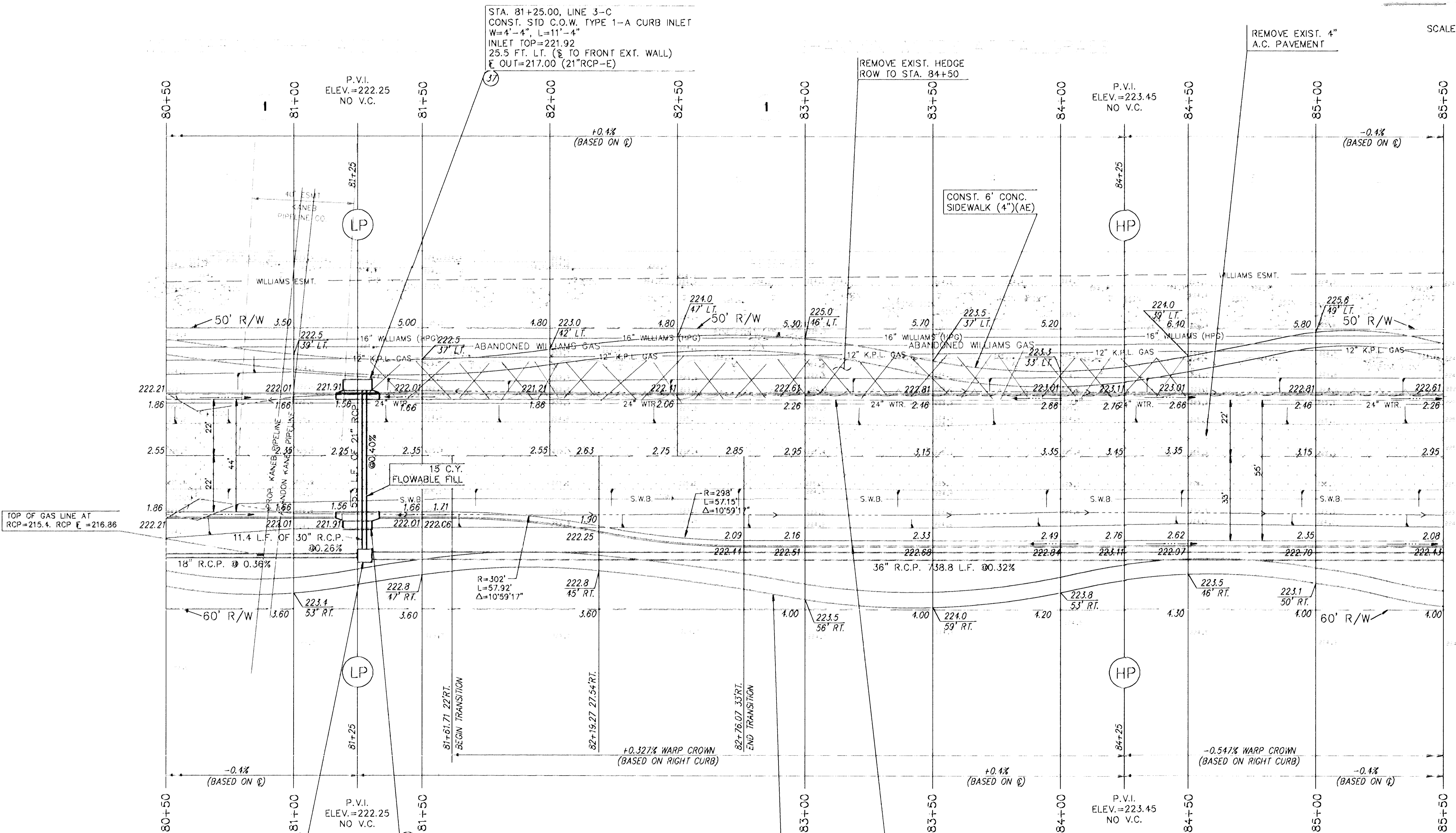

STA. 81+25.00, LINE 3-C
 CONST. STD C.O.W. TYPE 1-A CURB INLET
 W=4'-4", L=11'-4"
 INLET TOP=221.92
 25.5 FT. LT. (8 TO FRONT EXT. WALL)
 E OUT=217.00 (21"RCP-E)

TOP OF GAS LINE AT
 RCP=215.4. RCP E =216.86

STA. 81+27.75, LINE 3 & LINE 3-C
 CONST. REINF. CONC. MANHOLE
 W=5'-2", L=5'-8"
 MANHOLE TOP=222.90
 39.08 FT. RT. (8 TO Q MANHOLE)
 E IN=216.00 (30" RCP-W)
 E IN=217.00 (18" RCP-S)
 E OUT=215.50 (36" RCP-N)

STA. 81+25.00, LINE 3-C
 CONST. STD C.O.W. TYPE 1-A CURB INLET
 W=4'-4", L=11'-4"
 INLET TOP=221.92
 25.5 FT. RT. (8 TO FRONT EXT. WALL)
 E IN=216.78 (21"RCP-W)
 E OUT=216.03 (30"RCP-E)

CONST. 6' CONC.
 SIDEWALK (4")(AE)

CONST. COMB. CURB &
 GUTTER KDOT TYPE 1
 STA. 80+50 TO
 STA. 85+50

KANEB
 KANSAS GAS & ELECTRIC (K.G.&E.) 262-1408
 KPL GAS SERVICE CO. 264-1141
 CITY OF WICHITA WATER DEPARTMENT 263-7511
 SOUTHWESTERN BELL TELEPHONE CO. 268-4908
 WILLIAMS PIPELINE 1-571-2611
 524-4390

WATER VALVE BOX ADJUSTMENTS			
STATION	OFFSET	EXISTING ELEV.	PROPOSED ELEV.
84+05	20'L	222.63	222.50

LEGEND
 PAVEMENT, DRIVEWAY AND/OR
 SIDEWALK REMOVAL.

KANSAS DEPARTMENT OF TRANSPORTATION

WEBB ROAD
80+50 TO 85+50

PROJECT NO. 87-U-1362-01 SEDGMCK CO.
MID-KANSAS ENGINEERING CONSULTANTS, INC.
 WICHITA, KANSAS

DESIGNED BY:	GJA	CHECKED BY:	DLH & KJS
DRAWN BY:	DLH	DATE:	SHEET 21 OF 149