

J:\PROJECTS\2017\150104077_COW_17TH STREET REHAB\150177_CAD\SHOTS\06_CIVIL\GENERAL\15177NT.DWG
 PLOTTED: Friday, May 05, 2017 @ 01:23PM

STREET REHABILITATION FOR

17TH STREET BETWEEN HILLSIDE & OLIVER

CITY OF WICHITA
 SEDGWICK COUNTY, KANSAS
 C.O.W. PROJECT NO. 472-85215
 PAVING O.C.A. NO. 707088
 WATER PROJECT NO. 448-90762
 WATER O.C.A. NO. 636350
 GARY L. JANZEN, P.E. - CITY ENGINEER

Dondlinger - Contractor
K. Kerns - City of Wichita, Field Project Engineer
T. Anthis - City of Wichita, Inspector
 Released Date: 4/30/2018
 Completion Date:
 pdf: 5/1/2018 apr

INDEX TO DRAWINGS

SHEET NO.	DESCRIPTION
1	TITLE SHEET
2	GENERAL NOTES & KEYMAP
3	TYPICAL SECTIONS
4-12	PAVING PLANS
13-14	PAVEMENT REPAIR SCHEDULE
15-18	PAVING DETAILS
19-21	STORM SEWER PLAN & PROFILES
22	STORM SEWER BUBBLE MAP
23-27	STORM SEWER DETAILS
28-30	WATER LINE PLANS & PROFILES
31	WATER BUBBLE MAP
32-34	WATER LINE DETAILS
35	SUMMARY OF QUANTITIES
36-42	EROSION CONTROL PLANS & DETAILS
43-46	PAVEMENT MARKING & SIGNING PLANS & DETAILS
47	CONSTRUCTION SEQUENCE SUMMARY
48-54	TRAFFIC CONTROL PLANS

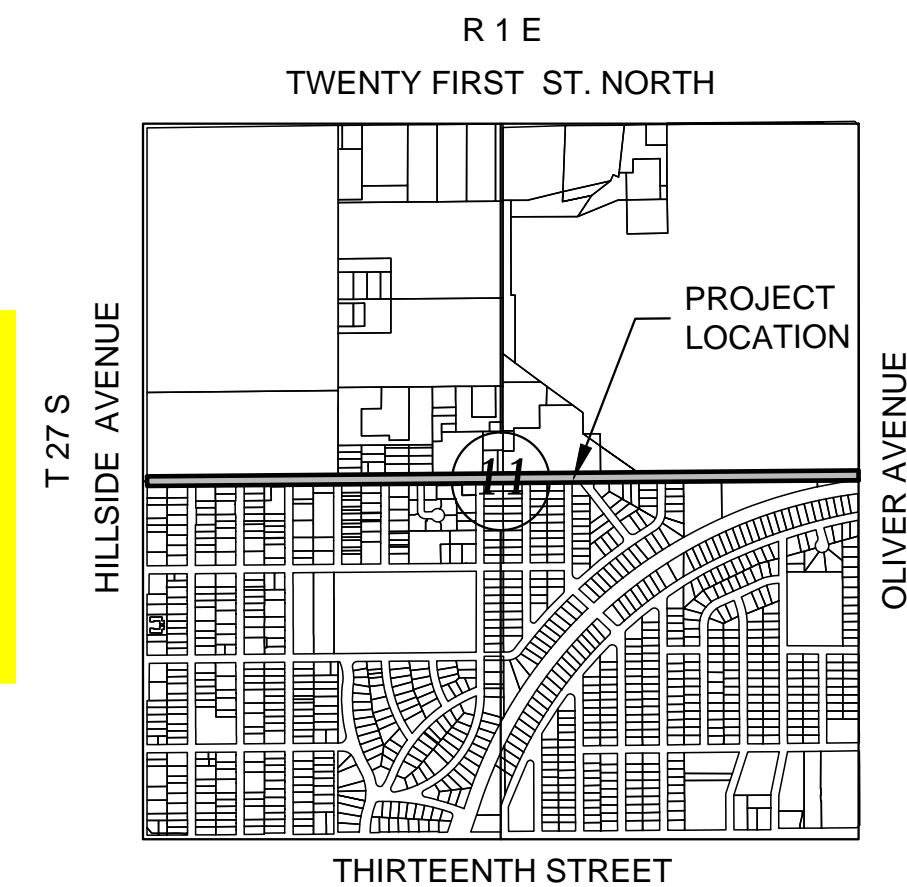

VICINITY MAP

No Scale

STA. 15+00.00 BEGIN
PROJECT NO. 472-85215

STA. 61+36.50 END
PROJECT NO. 472-85215

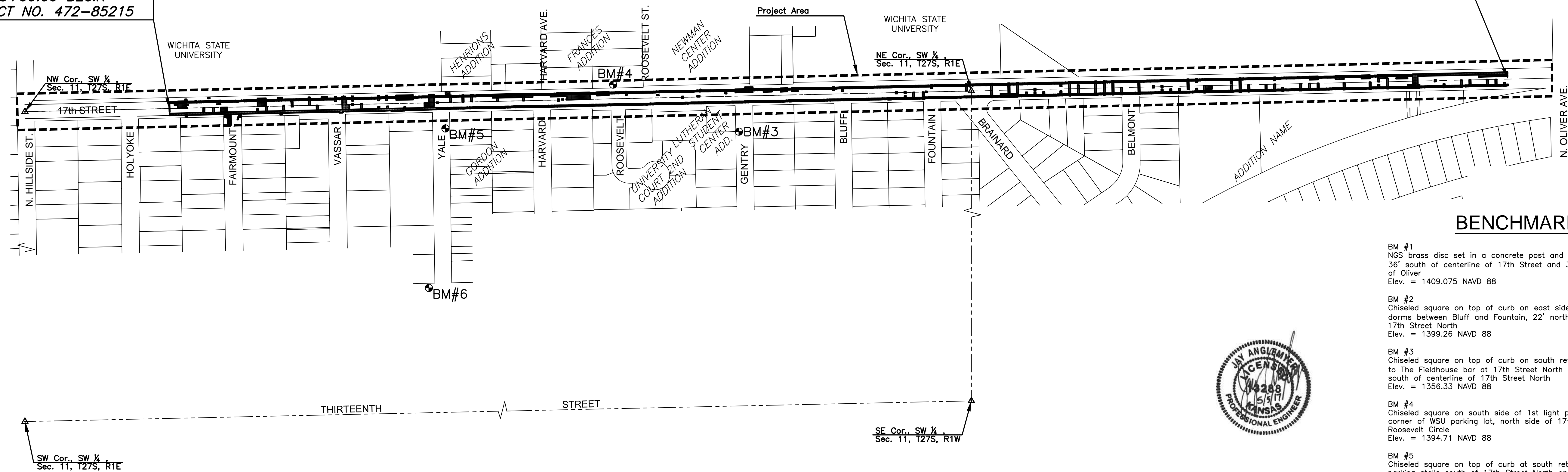

BENCHMARKS

- BM #1**
 NGS brass disc set in a concrete post and stamped P 39 1934, 36' south of centerline of 17th Street and 32' West of centerline of Oliver
 Elev. = 1409.075 NAVD 88
- BM #2**
 Chiseled square on top of curb on east side of entrance to old dorms between Bluff and Fountain, 22' north of north curb of 17th Street North
 Elev. = 1399.26 NAVD 88
- BM #3**
 Chiseled square on top of curb on south return to east entrance to The Fieldhouse bar at 17th Street North and Gentry, 105' south of centerline of 17th Street North
 Elev. = 1356.33 NAVD 88
- BM #4**
 Chiseled square on south side of 1st light pole west of southeast corner of WSU parking lot, north side of 17th Street North at Roosevelt Circle
 Elev. = 1394.71 NAVD 88
- BM #5**
 Chiseled square on top of curb at south return of 1st set of parking stalls south of 17th Street North on east side of Yale
 Elev. = 1382.175 NAVD 88
- BM #6**
 Chiseled square on top of north curb of 16th Street North, 10' +/- west of curb inlet on northwest corner of Yale and 16th Street North
 Elev. = 1376.235 NAVD 88
- BM #7**
 Chiseled square on southeast corner of sidewalk, approximately 60' west of west edge of Paradise Baptist Church parking lot
 Elev. = 1408.22 NAVD 88
- BM #8**
 Chiseled square on top of curb, 19' southeast of south end of curb return on southeast corner of 17th Street and Brainard, in front of fire hydrant
 Elev. = 1399.81 NAVD 88
- BM #9**
 Chiseled square on top of curb at south end of curb return on southeast corner of 17th Street and Fairmount
 Elev. = 1394.29 NAVD 88

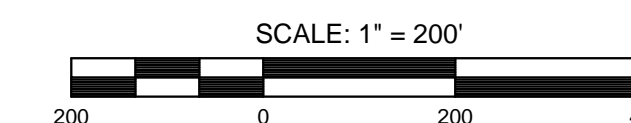

STREET REHABILITATION FOR
17TH STREET BETWEEN HILLSIDE & OLIVER
 WICHITA, KS

©2017
 MKEC Engineering
 All Rights Reserved
 www.mkec.com
 These drawings and their contents, including, but not limited to, all concepts, designs, & ideas are the exclusive property of MKEC Engineering (MKEC), and may not be used or reproduced in any way without the express consent of MKEC.

TITLE SHEET

PROJECT NO.	472-85215	
DATE	5/3/2017	
SCALE	AS SHOWN	
DESIGNED	DRAWN	CHECKED
JRA	BKS	JRA
NO.	REVISION	DATE

SHEET NO.
1 OF 54