

FHWA REGION NO.	STATE	PROJECT NO.	FISCAL YEAR	SHEET NO.	TOTAL SHEETS
7	KANSAS	87N-0094-01	1998	7	202

Scale: 1:200 (Horizontal)  
Scale: 1:20 (Vertical)

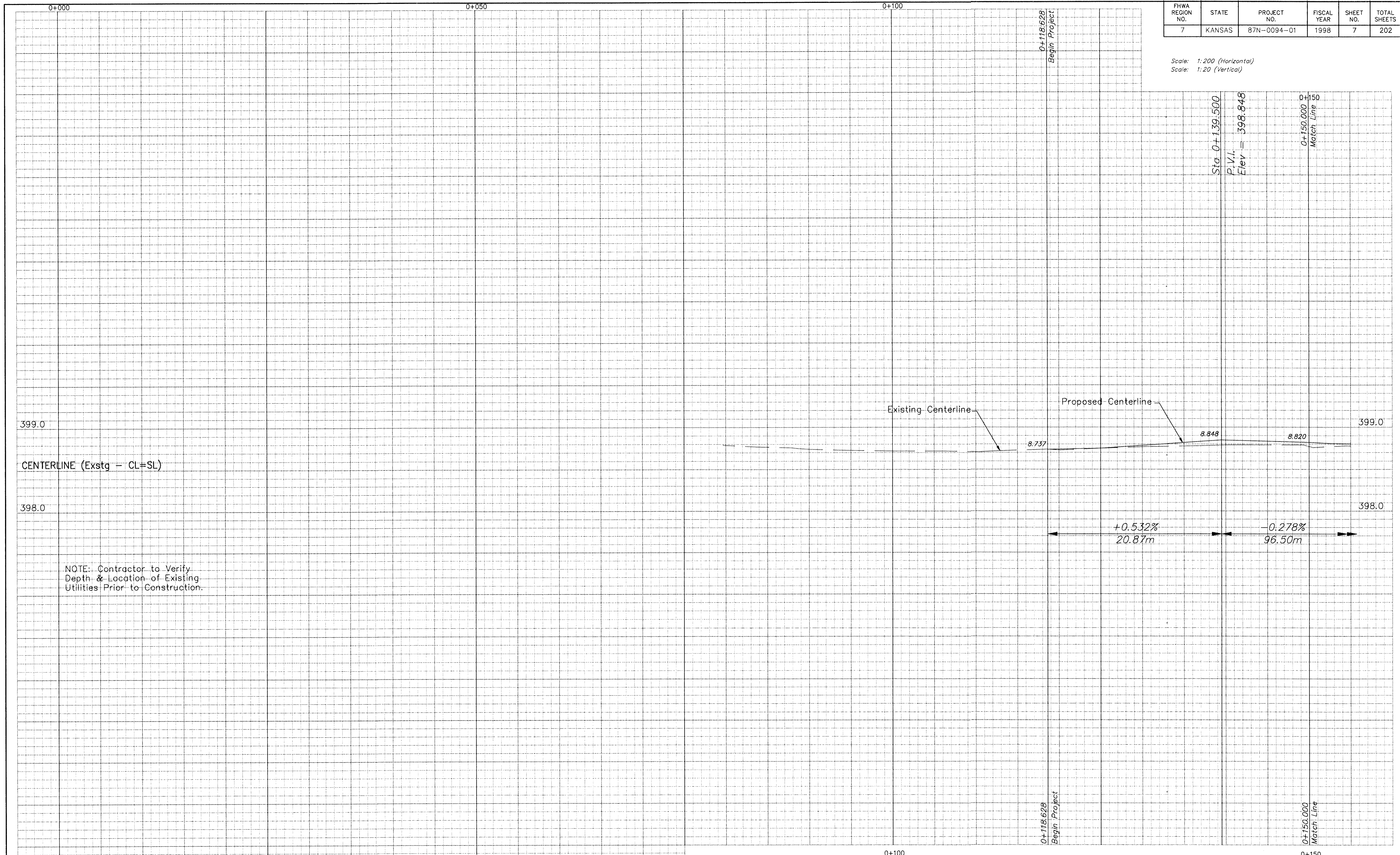

399.0  
CENTERLINE (Exstg - CL=SL)

398.0

NOTE: Contractor to Verify  
Depth & Location of Existing  
Utilities Prior to Construction.

Existing Centerline Proposed Centerline  
8.737 8.848 8.820  
+0.532% 20.87m -0.278% 96.50m  
0+118.628 Begin Project  
0+139.500 P.V.I. Elev = 398.848  
0+150.000 Match Line

0+000

0+050

0+100

0+150

PROJECT NUMBER <b>472 - 82908</b>					PROJ NUMBER 95 05 E026
DESIGN STAFF	DRAWN SONNY	APPROVED JFB	DATE NOV 98	SCALE NOTED	DIRECTOR CENTZOO SHEET NAME XS01

CAPITAL IMPROVEMENT PROJECT  
**CENTRAL AVENUE**  
Sta 0+000.0 to Sta. 0+150.0

**BAUGHMAN COMPANY P.A.**  
ENGINEERING, SURVEYING, & PLANNING  
316-282-7271 • 315 ELLIS • WICHITA, KANSAS 67211

SHEET  
7  
OF  
202