

| FHWA REGION NO. | STATE | PROJECT NO. | FISCAL YEAR | SHEET NO. | TOTAL SHEETS |
|-----------------|--------|-------------|-------------|-----------|--------------|
| 7 | KANSAS | 87N-0094-01 | 1998 | 9 | 202 |

Scale: 1:200 (Horizontal)
Scale: 1:20 (Vertical)

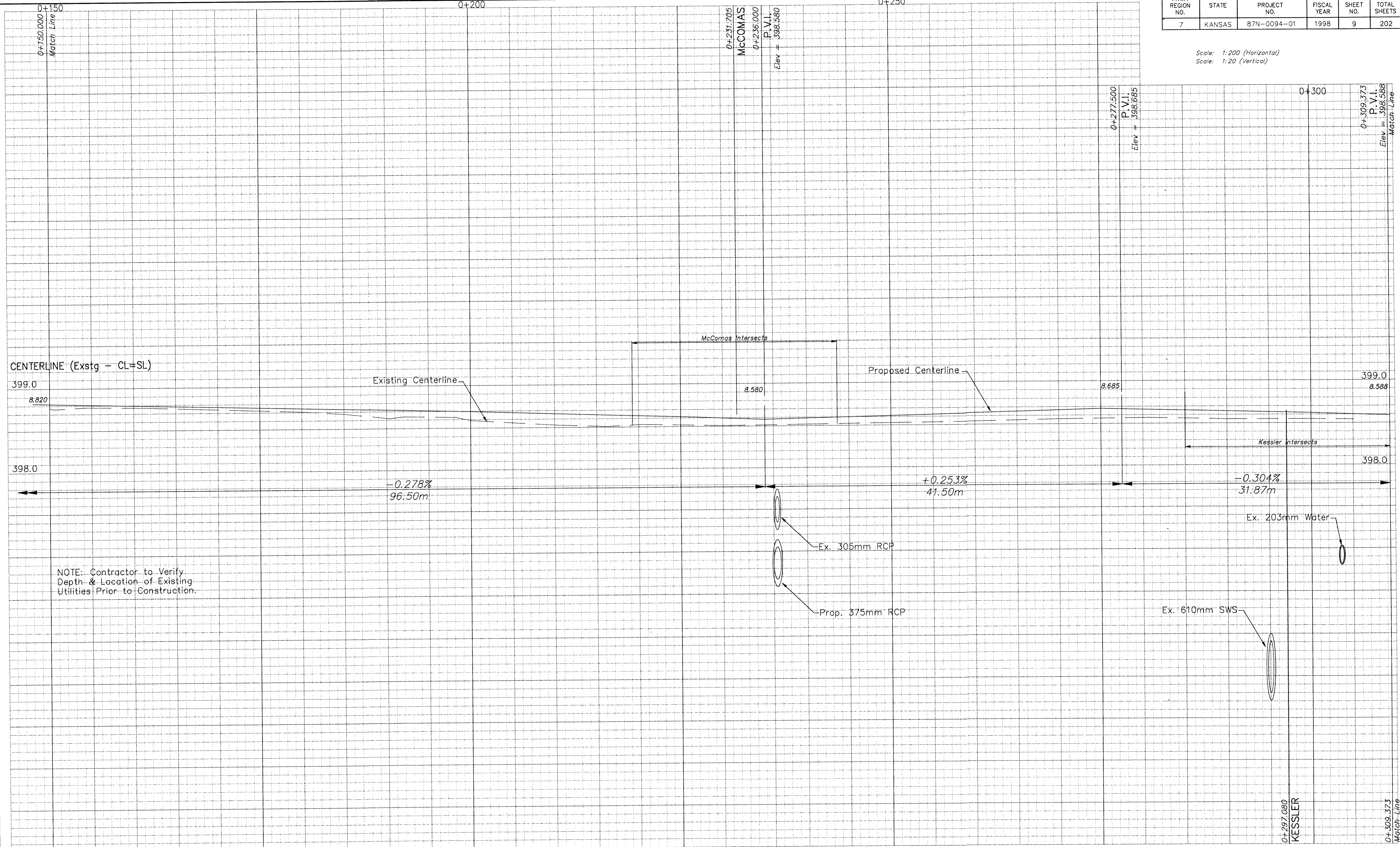

CENTERLINE (Exstg - CL=SL)

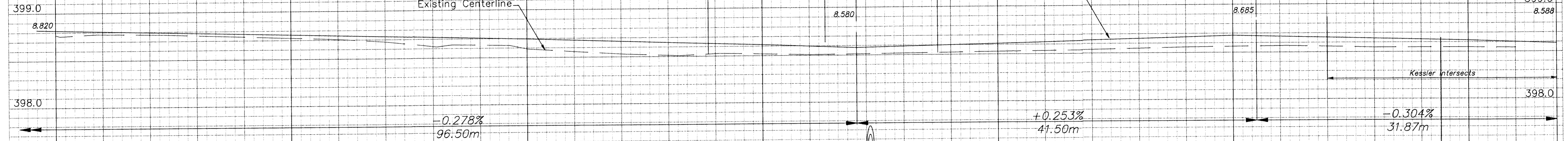

NOTE: Contractor to Verify Depth & Location of Existing Utilities Prior to Construction.

| | | | | | |
|--|----------------|-----------------|----------------|--|---------------------|
| PROJECT NUMBER 472 - 82908 | | | | PROJ NUMBER 95 05 E028 | |
| DESIGN STAFF | DRAWN SONNY | APPROVED JFB | DATE NOV 98 | SCALE NOTED | DIRECTOR CENTZOO |
| CAPITAL IMPROVEMENT PROJECT CENTRAL AVENUE Sta. 0+150.0 to Sta. 0+309.373 | | | | BAUGHMAN COMPANY P. A. ENGINEERING, SURVEYING, & PLANNING 318-282-7271 • 315 ELLIS • WICHITA, KANSAS 67211 | |