

BENCHMARK:
 City of Wichita Benchmark Disk
 at South End of Hubguard on the
 SW Cor. of R.C.B.C., West Side of
 Rock Road, 706' North-northwest
 of the Northwest Corner of Lot
 44, Block A, Rocky Ford Addition.
 Elev. = 1368.14 NAVD88

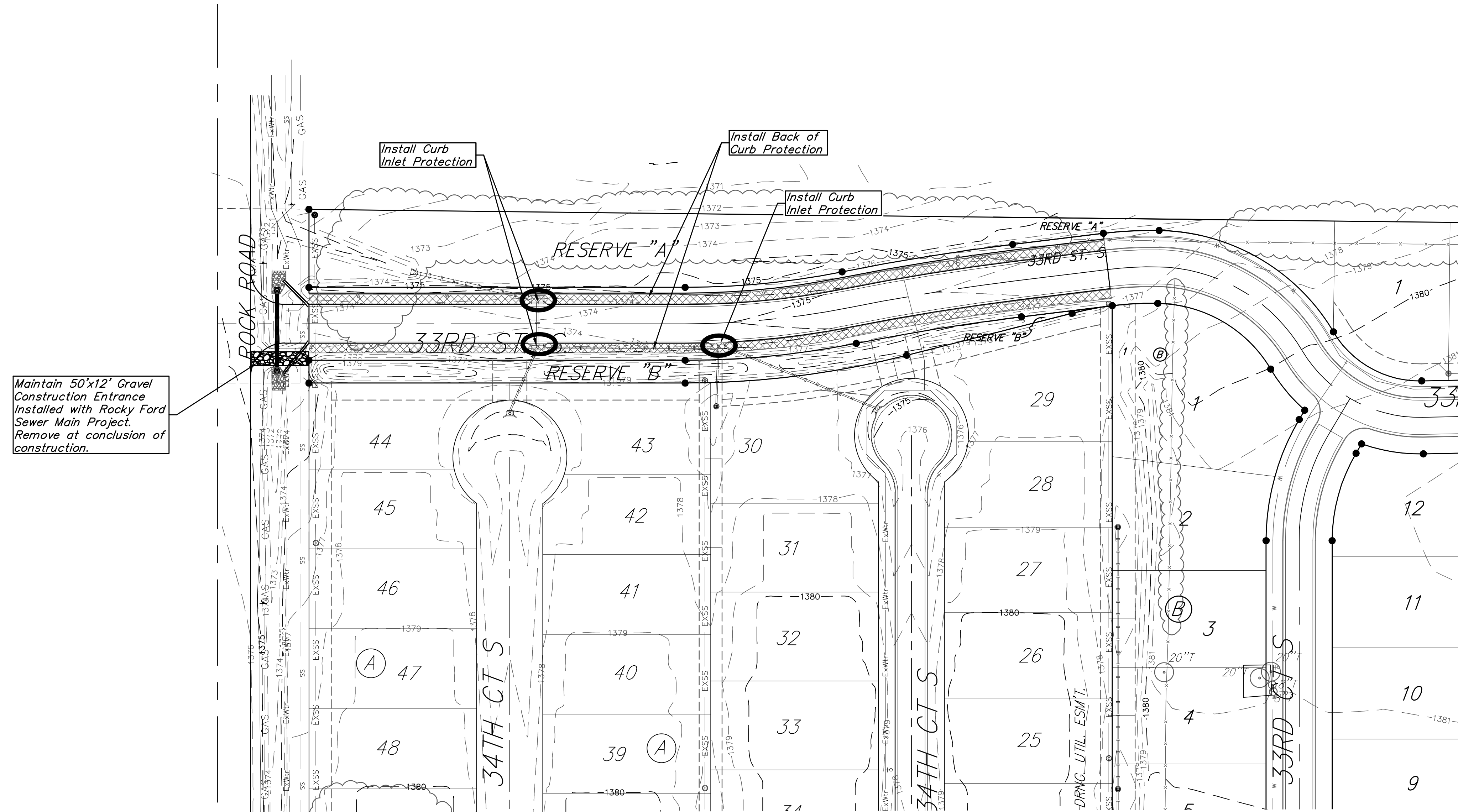
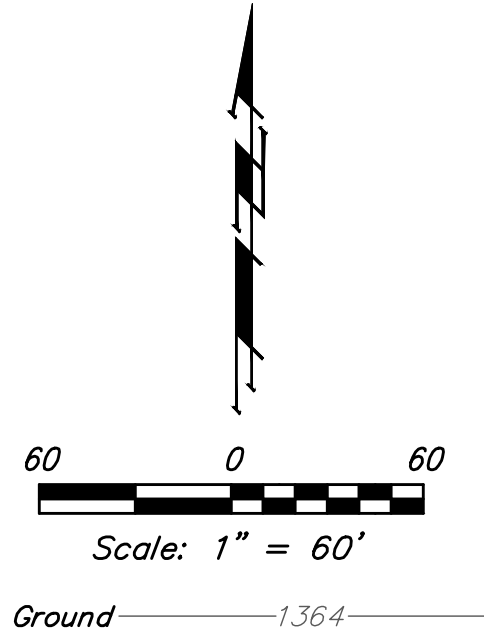
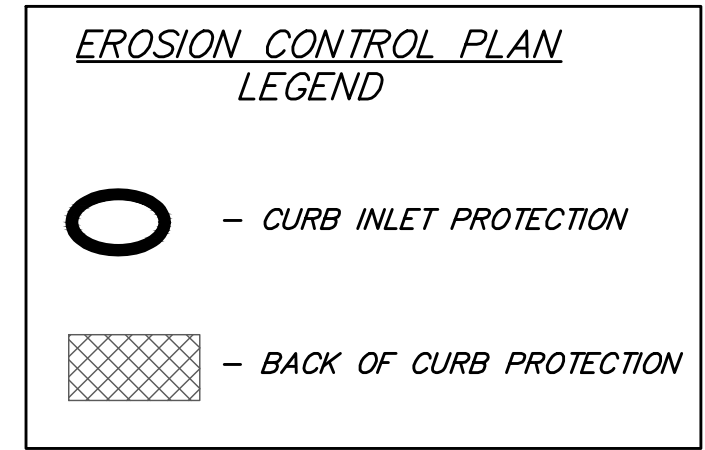

- NOTES:**
- Contractor shall make sure all erosion control is in place before project is accepted. This plan represents the minimum standard. Any additional erosion control measures shall be installed by the Contractor as needed.
 - Removal of Gravel Construction Entrance for pavement construction shall be included in bid item "Site Restoration"
 - All areas disturbed by construction are to be as follows:
 (Permanent Seeding)
 SEED -- Kansas Premium Fescue Blend: 8 Lbs/1,000 Sq. Ft.
 Rye grass (PLS): 3 Lbs/1,000 Sq. Ft.
 FERTILIZER -- 12-24-12 Ratio at 350 Lbs/Acre
 MULCH -- 2 Tons Prairie Hay / Acre (where erosion control mat is not installed)
 All costs associated with seeding including perpetration of ground, seeding, fertilizing, mulching, shall be including in the L.S. bid item "Seeding"
 - This plan is not to be used as a comprehensive grading plan. all spot elevations are proposed & subject to change.

EROSION CONTROL MEASURE	INSTALL	MAINTAIN
CONSTRUCTION ENTRANCE (EA)	0	1
BACK OF CURB PROTECTION (LF)	1,410	0
CURB INLET PROTECTION (EA)	3	0

* ALL EXISTING BMPs INCLUDING CONSTRUCTION ENTRANCE, SEDIMENT BARRIERS, SILT FENCE, CUT-OFF TRENCH, AND EROSION CONTROL MAT SHALL BE MAINTAINED AND REPAIRED IF NECESSARY.

All areas disturbed during construction shall be seeded, mulched, and fertilized as per Cover Sheet General Notes.



Baughman Rocky Ford 2nd Addition
EROSION CONTROL
 Street Improvements

Baughman Company, P.A. 315 Ellis St. Wichita, KS 67211 P 316-262-7271 F 316-262-0149
 ENGINEERING | SURVEYING | PLANNING | LANDSCAPE ARCHITECTURE

PROJECT NUMBER 472-85384	DESIGN DMV	DRAWN JAK
REVISIONS:	APPROVED 1-30-18	DATE 2/15/16
	SCALE Noted	SHEET

7 OF 16