

**BENCHMARK:**  
 City of Wichita Benchmark Disk at  
 South End of Hubguard on the SW  
 Cor. of R.C.B.C., West Side of Rock  
 Road, 706' North-northwest of the  
 Northwest Corner of Lot 44, Block  
 A, Rocky Ford Addition.  
 Elev. = 1368.14 NAVD88

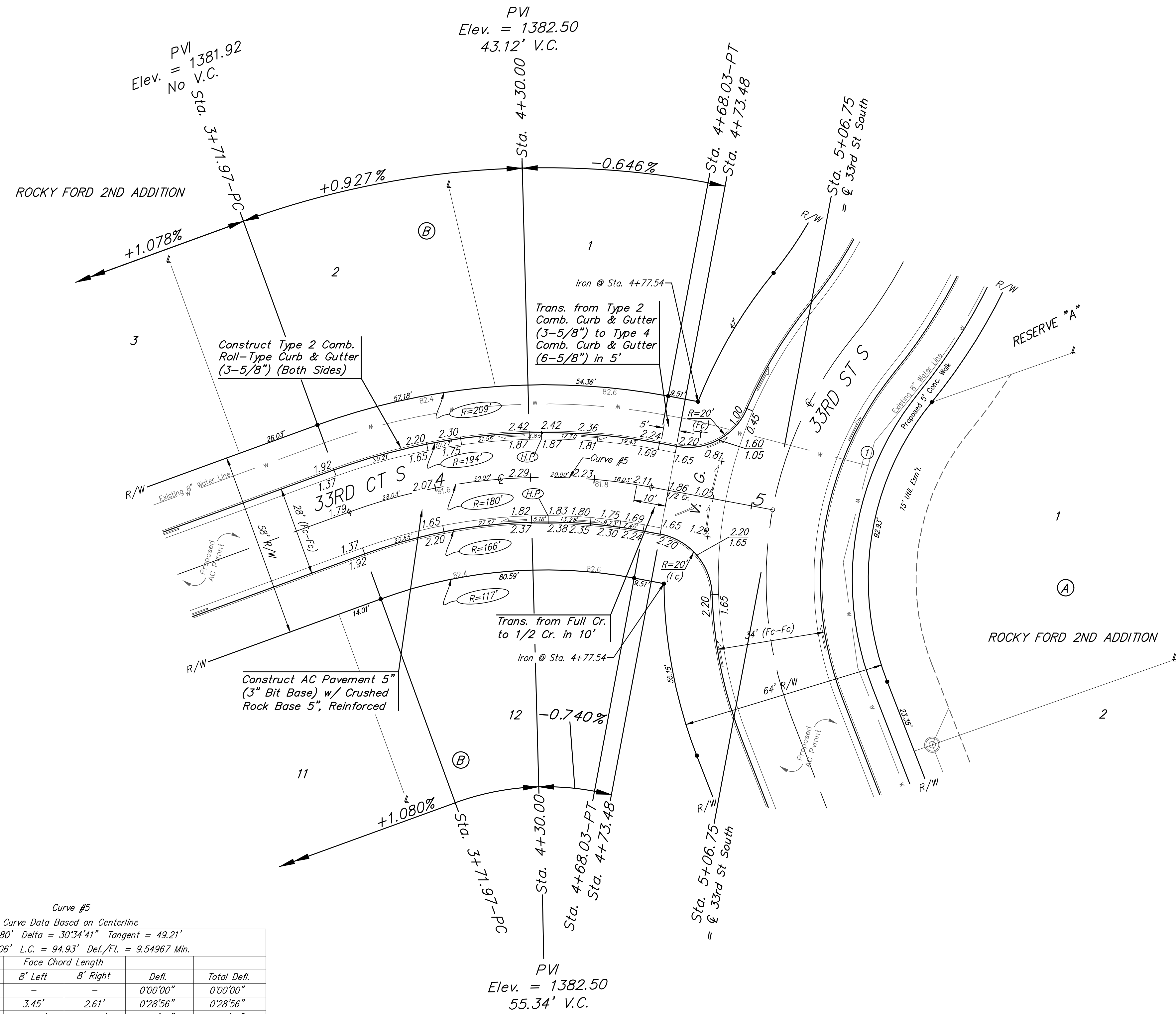
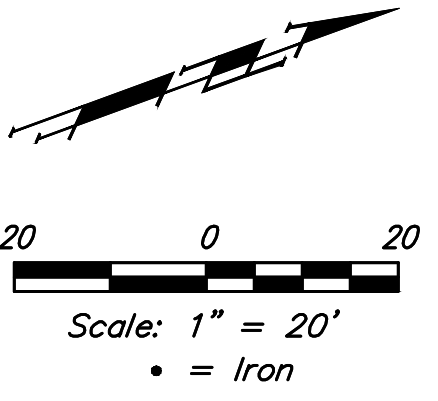

Curve #5  
 Curve Data Based on Centerline

Rad. = 180' Delta = 30°34'41" Tangent = 49.21'  
 Arc = 96.06' L.C. = 94.93' Def./ft. = 9.54967 Min.

Station	Arc	Face Chord Length		Defl.	Total Defl.
		8' Left	8' Right		
3+71.97	-	-	-	0°00'00"	0°00'00"
3+75.00	3.03'	3.45'	2.61'	0°28'56"	0°28'56"
4+00.00	25.00'	28.45'	21.51'	3°58'45"	4°27'41"
4+25.00	25.00'	28.45'	21.51'	3°58'44"	8°26'25"
4+50.00	25.00'	28.45'	21.51'	3°58'45"	12°25'10"
4+68.03	18.03'	20.53'	15.52'	2°52'11"	15°17'21"



Roll type curb & gutter to be constructed on the pavement on this sheet.  
 Top of curb elevation are given for full height curb.

<b>Baughman</b>		Rocky Ford 2nd Addition - Phase I	
		<b>33RD CT SOUTH</b>	
		Sta. 3+71.97 to Sta. 5+06.75	
Baughman Company, P.A. 315 Ellis St. Wichita, KS 67211 P 316-262-7271 F 316-262-0149			
ENGINEERING   SURVEYING   PLANNING   LANDSCAPE ARCHITECTURE			
PROJECT NUMBER 472-85430	DESIGN DMV	DRAWN JAK	
REVISIONS:	APPROVED	DATE 2/18	
	SCALE Noted	SHEET	
			<b>10 OF 27</b>