

BENCHMARK:
 City of Wichita Benchmark Disk at
 South End of Hubguard on the SW
 Cor. of R.C.B.C., West Side of Rock
 Road, 706' North-northwest of the
 Northwest Corner of Lot 44, Block
 A, Rocky Ford Addition.
 Elev. = 1368.14 NAVD88

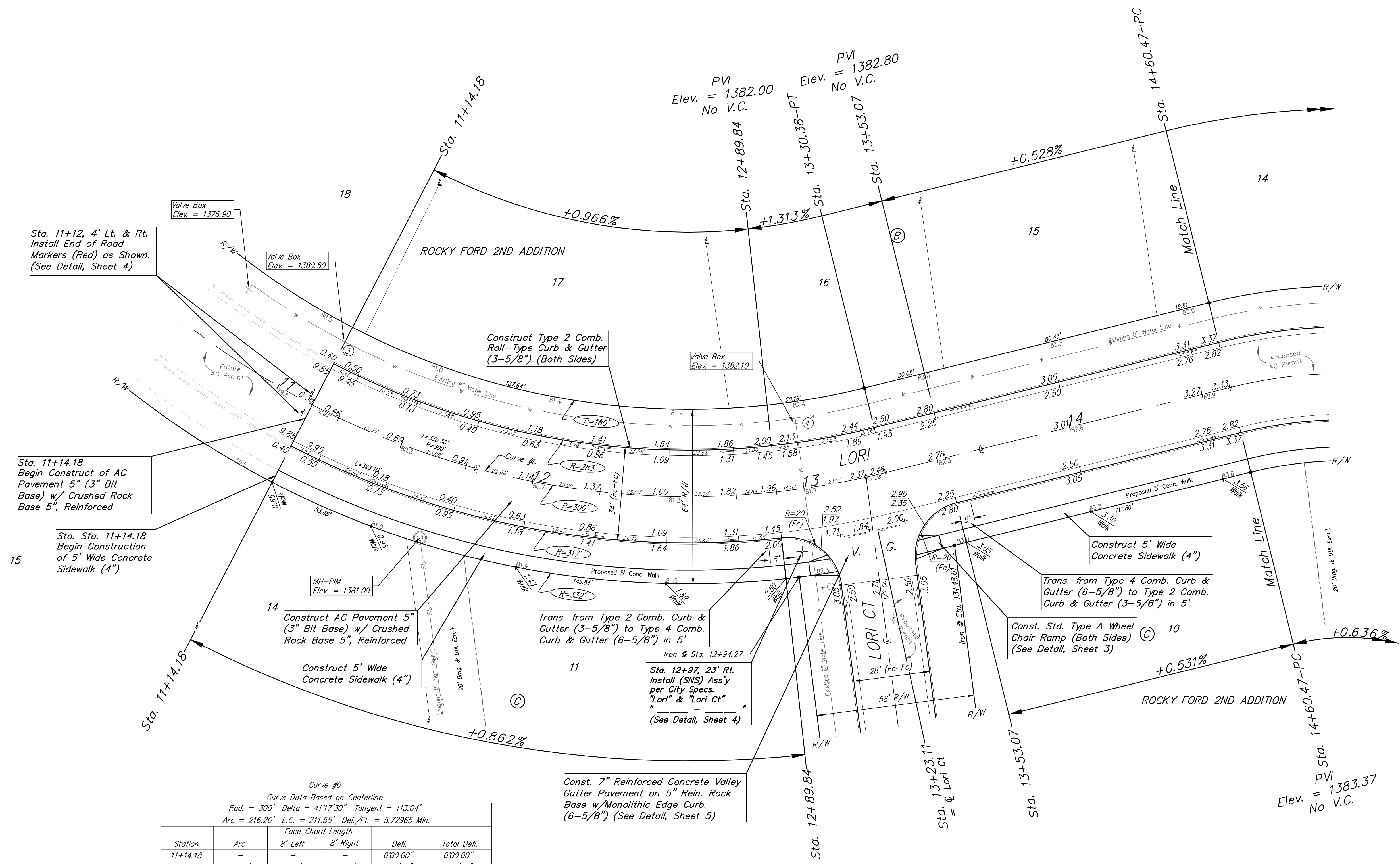
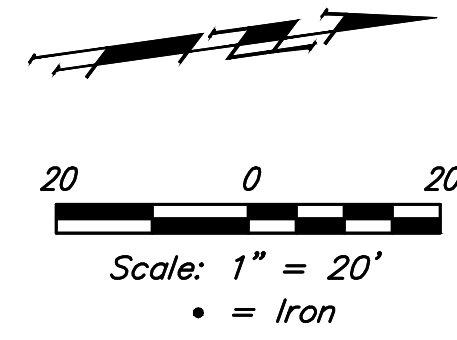

Curve #6
 Curve Data Based on Centerline
 Rad. = 300' Delta = 417'30" Tangent = 113.04'
 Arc = 216.20' L.C. = 211.55' Def./Ft. = 5.72965 Min.

Station	Arc	Face Chord Length		Defl.	Total Defl.
		8' Left	8' Right		
11+14.18	-	-	-	0'00"00"	0'00"00"
11+25.00	10.82'	9.92'	11.72'	1'02"00"	1'02"00"
11+50.00	25.00'	22.91'	27.08'	2'23"14"	3'25"14"
11+75.00	25.00'	22.91'	27.08'	2'23"15"	5'48"29"
12+00.00	25.00'	22.91'	27.08'	2'23"14"	8'11"43"
12+25.00	25.00'	22.91'	27.08'	2'23"15"	10'34"58"
12+50.00	25.00'	22.91'	27.08'	2'23"14"	12'58"12"
12+75.00	25.00'	22.91'	27.08'	2'23"15"	15'21"27"
12+89.84	14.84'	13.60'	16.08'	1'25"01"	16'46"28"
13+00.00	10.16'	9.31'	11.01'	0'58"13"	17'44"41"
13+25.00	25.00'	22.91'	27.08'	2'23"14"	20'07"55"
13+30.38	5.38'	4.93'	5.83'	0'30"50"	20'38"45"

Const. 7" Reinforced Concrete Valley
 Gutter Pavement on 5" Rein. Rock
 Base w/ Monolithic Edge Curb.
 (6-5/8") (See Detail, Sheet 5)

Roll type curb & gutter to
 be constructed on the pavement
 on this sheet.
 Top of curb elevation are given
 for full height curb.



Baughman Rocky Ford 2nd Addition - Phase I
LORI
 Sta. 11+14.18 to Sta. 14+60.47

Baughman Company, P.A. 315 Ellis St. Wichita, KS 67211 P 316-262-7271 F 316-262-0149
 ENGINEERING | SURVEYING | PLANNING | LANDSCAPE ARCHITECTURE

PROJECT NUMBER: 472-85430 DESIGN: DMV DRAWN: JAK
 REVISIONS: APPROVED: DATE: 2/18
 SCALE: Noted SHEET: 11 OF 27

E:\Projects\Rocky Ford 2nd Addition_Engineering\Phase I\Str. 17-12-8993\STR PLANS.DWG