

J:\PROJECTS\2017\1701010567\_COW\_STRYKER\_170567\_CAD\SH1505\_DUALPAV\SIDEWALK AND FENCING\170567\_05\_1201.DWG  
 PLOTTED: Wednesday, May 02, 2018 @ 02:59PM

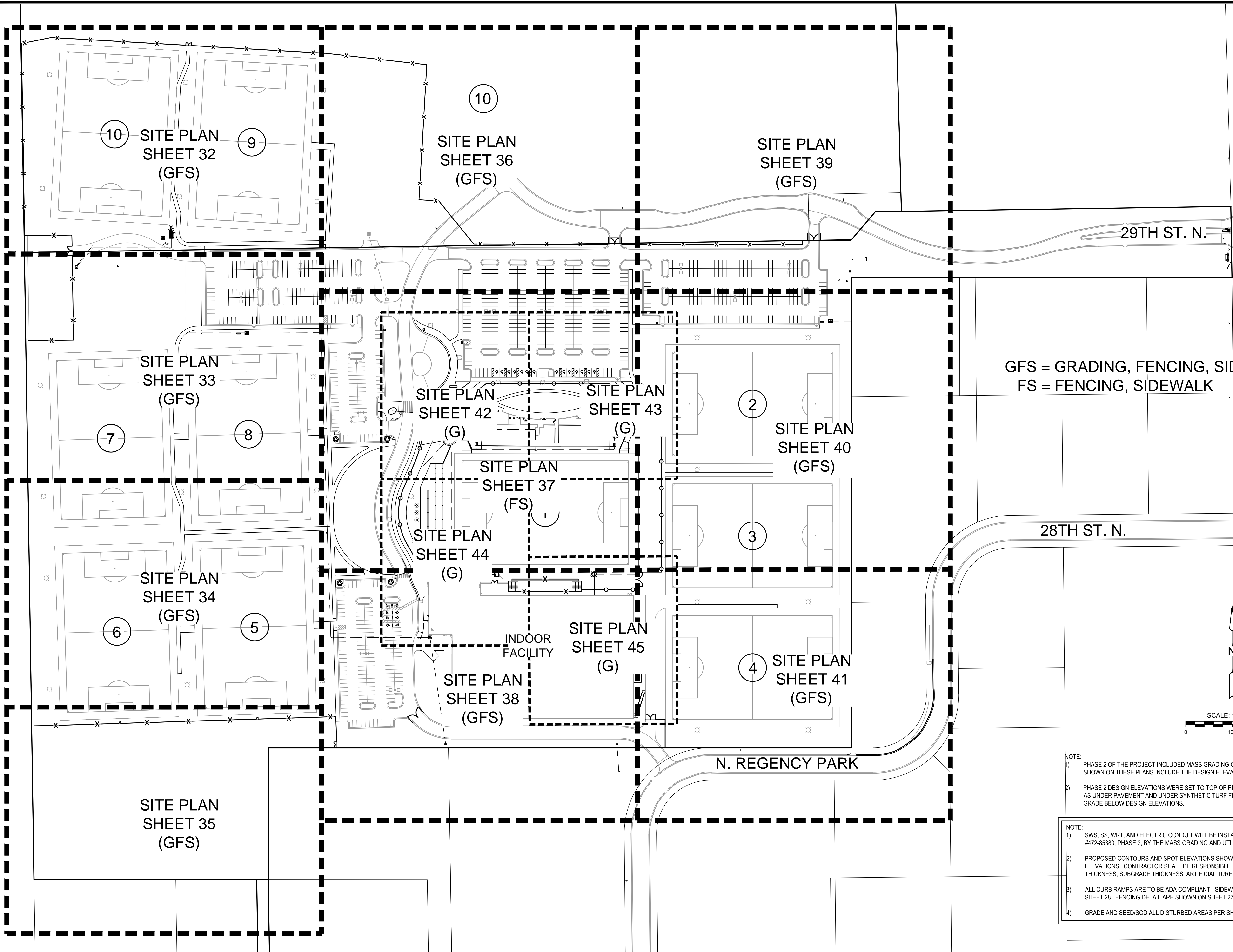

GFS = GRADING, FENCING, SIDEWALK  
 FS = FENCING, SIDEWALK

- NOTE:
- PHASE 2 OF THE PROJECT INCLUDED MASS GRADING OF THE SITE. THE EXISTING GROUND CONTOURS SHOWN ON THESE PLANS INCLUDE THE DESIGN ELEVATIONS ASSOCIATED WITH THE PHASE 2 WORK.
  - PHASE 2 DESIGN ELEVATIONS WERE SET TO TOP OF FINISHED SURFACE. IN SOME LOCATIONS, SUCH AS UNDER PAVEMENT AND UNDER SYNTHETIC TURF FIELDS, MASS GRADING OPERATIONS WILL LEAVE GRADE BELOW DESIGN ELEVATIONS.
- NOTE:
- SWS, SS, WRT, AND ELECTRIC CONDUIT WILL BE INSTALLED BY THE CITY OF WICHITA PROJECT #472-85380, PHASE 2, BY THE MASS GRADING AND UTILITY PROJECT
  - PROPOSED CONTOURS AND SPOT ELEVATIONS SHOWN ON THESE PLANS ARE FINAL SURFACE ELEVATIONS. CONTRACTOR SHALL BE RESPONSIBLE FOR MAKING ADJUSTMENTS FOR PAVEMENT THICKNESS, SUBGRADE THICKNESS, ARTIFICIAL TURF THICKNESS, MISC. REMOVALS, ETC.
  - ALL CURB RAMPS ARE TO BE ADA COMPLIANT. SIDEWALK AND CURB RAMP DETAILS ARE SHOWN ON SHEET 28. FENCING DETAIL ARE SHOWN ON SHEET 27.
  - GRADE AND SEED/SOD ALL DISTURBED AREAS PER SHEET 53-63.



PAVING, LANDSCAPE & UTILITIES FOR  
**STRYKER SPORTS**  
 WICHITA, KANSAS

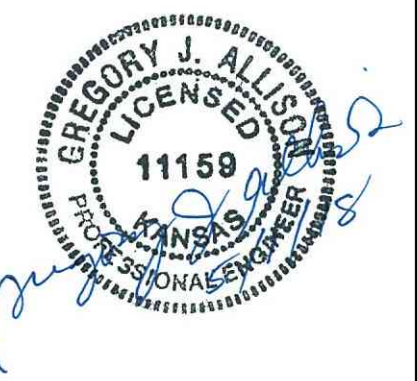

©2018 MKEC Engineering All Rights Reserved www.mkec.com  
 These drawings and their contents, including, but not limited to, all concepts, designs, & ideas are the exclusive property of MKEC Engineering (MKEC), and may not be used or reproduced in any way without the express consent of MKEC.

**SITE PLAN LAYOUT MAP**

PROJECT NO.	1701010567	
DATE	MAY 2, 2018	
SCALE	1" = 30'	
DESIGNED	DRAWN	CHECKED
JAG	CRM	MAB
ISSUED FOR CONST. NO.	05-02-18	DATE
REVISION		