

FHWA REGION NO.	STATE	PROJECT NO.	FISCAL YEAR	SHEET NO.	TOTAL SHEETS
7	KANSAS	87N-0094-01	1998	139	202

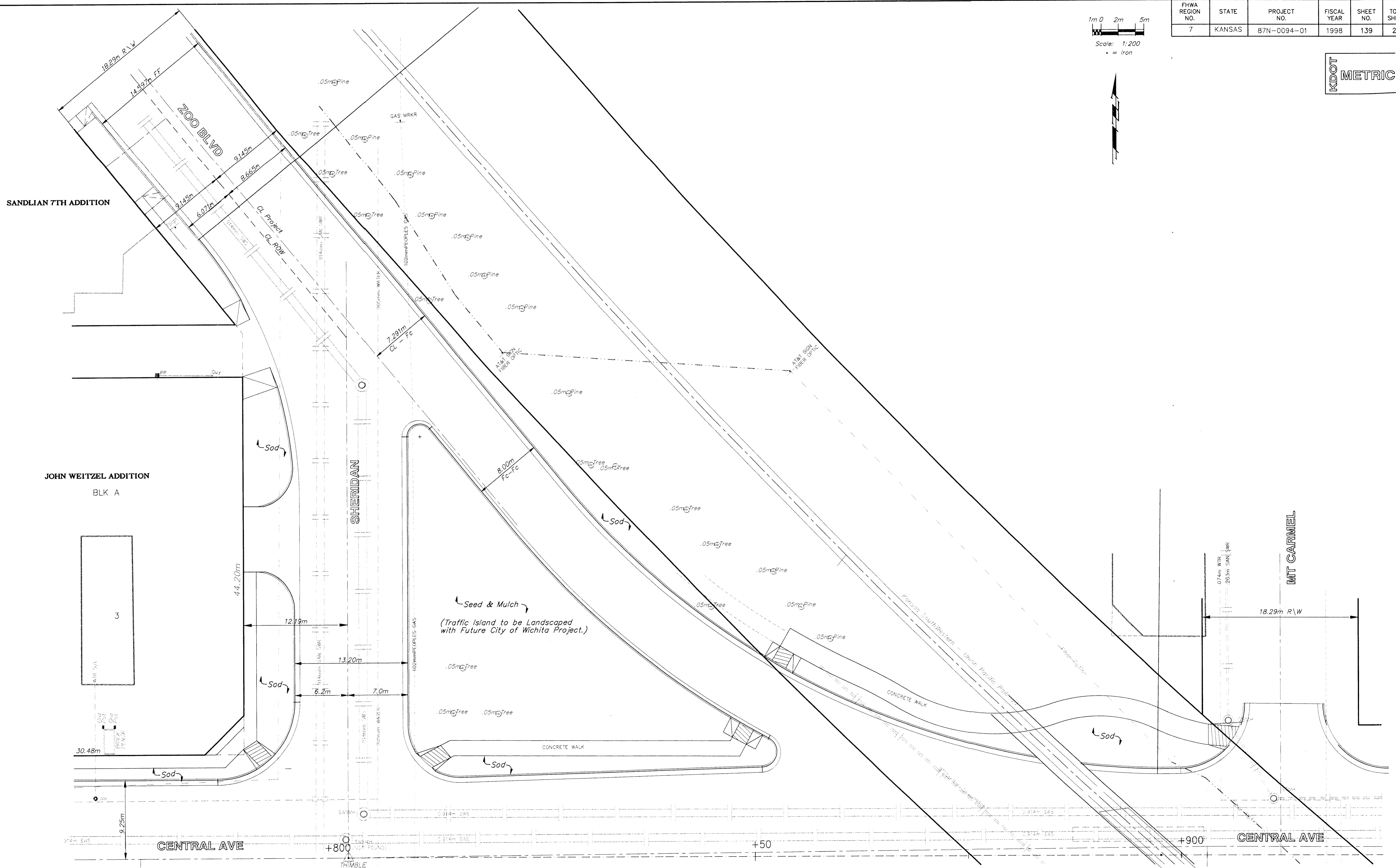
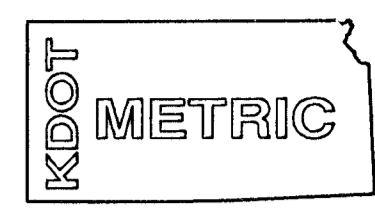
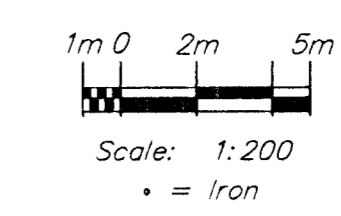

SANDLIAN 7TH ADDITION

JOHN WEITZEL ADDITION
BLK A

Seed & Mulch
(Traffic Island to be Landscaped
with Future City of Wichita Project.)

PROJECT NUMBER 472 - 82908				
DESIGN JUL	DRAWN KWR	APPROVED PJM	DATE NOV 98	SCALE NOTED

PROJ NUMBER 99 05 E026
DIRECTOR CENTZOO
SHEET NAME LSCAPE13

ZOO @ CENTRAL
LANDSCAPING PLANS
Free-flow RT Lane \ Central onto Zoo

BAUGHMAN COMPANY P. A.
ENGINEERING, SURVEYING, & PLANNING
316-282-7271 • 315 ELLIS • WICHITA, KANSAS 67211

SHEET
139
OF
202