

GENERAL NOTES:

- The Contractor shall comply with all applicable safety regulations. All construction shall be completed following current City Standard Specifications and Special Provisions.
- Contractor will be required to provide notice to utility companies a minimum of seventy-two (72) hours prior to any excavation, as follows:

Kansas One-Call	687-2470
-----------------	----------

The Contractor must notify the following in case of an emergency:

AT&T	1-800-246-8464
Black Hills Energy	1-800-694-8989
City of Wichita Water & Sewer Dept.	1-316-219-8921
City of Wichita Stormwater	1-316-268-4090
City of Wichita Traffic	1-316-268-4034
Cox Communications	1-888-249-3530
Kansas Gas Service	1-888-482-4950
Westar Energy	1-800-544-4857
- Utility service lines, poles, etc. are to be adjusted as necessary by others prior to construction unless the plans specifically call for their adjustment by the Contractor or unless the plans specifically identify a utility to be adjusted by its owner during construction. Existing utilities and their location, as shown on the plans, represent the best information obtainable for design. The Contractor will be required to work around existing utilities within the right-of-way which do not conflict with proposed construction.
- Rubble from the removal of miscellaneous structures and excess excavation which is to be wasted shall be disposed of on sites to be provided by the Contractor. These sites shall be approved by the Engineer as to suitability, appearance and site location. Locations, in the opinion of the Engineer, that will leave an unsightly appearance will not be approved. All disposal sites must be approved by the Kansas Department of Health and Environment. Material either stockpiled or disposed of in a flood plain will require a Kansas State Board of Agriculture permit. Any material dumped in waters of the United States or wetlands is subject to U.S. Corps of Engineers permitting regulations. Any material buried or stockpiled beyond approved construction limits will require additional archaeological investigations unless buried in a previously approved borrow location.
- Trees and shrubs in public right-of-way which are in direct conflict with proposed new construction shall be removed by the Contractor with the Engineer's approval. Trees and shrubs which are not in direct conflict with proposed new construction shall be saved and protected from damage.
- The Contractor shall give all property owners and/or tenants of developed property abutting the construction of this project a minimum of ten (10) days notice prior to start of construction.
- The Contractor shall be responsible for preserving property irons. The Contractor will be required to re-establish any property irons which are damaged or destroyed by his construction operations. Such irons shall be re-established by a licensed land surveyor in accordance with state laws.
- If traffic will be impacted by construction, a traffic control plan must be submitted and approved by the City Traffic Engineer, Brian Coon at traffic@wichita.gov before construction can begin. The Contractor shall be responsible for all traffic control measures to facilitate construction. All construction zone markings and signage shall conform to the latest version of the Manual on Uniform Traffic Control Devices (MUTCD) as published by the US Dept. of Transportation, Federal Highway Administration. All costs associated with construction markings and signage shall be the Contractors responsibly.
- All elevations shown are NAVD 88.
- The Contractor shall protect from damage and support existing utilities through constructions as approved by the utility owner and the Engineer at the contractors expense.
- Contractor shall limit the extent of trench openings overnight and weekends to less than 50 feet.
- Any sidewalk, drive approach, curb, or street pavement removed to construct project must have a pavement cut permit and be replaced by the City contractor. Permits can be obtained by calling 316-268-4501 or 316-268-4480.
- No shrink or swell factors have been applied to the earthwork quantities shown on this project. All earthwork quantities are based on raw surface volume comparisons.

- Excess dirt generated from installation of underground utilities is to be used in Earthwork activities on site.
- The top 6" of topsoil is to be stripped and stockpiled. Topsoil to be used to finish the grading (top 6") in all areas except street rights-of-way, and adjacent to the existing lake. All grading within 20' of the existing lake is to be left as exposed sand.
- Additional items such as brush piles in Northwest corner, pipe sticking out of ground on the West peninsula, concrete blocks at pipe line crossing around North property line and misc. trees, etc. shall be considered subsidiary to "Site Clearing."
- Reserve "A" shall be seeded with permanent seeding. All other disturbed areas may be seeded with temporary seeding. All seeding per City of Wichita Standards.

Benchmarks

BENCHMARK:
CHISELED SQUARE WITH DIVOT ON CONCRETE PAD, 1655' NORTH AND 888' EAST OF THE SOUTHEAST CORNER OF THE SW 1/4 OF SEC. 2, T27S, R1W.
ELEVATION = 1323.11 (NAVD88, G12A)

BENCHMARK:
CHISELED SQUARE WITH DIVOT ON EAST SIDE OF CONCRETE GATE FOUNDATION FOR 4900 W. 21ST ST. N., WICHITA, KANSAS.
ELEVATION = 1323.85 (NAVD88, G12A)

STORM WATER DRAIN 426

to serve

Emerald Bay 3rd

CITY OF WICHITA, KANSAS

Gary Janzen, P.E. City Engineer
Project Number 468-85241
O.C.A. NO. 751566

PROJECT LOCATION

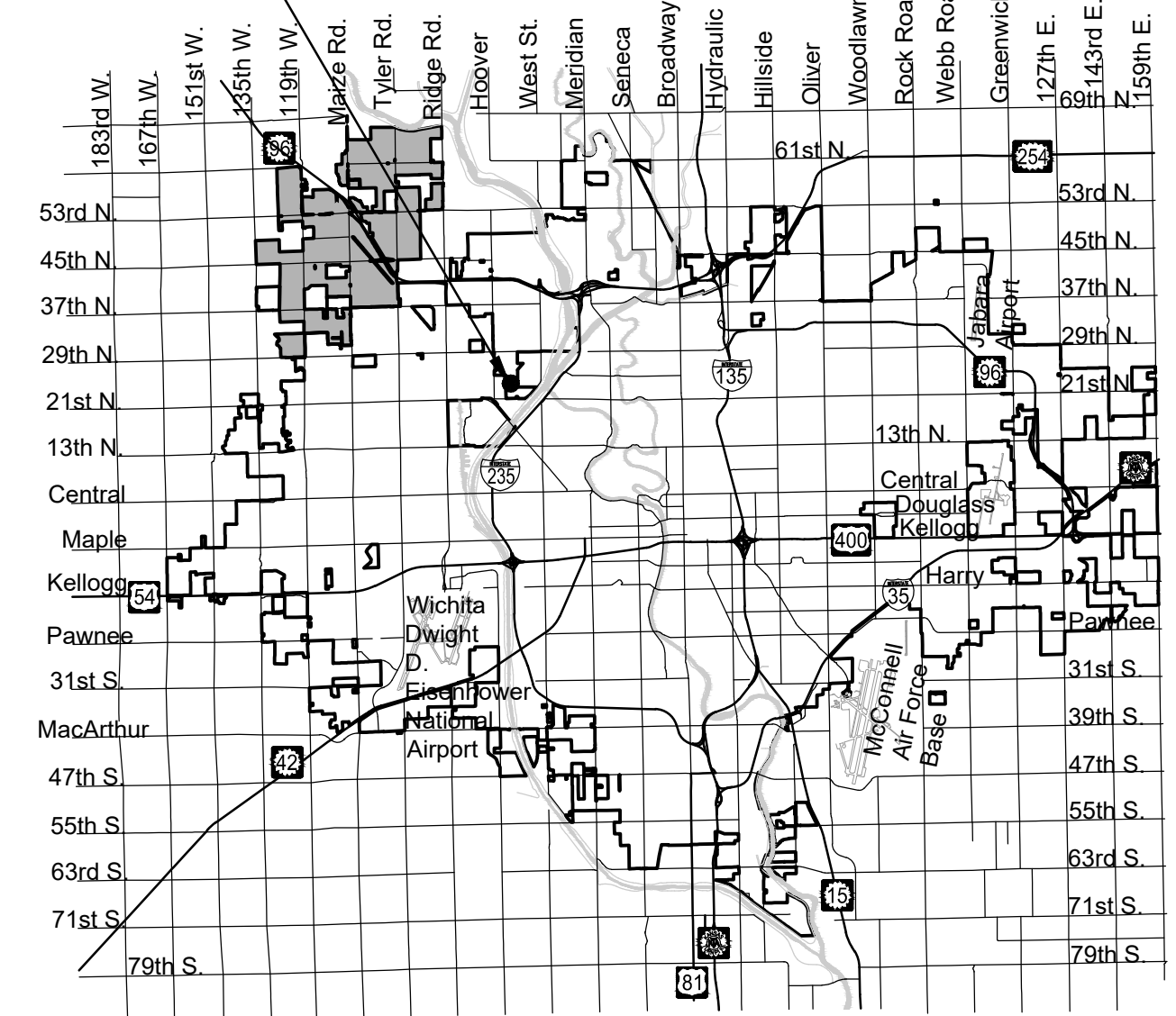

Vicinity Map

Sheet List Table

Sheet	Title
1	SWS Titlesheet
2	Pipeline Coordination-Haul Routes
3	Site Grading Details
4	Site Grading (Channel)
5	SS Removal
6	Site Grading (North)
7	Site Grading (Northwest)
8	Site Grading (South 1 of 4)
9	Site Grading (South 2 of 4)
10	Site Grading (South 3 of 4)
11	Pump Swale
12	SWS Line 1 (1 OF 3)
13	SWS Line 1 (2 OF 3)
14	SWS Line 1 (3 OF 3)
15	SWS Line 2
16	SWS Line 3 (1 OF 2)
17	SWS Line 3 (2 OF 2)
18	SWS Line 4
19	SWS Line 5
20	MH Frame & Cover
21	Type 1A CB Inlet 5-10
22	Reinf Conc SWS MH
23	Pre-Cast SWS MH
24	Snout Detail
25	Backyard Inlet
26	Erosion Control Plan
27	BOC
28	Silt Fc
29	Straw Bale
30	SIP
31	SDP
32	Grading Bubble Map NW & Peninsula Beach
33	Grading Bubble Map NE
34	Grading Bubble Map Channel
35	Grading Bubble Map East & Pump Ramp
36	Grading Bubble Map SE
37	Grading Bubble Map Coordinates (1 of 2)
38	Grading Bubble Map Coordinates (2 of 2)
39	SWS Bubble Map
40	Addition Bubble Map
41	Emerald Bay 3rd Plat-SWS

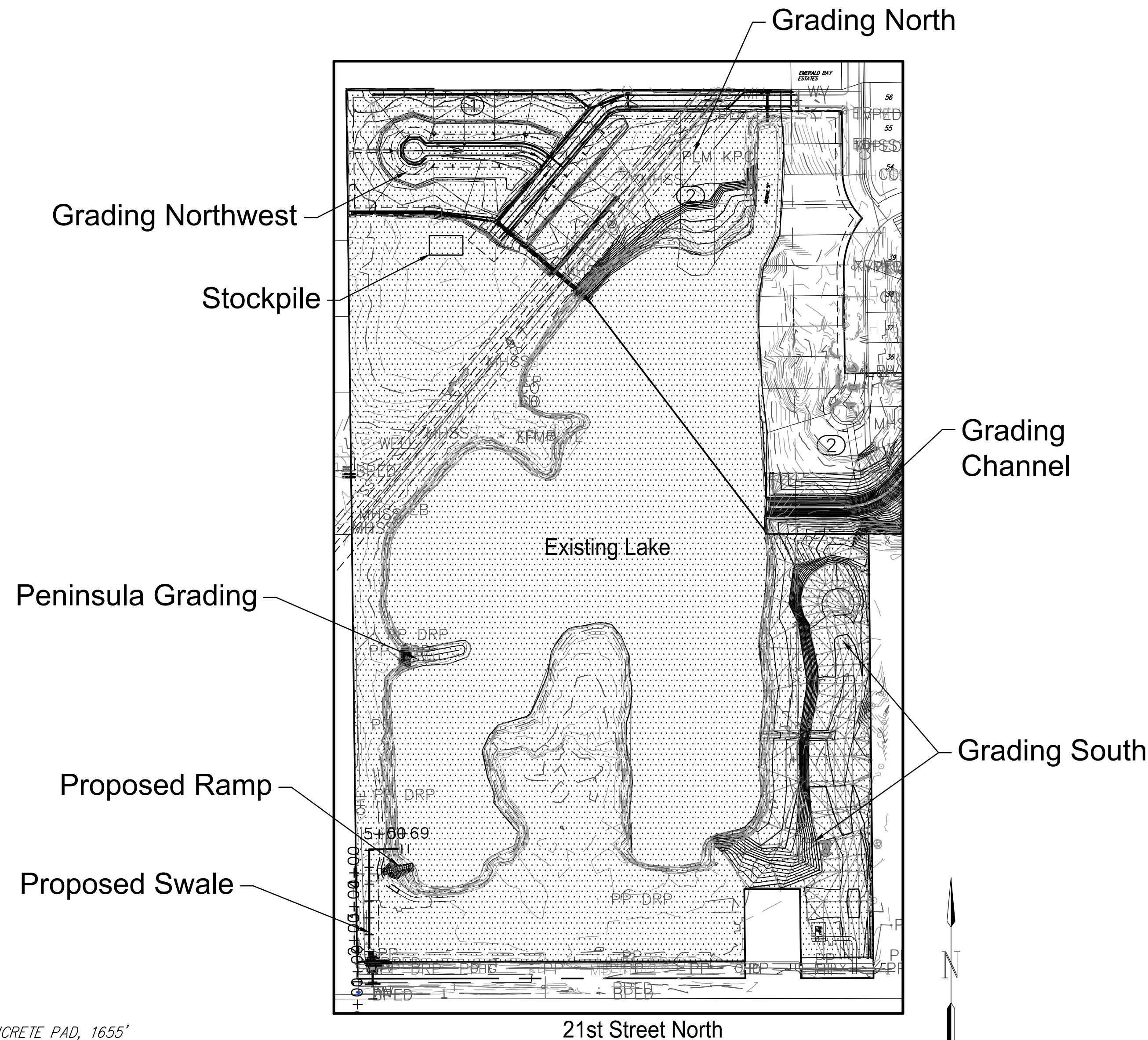

IMPROVEMENT DISTRICT

Earthwork Quantities		
Cut-Cu. Yds.	Fill-Cu. Yds.	Net-Cu. Yds.
89770	56981	32789

NOTES: Contractor to stockpile 600 cu. yds. of excess excavation for the Street Paving Project. See location on Map this sheet.

Any additional excess to be used per note on Sheet No. 6



March 2018

PLANS PREPARED BY



GARVER
924 N. Main Street
Wichita, KS 67203
(316) 264-8008
www.GarverUSA.com