

BENCHMARKS:
 BM #5 - RR Spike in West face of HLP, southeast corner of Hydraulic and 50th St. South. Sta. 97+20.7, 39.8' Rt. Elev. 80.78 (City Datum)

FHWA REGION NO.	STATE	PROJECT NO.	FISCAL YEAR	SHEET NO.	TOTAL SHEETS
7	KANSAS	87 N-0303-01	2003	79	143

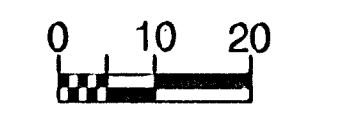

SCALE: 1" = 20'

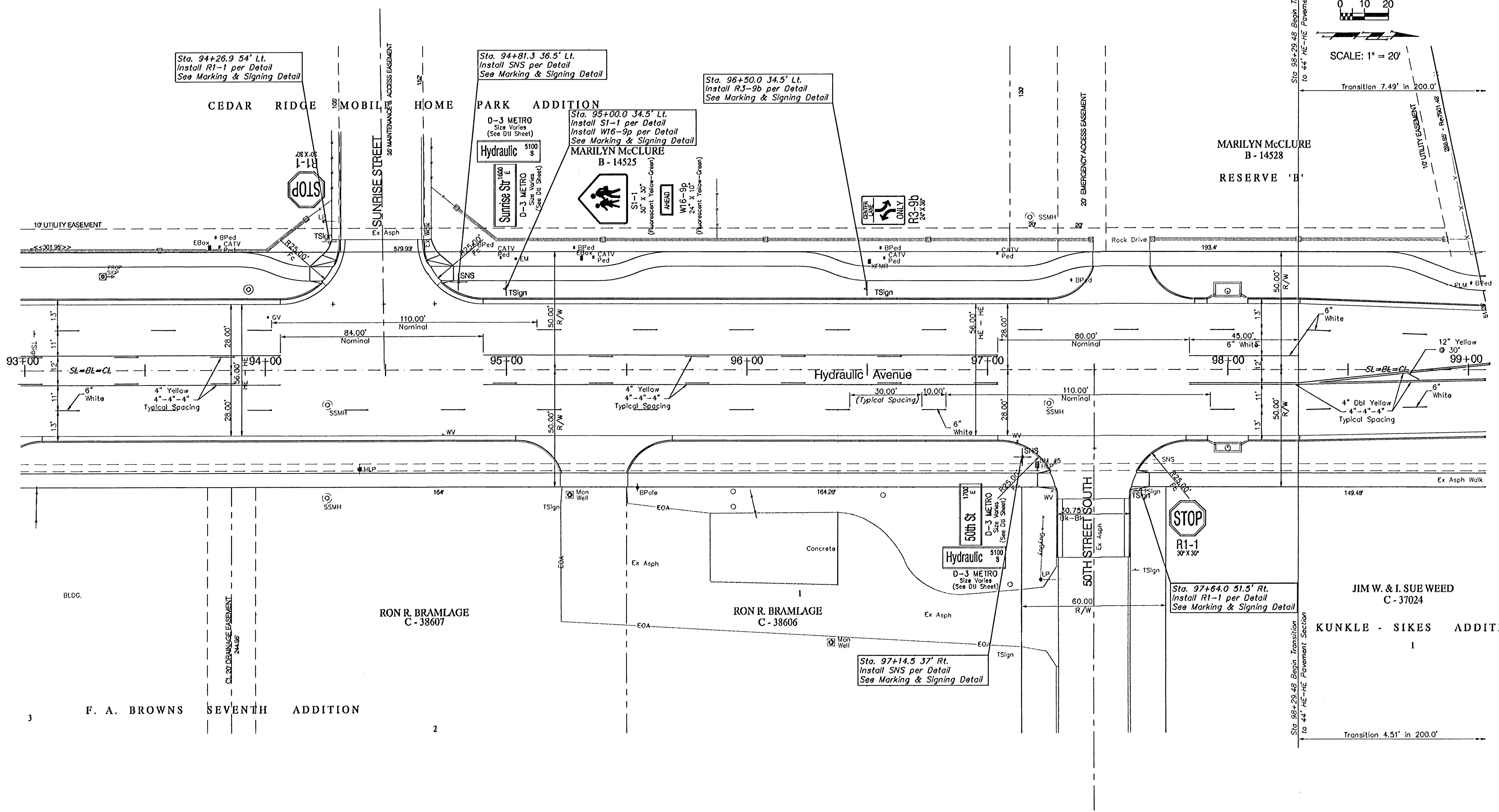

PROJECT NUMBER 472-83902		SHEET NAME Mark09		ENGINEERING DIRECTORY E:\Eng\Hydraulic_ph2\Traffic		CAPITAL IMPROVEMENT PROJECT		BAUGHMAN COMPANY, P.A. ENGINEERING, SURVEYING, & PLANNING 318-282-7271 • 318 ELLIS • WICHITA, KANSAS 67211	SHEET 79 OF 143
DESIGN JFB	DRAWN TCA	APPROVED JFB/KK	DATE March 04	SCALE 1"=20'	BAUGHMAN NO 99-09-E451	PAVEMENT MARKING PLAN HYDRAULIC AVE PAVING - SOUTH OF 57th STREET SOUTH TO 47th STREET SOUTH			