

Contractor shall maintain two way traffic the full length of the project at all times except for localized flagging at individual locations during working hours. SWS crossings must be covered with Temp. Pvmnt. or Plates by the end of each working day. Flagging operations to conform to the latest addition of the MUTCD.

PLANS REGION NO.	STATE	PROJECT NO.	FISCAL YEAR	SHEET NO.	TOTAL SHEETS
7	KANSAS	87 N-0303-01	2003	92	143

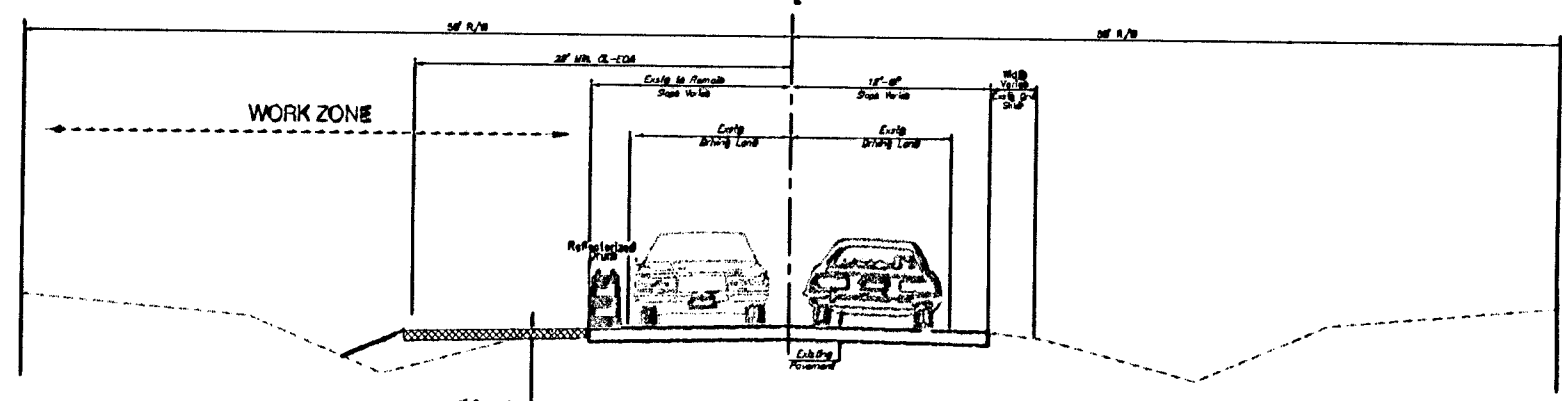

PHASE 1b (Looking South)
Install Temporary Asphalt Pavement - East Side Hydraulic Minnesota Ave to 48th Street
Construct Temp. 6" A.C. Surface

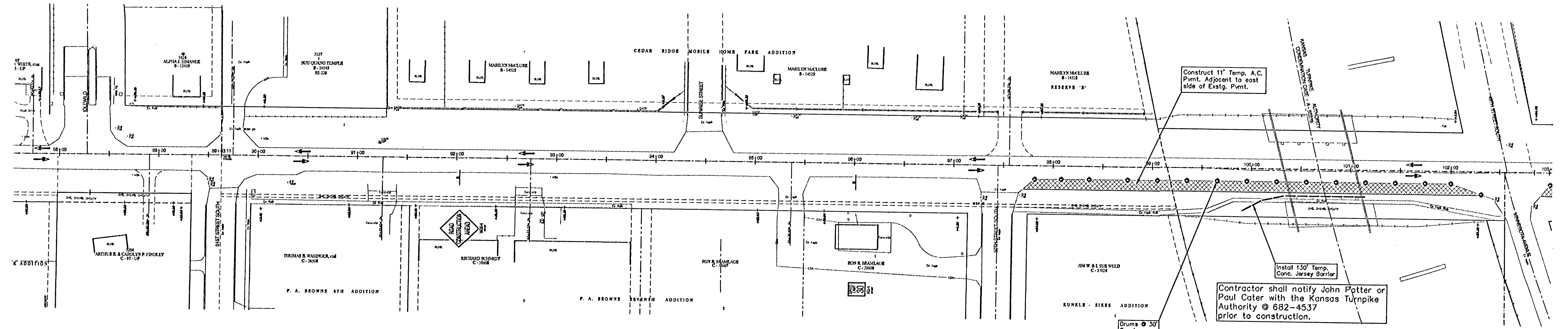
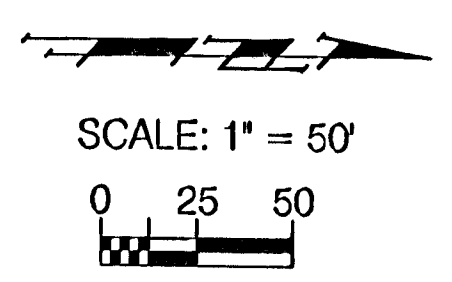
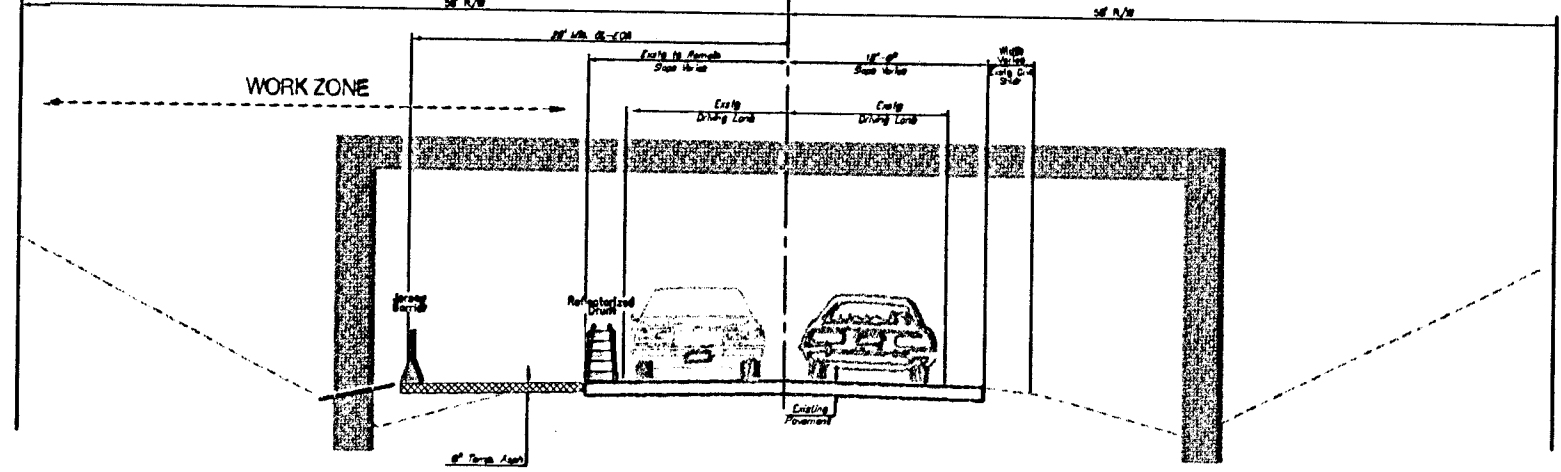

PHASE 1b (Looking South)
Install Temporary Asphalt Pavement - East Side Hydraulic 508 Street to Minnesota Ave (Under KTA Bridge)
Construct Temp. 6" A.C. Surface

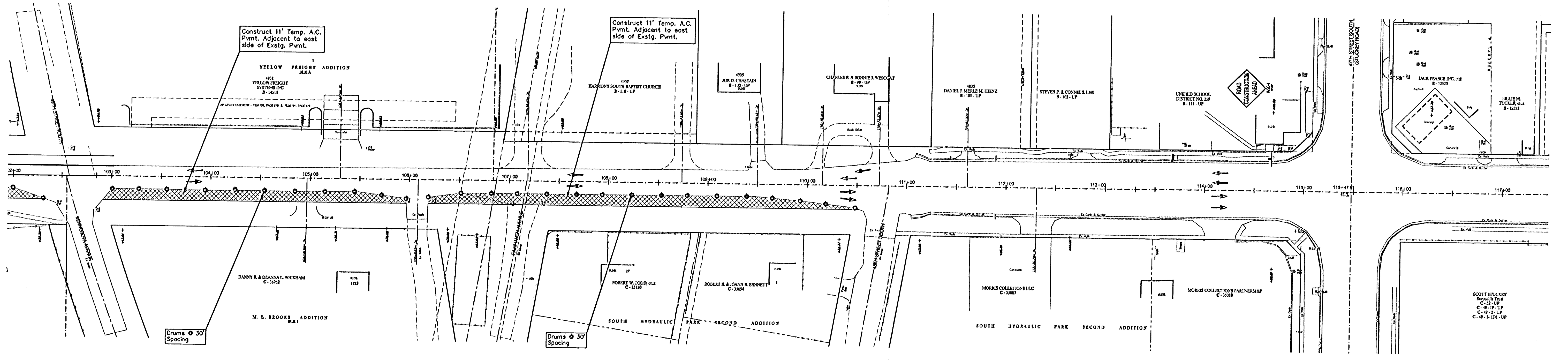

Contractor shall either maintain or temporarily relocate all street name signs within project limits at all times during construction.

Contractor shall maintain access to all businesses and residences during construction.

Contractor shall maintain all drainage ways during construction.

PROJECT NUMBER 472 83902	SHEET NAME Conseq04	ENGINEERING DIRECTORY FAEngHydraulic ph2/Conseq
DESIGN Azire	DRAWN Staff	APPROVED JFB
DATE March 04	SCALE 1" = 50'	BAUGHMAN NO 99-09-E451

STREET & SWS IMPROVEMENTS
Construction Sequencing Plan Phs 1b
HYDRAULIC AVE PAVING - SOUTH OF 57th STREET SOUTH TO 47th STREET SOUTH

BAUGHMAN COMPANY, P.A.
ENGINEERING, SURVEYING, & PLANNING
316-262-7271 • 315 ELLIS • WICHITA, KANSAS 67211