

Contractor shall either maintain or temporarily relocate all street name signs within project limits at all times during construction.

Traffic to be Maintained on Temp. Surface to provide 2-way traffic. Contractor may flag traffic during construction.

PHASE II
 Construct SWS Each side of Hydraulic, Mona Lane to North of 48th Street.
 Construct Temp. Pvmnt. on West side of Exstg. Pvmnt. Mona Lane to 50th Street.
 Construct Roadway - East Side Hydraulic, South of 57th Street to Mona Lane.
 Maintain 2-Way Traffic on Temp. Pvmnt. and West Side Exstg. Pvmnt., South of 57th Street to Mona Lane. Maintain 2-Way Traffic on Temp. Pvmnt. and East Side Exstg. Pvmnt., Mona Lane to 48th Street. Contractor may Flag at individual Locations during working hours.

Contractor shall maintain two way traffic the full length of the project at all times except for localized flagging at individual locations during working hours. SWS crossings must be covered with Temp. Pvmnt. or Plates by the end of each working day. Flagging operations to conform to the latest addition of the MUTCD.

PRVA REGION NO.	STATE	PROJECT NO.	FISCAL YEAR	SHEET NO.	TOTAL SHEETS
7	KANSAS	87N-0303-01	2003	93	143

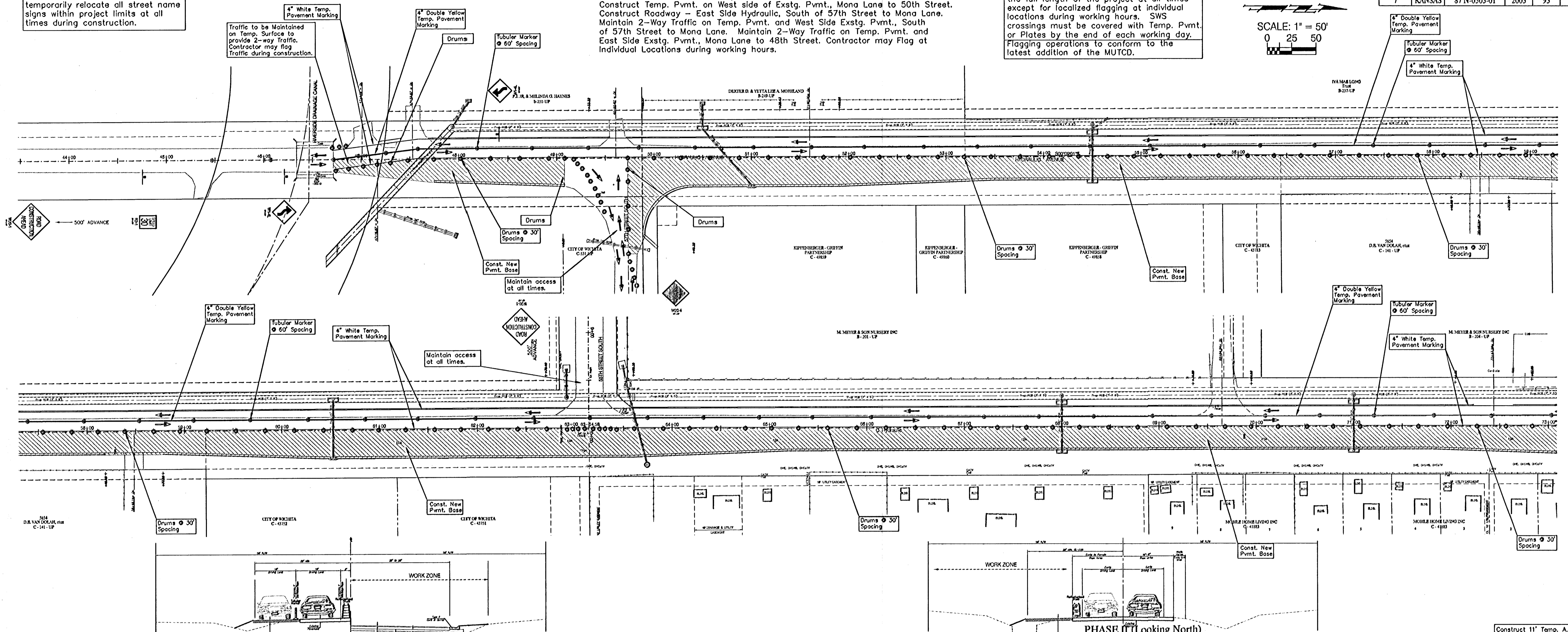
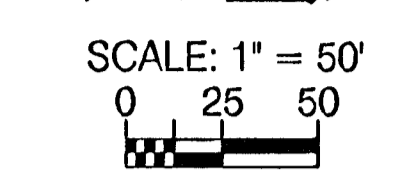

PHASE II (Looking North)
 Construct Roadway - East Side Hydraulic North of 51st Street to Mona Lane

PHASE II (Looking North)
 Install SWS - Each Side Hydraulic Mona Lane to South of 51st Street
 Install Temporary Asphalt Pavement - West Side Hydraulic Mona Lane to South of 51st Street
 Construct Temp. Pvmnt. A.C. Surface

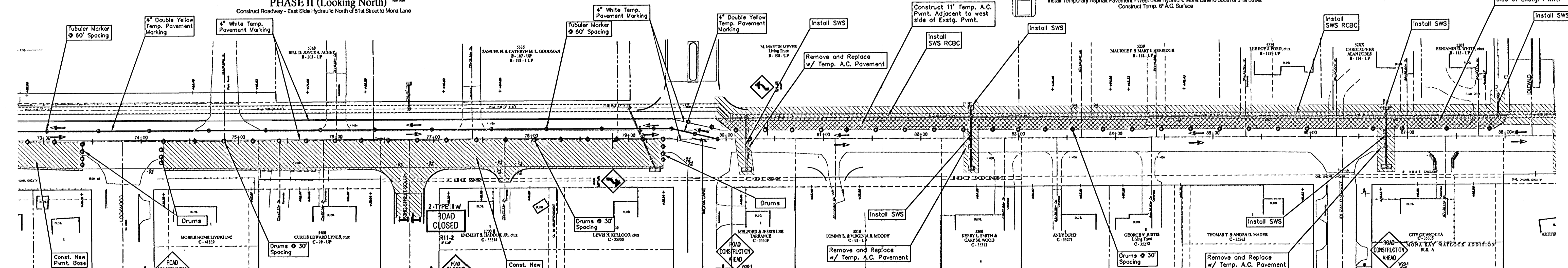

Contractor shall maintain access to all businesses and residences during construction.

Contractor shall maintain all drainage ways during construction.

PROJECT NUMBER 472 83902	SHEET NAME Conseq05	ENGINEERING DIRECTORY FA:Eng/Hydraulic-ph2/Conseq
DESIGN Azire	DRAWN Staff	APPROVED JFB
DATE March 04	SCALE 1"=50'	BAUGHMAN NO 99-09-E451

STREET & SWS IMPROVEMENTS
Construction Sequencing Plan Phs II
 HYDRAULIC AVE PAVING - SOUTH OF 57th STREET SOUTH TO 47th STREET SOUTH

BAUGHMAN COMPANY, P.A.
 ENGINEERING, SURVEYING, & PLANNING
 316-262-7271 • 315 ELLIS • WICHITA, KANSAS 67211

SHEET 93 OF 143